



TOW FRIENDLY FRONT CLIP

OVERVIEW

Sutphen chassis engineering has developed a new front clip that will be wrecker/tow truck friendly beyond the traditional tow eyes. A selectable option for the tow friendly front clip is now selectable. This will replace the standard front bumper clip that is called out in SQS2 as standard. The new tow friendly front clip allows for an accessible lifting point for tow trucks behind the standard tow eye location. The updated front clip is designed to be used with the U-shaped lift hardware to grab from the front (illustrated on next page).

45040100 FRONT BUMPER CLIP - STD

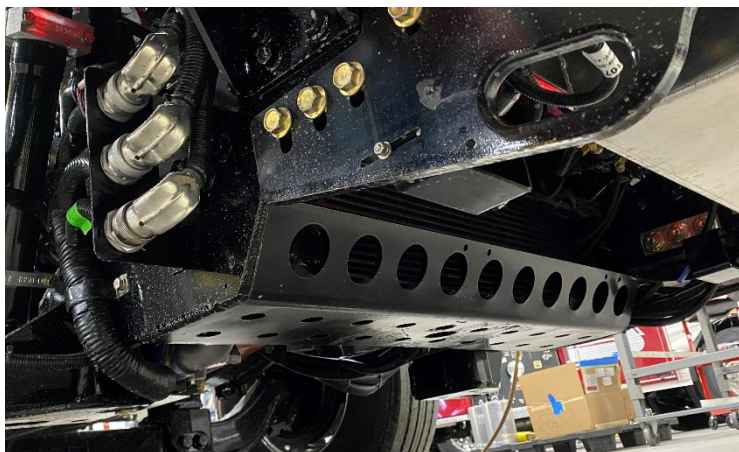

45040110 TOW FRIENDLY FRONT CLIP - IPOS

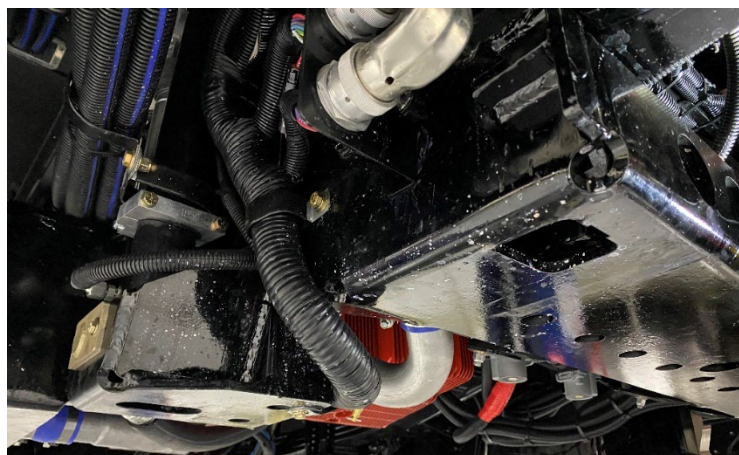



TOW FRIENDLY FRONT CLIP

CONTINUED

Simulated tow hook up without bumper shown.

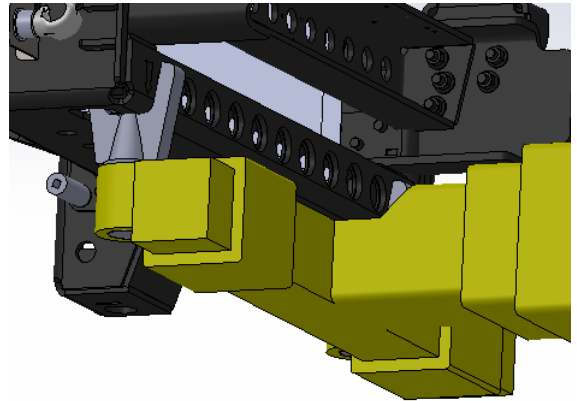
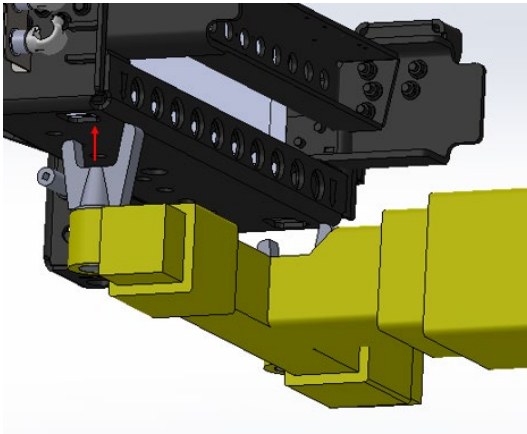

Simulated with a 30" bumper shown.

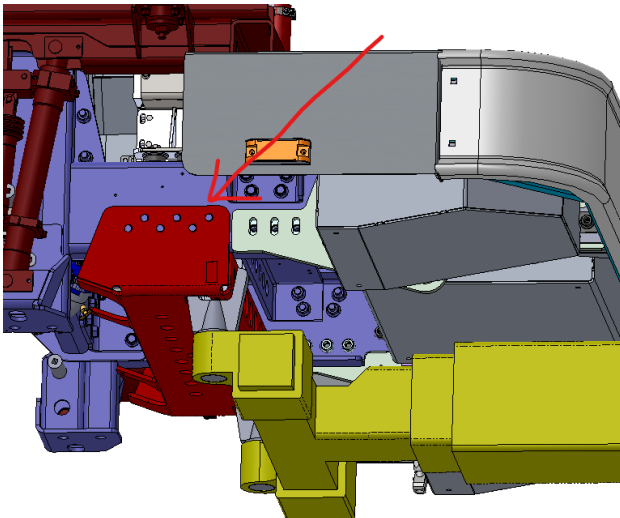

If you have any questions, please contact your STM, Project Manager or Project Engineer.