



SL75, SP70 & SA75 OPERATOR'S STATION DESIGN

The Sales Department would like to inform the dealer network of a design change to the operator's station on the SL75, SP70 and SA75.

Previously, a body compartment door was provided behind the driver side aerial access ladder for accessing the jack release switch and TOFU controls. The operator was required to open this door during normal operations to retract the jacks after aerial setup.

This door has now been replaced with a drop-down access panel. The jack release switch has been moved out onto the switch cluster adjacent to the pump panel for easy access. The new access panel does not need to be opened for normal operations, only for service and for operating the TOFU system and emergency auxiliary motor.

The new control panel will have space for surface mounting a monitor for tip cameras or outrigger spotting cameras when this option is selected.

The panels are easily removed with a Phillips screwdriver for service access to the hydraulic components around the turntable. The access panel will come painted standard. Non-painted brushed S.S. can be selected as an option.

Previous Design



New Design

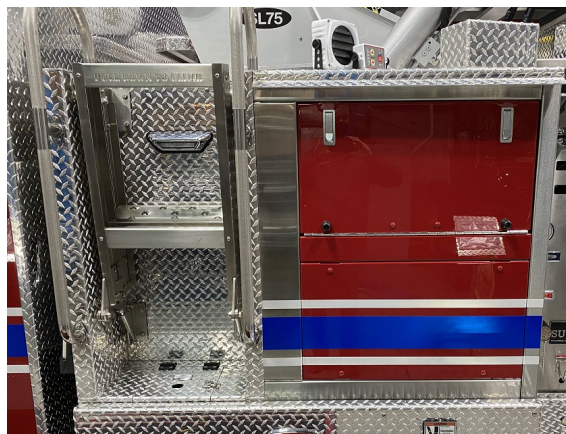

Space under access door available for surface mounting a camera monitor or a radio head.

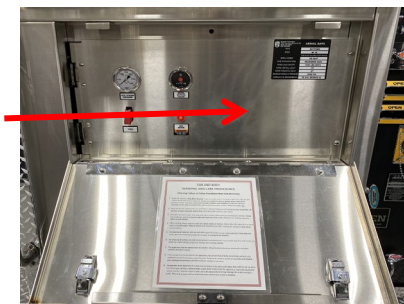

Note: We are adding latches to this panel for quick viewing of the hydraulic components.

Created: 04/06/2021

By: A. Fout

Revised: --



SL75, SP70 & SA75 OPERATOR'S STATION DESIGN

Previous Jack Release
Switch Location



New Jack Release
Switch Location



New Jack Release
Switch Location

