



FRONT BUMPER STORAGE WELL LID STANDARDIZATION

OVERVIEW

In an effort to create better consistency across our different products and facilities, Sutphen will be standardizing the design of the front bumper storage well lids. The Springfield Chassis facility will be designing, fabricating, and installing the lids for all of the facilities (East, Hilliard, Dublin, Springfield, SVI, etc.). The finishing facility will need to handle any notches to accommodate preconnected discharge hoses or other modifications if required.

Please note that this will be a running production change and you will begin to see this new design incorporated into trucks very soon. Below is a summary of the standard design.

Trough With NO Lip:

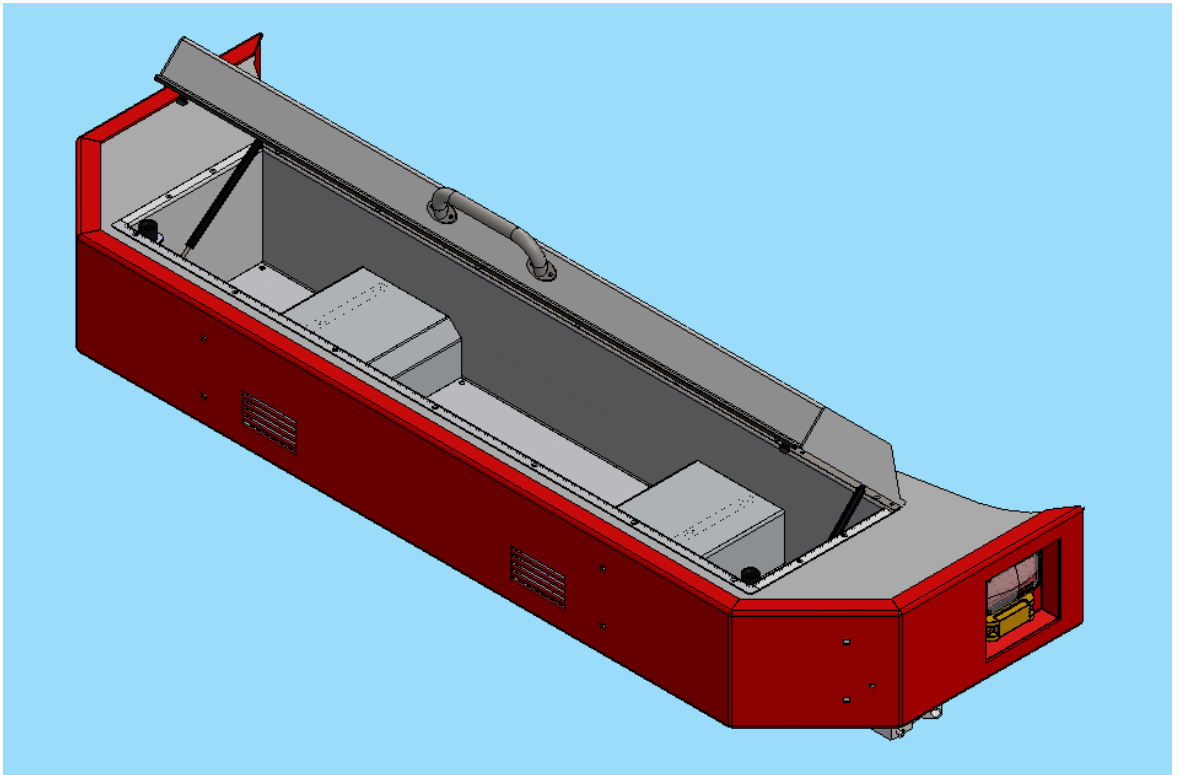



FRONT BUMPER STORAGE WELL LID STANDARDIZATION

Trough With NO Lip:

- Hinge is closed out on side by extending side flange back to rear hinge mounting surface.
- Hinge mounting flange is offset the thickness of the hinge when closed to allow for uniform seating of trough lid across top of trough (making trough more “weather proof”).
- Hinge will be a 2.00” open width, .060” thick, 0.188” diameter pin, 5/8” knuckle continuous 304 stainless steel hinge.

- Horizontal flange on front edge of lid

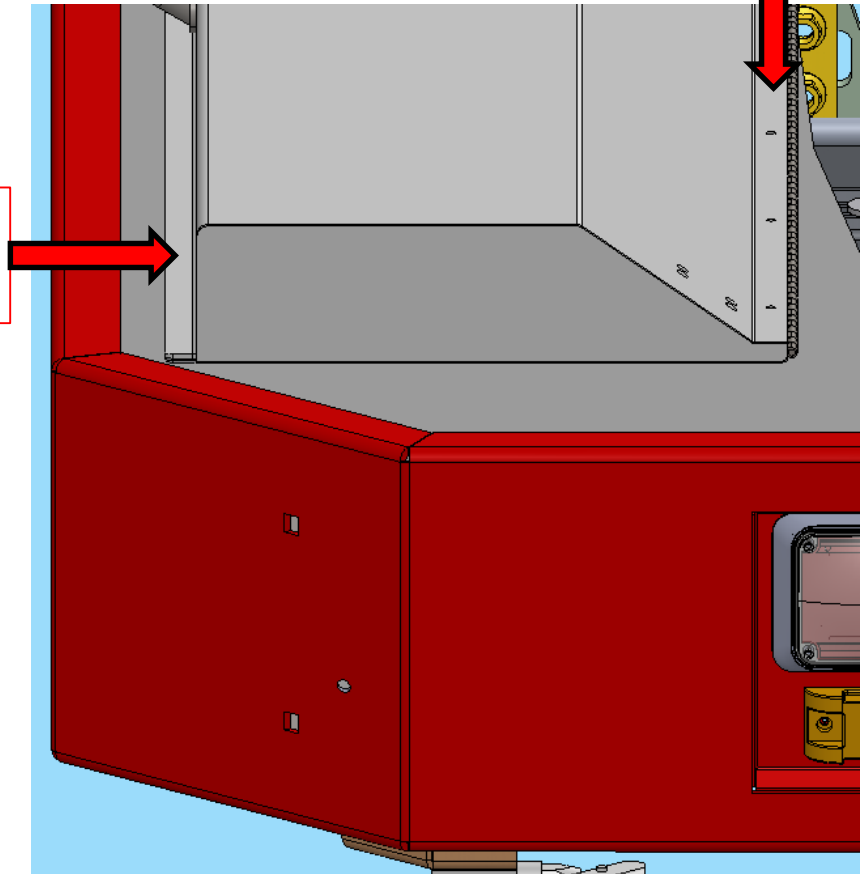



FRONT BUMPER STORAGE WELL LID STANDARDIZATION

Trough With NO Lip:

- EPDM Rubber Bulb Seal (TL X135-BT)

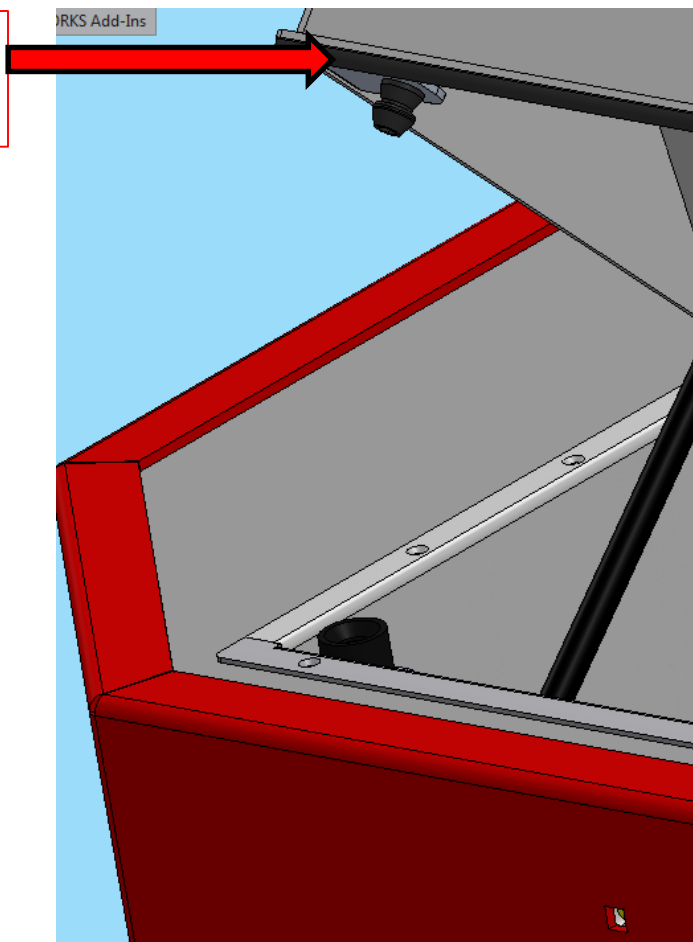



FRONT BUMPER STORAGE WELL LID STANDARDIZATION

Trough With 1" Lip:

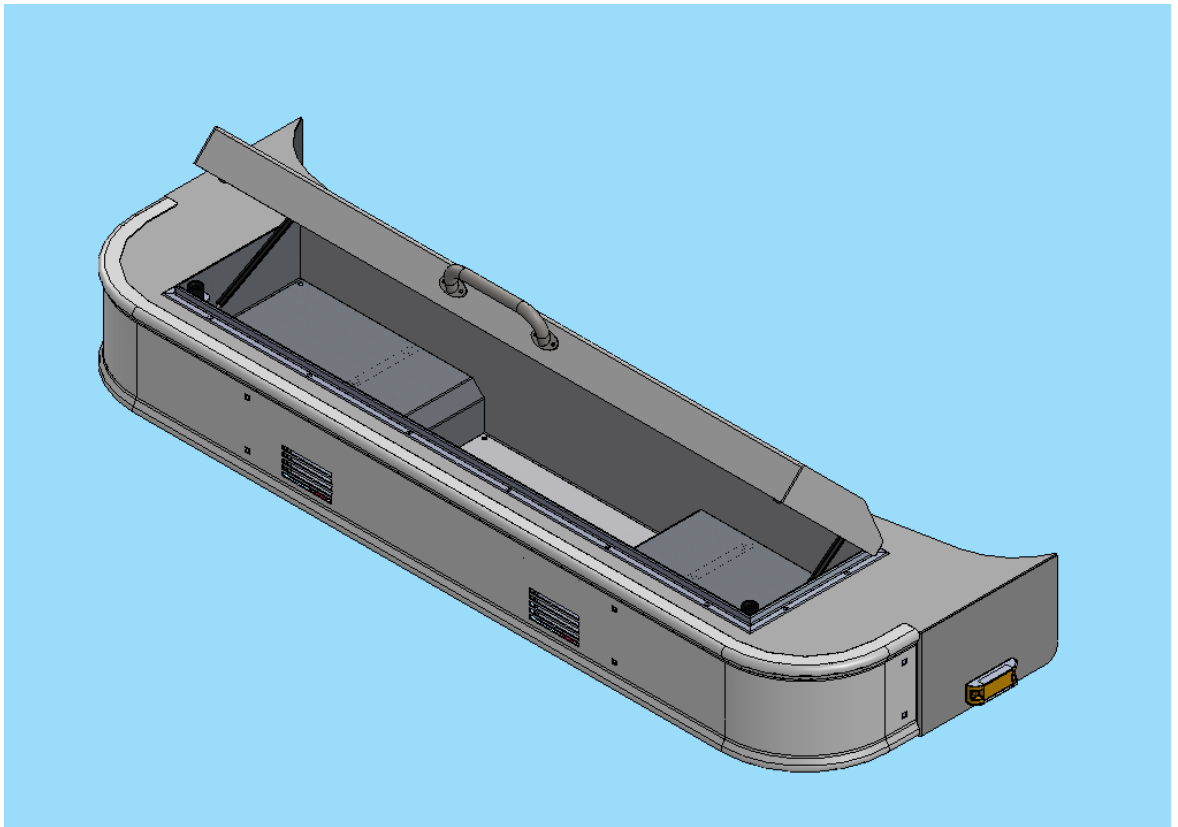



FRONT BUMPER STORAGE WELL LID STANDARDIZATION

Trough With 1" Lip:

- Edge molding on front and side edges of lid where lid meets flange of trough

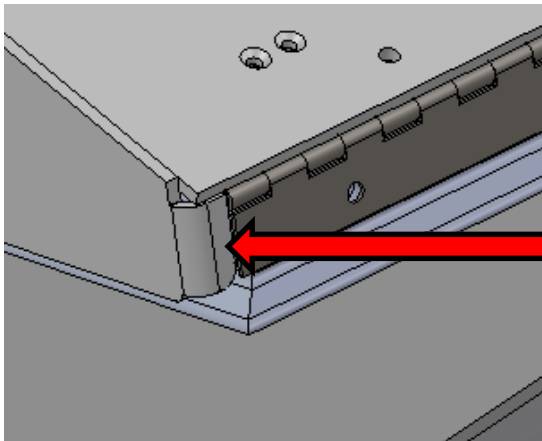
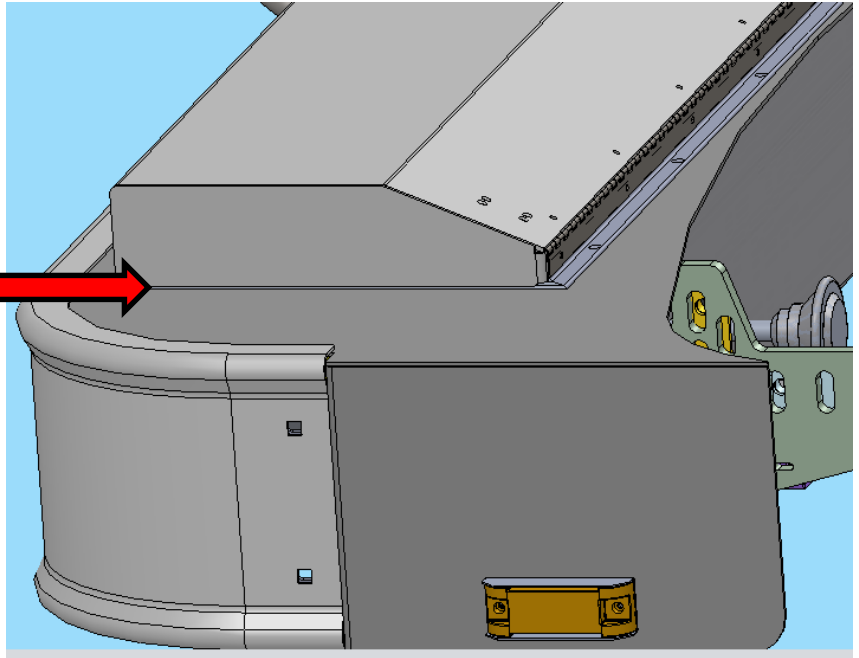

- Hinge is mounted to the 1" lip of the trough and closed out on each side by extending side flange of the lid back with a bend to close the gap (making trough more "weather proof").
- Hinge will be a 2.00" open width, .060" thick, 0.188" diameter pin, 5/8" knuckle continuous 304 stainless steel hinge.



FRONT BUMPER STORAGE WELL LID STANDARDIZATION

Stainless Steel Handle (All Lids):

- Stainless Steel Angled (upward) Grab Handle (V-6690-BS-K) mounted on front face of lid (for all lid designs unless otherwise specified/requested)

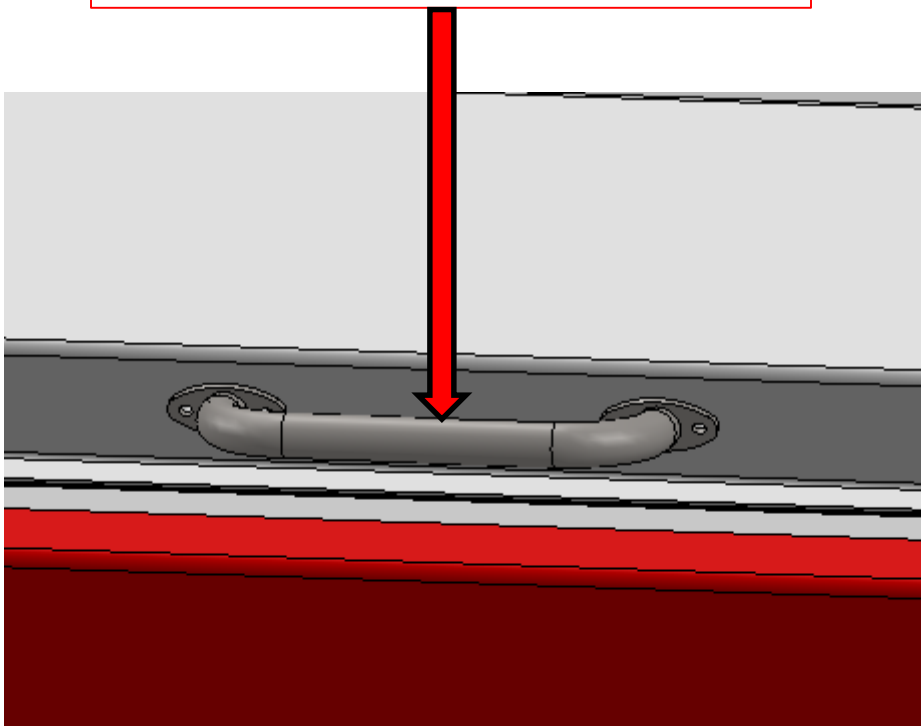



FRONT BUMPER STORAGE WELL LID STANDARDIZATION

Latching Mechanism Options:

- EMC 1-666 Black Rubber Door Holder

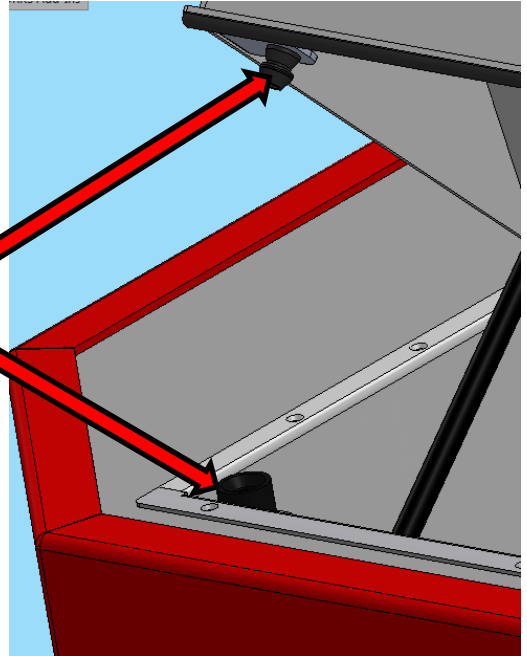

- Stainless Steel Butterfly Latches (Austin Hardware #K5 2857-52 SS)



- Rubber "T" Style Hold Downs (Southco #32-10-086-20 or Byers Products #WJ195)

NOTE: Please clearly note in the Configurator which latching mechanism is desired. We will be creating lid latching mechanism options in a future Configurator update to ensure we have accurate specifications and to ensure we install what is desired by the customer.