



Sutphen Corporation

SP70 SHORT JACK OPERATION

AERIAL LADDER SET-UP – STANDARD

1. Locate stabilizer controls on the driver's side hydraulic compartment adjacent to pump panel
2. The buttons in the shaded green area are for traditional "One-Button Setup". (Figure 1)
3. Press and hold the "ALL JACKS OUT/DOWN" button until stabilizers are fully extended and release the button.
4. Confirm aluminum ground pads are placed below stabilizer feet before proceeding.
5. Press the "ALL JACKS OUT/DOWN" button again until the stabilizers lower, jack locks engage, and the jacks-in-motion alarm stops.



Figure 1

⚠ WARNING Never operate the ladder without first deploying the stabilizer jacks with proper ground pads beneath them.

6. Confirm the jack locks are fully engaged before proceeding with aerial operations. (Figure 2)



Figure 2

AERIAL LADDER SET-UP – SHORT JACK

NOTICE One of the two stabilizers must be fully extended to allow aerial rotation in short jack mode. If both stabilizers are short jacked, rotation of the aerial will be locked out.

NOTICE The short-jacked stabilizer must be extended at least 6 inches from the stowed position. This allows the jack lock to fully engage when the stabilizer is lowered.

NOTICE In the short jack configuration, the ladder can only rotate to the side with the fully extended stabilizer. The screen in the hydraulic compartment will display the allowable ladder positioning.

1. Locate stabilizer controls on the driver's side hydraulic compartment adjacent to pump panel.
2. Use the buttons in the gray shaded area for short jack operation. (Figure 3)
3. Press and hold the "OUT" button until the stabilizer is fully extended.
4. Press and hold the "LOWER" button on the same stabilizer until the stabilizer stops moving.
5. Extend the opposite stabilizer at least 6 inches before lowering.
6. Press and hold the "LOWER" button until the stabilizer stops moving and the jacks-in-motion alarm stops.
7. Confirm the truck is setup properly and the truck level inclinometer is in the green.
8. Press the "Short JK" button on the screen in the hydraulic compartment to engage the jack locks. The "Short JK" button will turn Yellow once the jack locks are engaged. (Figure 4)

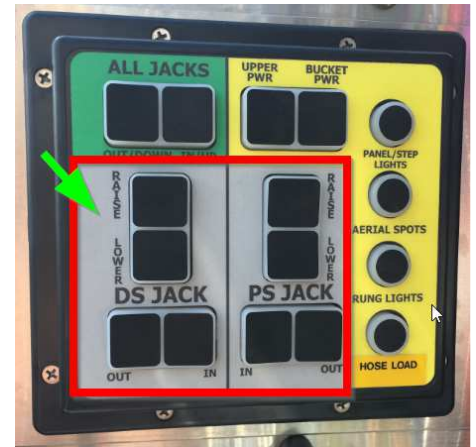

Figure 3

⚠ WARNING Stabilizers shall not be extended once they contact the ground pad.

⚠ WARNING The jack locks MUST be manually activated when setting up in short jack mode. Aerial power will not engage until the "Short JK" button is pressed, and jack locks engaged.

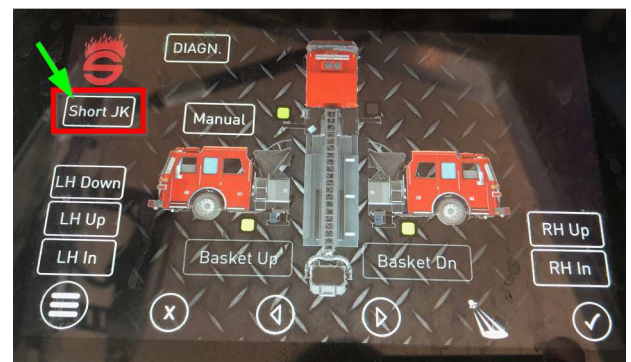

Figure 4

9. Confirm the jack locks are fully engaged before proceeding with aerial operations. (Figure 2)

RETRACT THE STABILIZERS – STANDARD

1. Once the aerial has been properly retracted and stowed, release the jack locks by pressing and holding the the manual “JACK RELEASE” switch for 2 seconds. (Figure 5)
2. Retract the stabilizers by pressing and holding the “ALL JACKS IN/UP” button in the shaded green area. (Figure 2)
3. Continue to hold the retract button until the jacks-in-motion alarm stops.



Figure 5

RETRACT THE STABILIZERS – SHORT JACK

1. Once the aerial has been properly retracted and stowed, press the yellow “Short JK” button to release the jack locks. (Figure 6)
2. Retract the stabilizers using the individual controls in the gray shaded area. (Figure 3)
3. Continue to hold the retract button until the jacks-in-motion alarm stops.



Figure 6

NOTICE

The stabilizers may retract at different speeds.

HOSE LOAD OPERATION

The hydraulic system comes with a hose loading feature which allows the aerial to be raised without deploying the stabilizers.

1. Confirm engine is running, aerial PTO is on, and the outriggers are stowed.
2. Press and release the “HOSE LOAD” button on the bottom right corner of the control pad. (Figure 7) Once released, the aerial will automatically raise to 7 degrees.

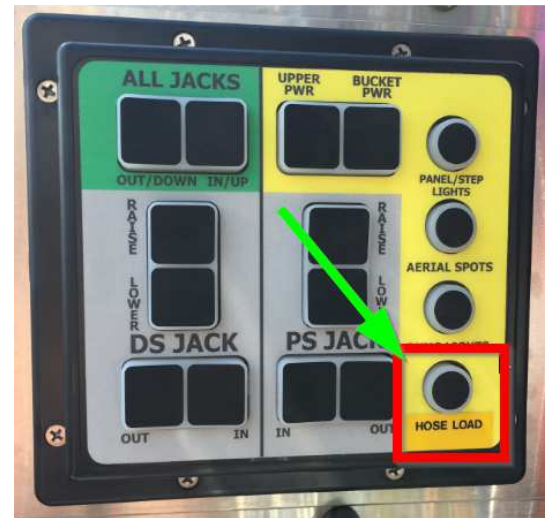

Figure 7

⚠ CAUTION Always check for obstructions above the aerial before performing this operation.

3. To return the aerial to the bed, press and release the “HOSE LOAD” button. The aerial will automatically bed itself.

⚠ CAUTION Always check for obstructions below the aerial before performing this operation.

ELECTRIC BUCKET LEVELING

DISABLE BUCKET LEVELING

Pressing the E-Stop button on the platform controls will disable the leveling system. It will continue to be disabled until the E-Stop is disengaged. (Figure 8)



Figure 8

MANUAL BUCKET LEVELING

The electric leveling cylinders can be manually leveled if needed.

1. Press the E-Stop Button.
2. Press and hold F2 on the button display. (Figure 9)
3. Use the up and down arrow buttons to adjust the level of the bucket.
4. Release F2 to resume normal operations.

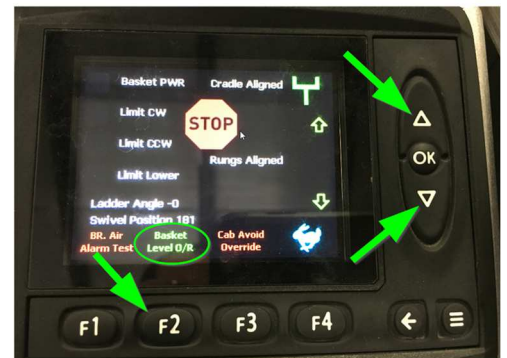
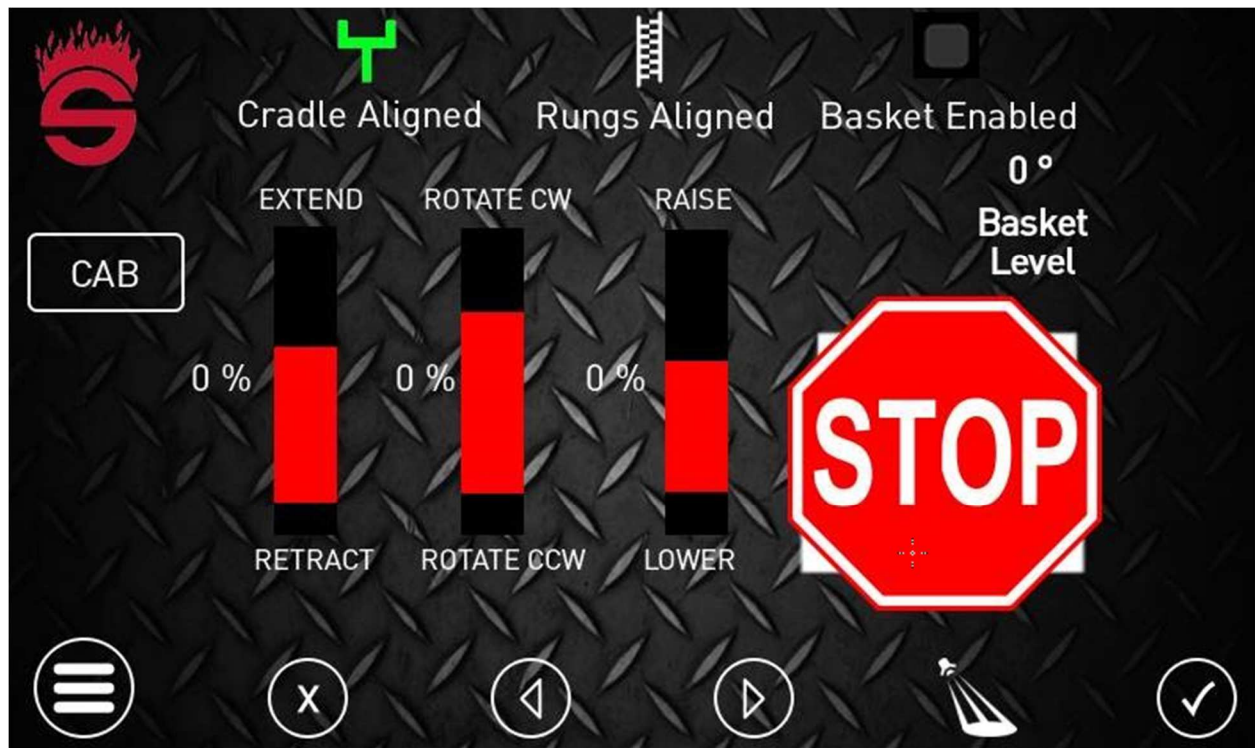

Figure 9

DISPLAY SCREENS

AERIAL MODE



STABILIZER OPERATION



AERIAL POSITION

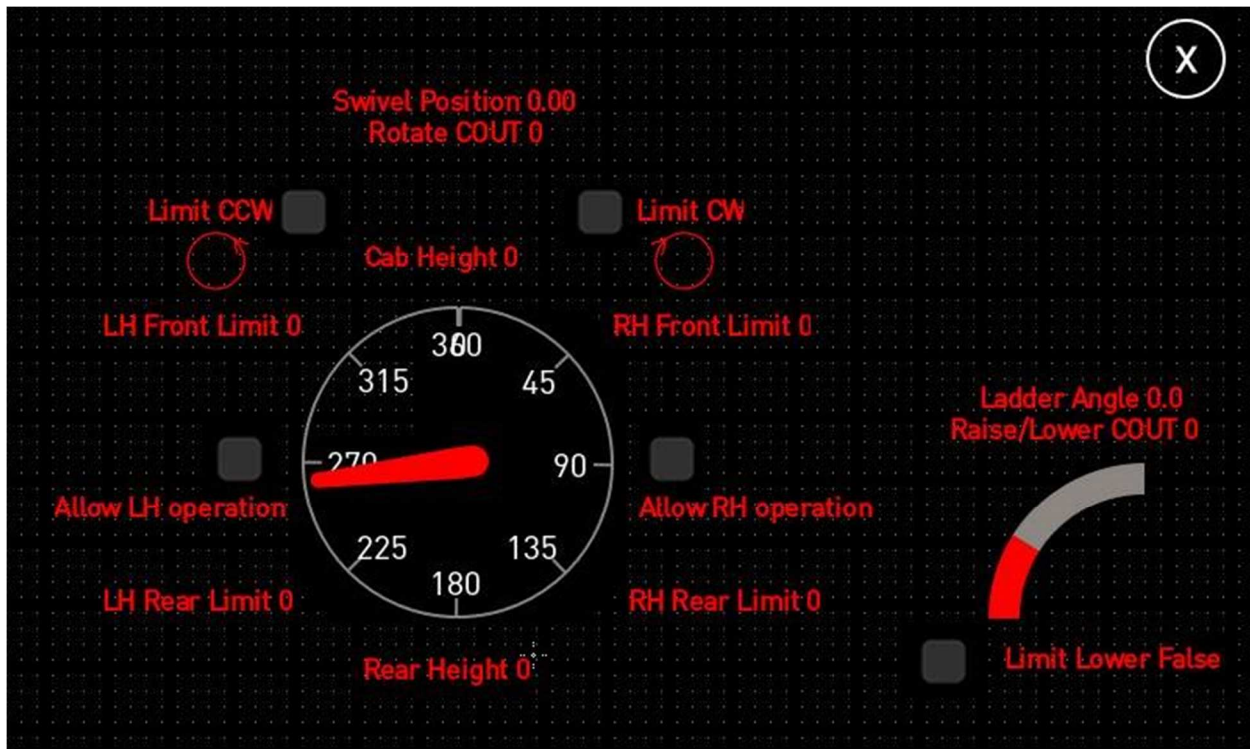

POWER DISTRIBUTION DIAGNOSTICS

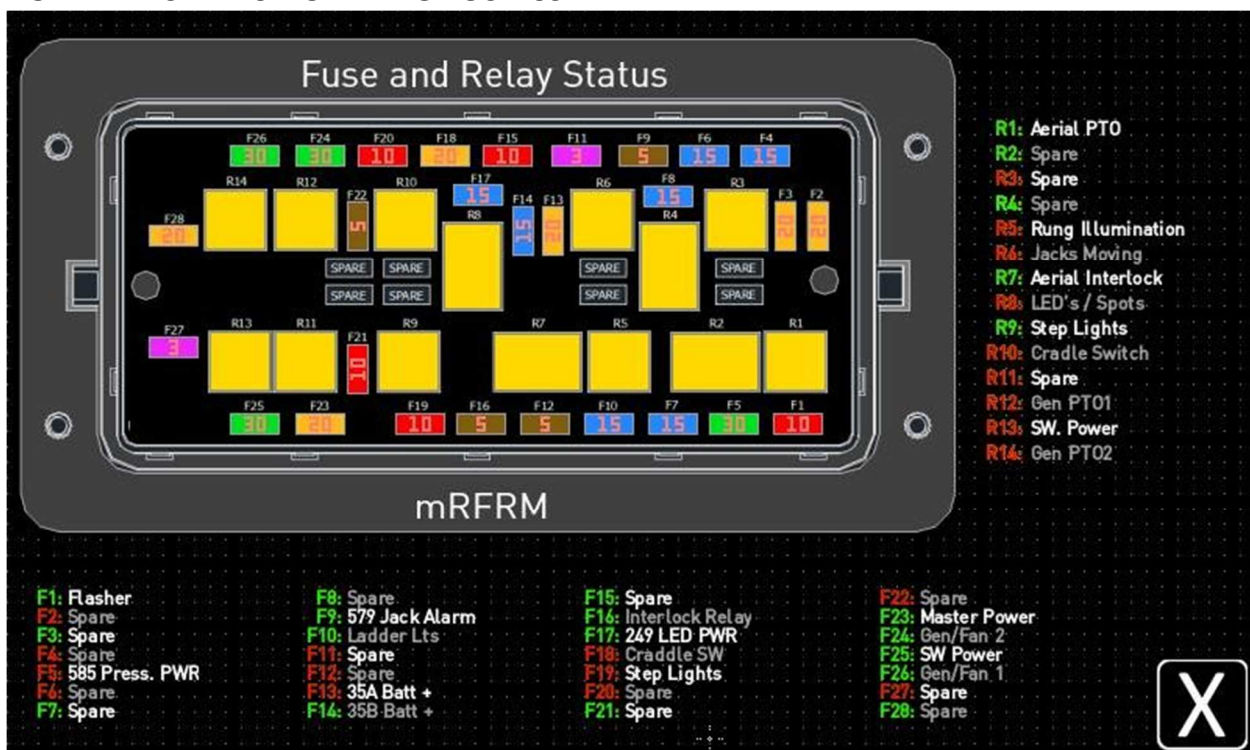

PLATFORM CONTROL DISPLAY

