

# STERLING

## BUSINESS & TECHNOLOGY PARK



**We are very pleased to announce that Sutphen East Corp. is in process of re-locating to the Sterling Business Park in Wayne County PA.**



Sterling Business & Technology  
Park is located near Hamlin, PA,  
at Exit 17 on I-84.





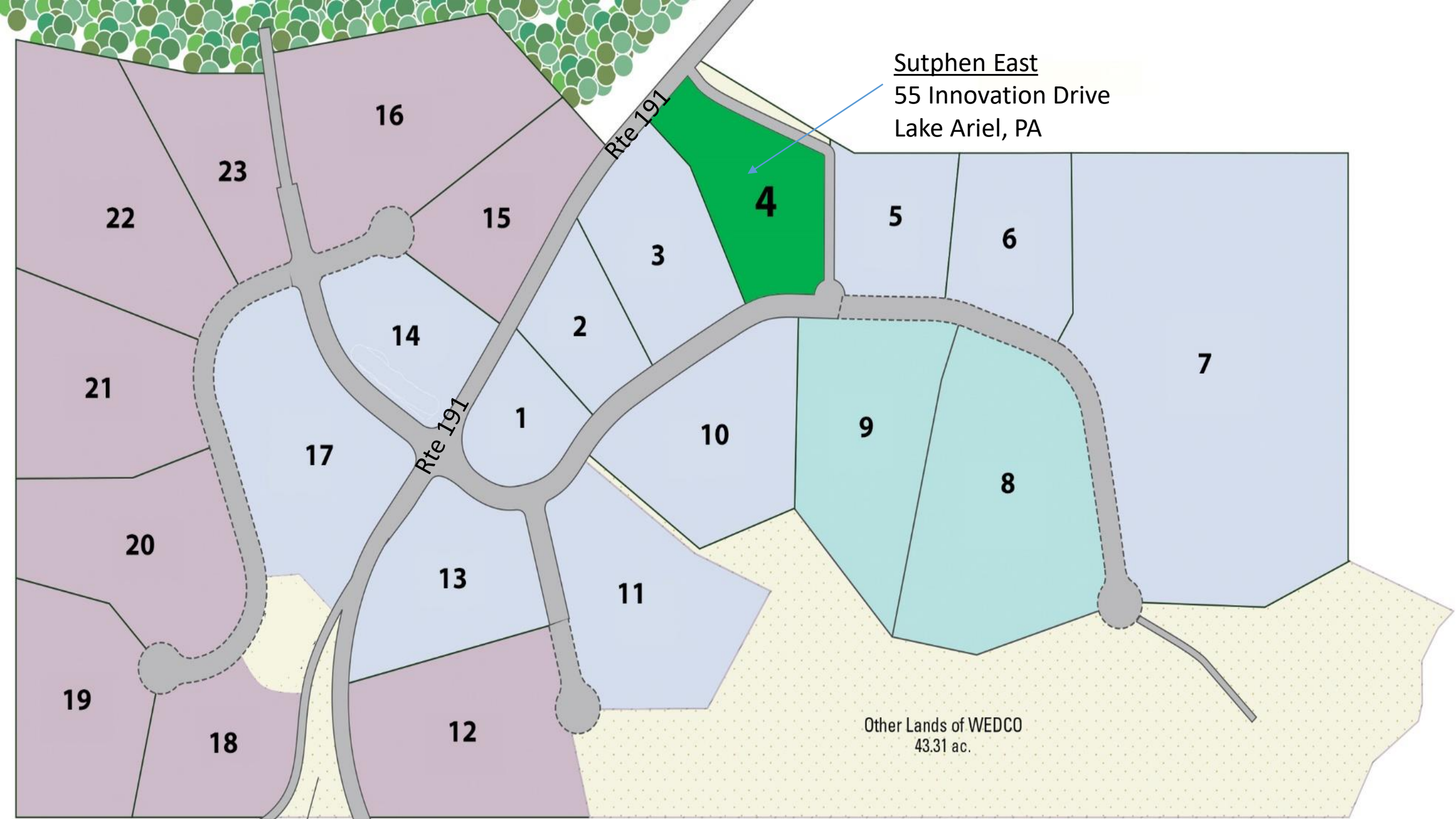

Sutphen East  
55 Innovation Drive  
Lake Ariel, PA

4

Rte 191

Rte 191

Other Lands of WEDCO  
43.31 ac.

16

15

14

13

12

23

22

21

20

19

18

17

1

2

3

10

11

5

6

7

9

8

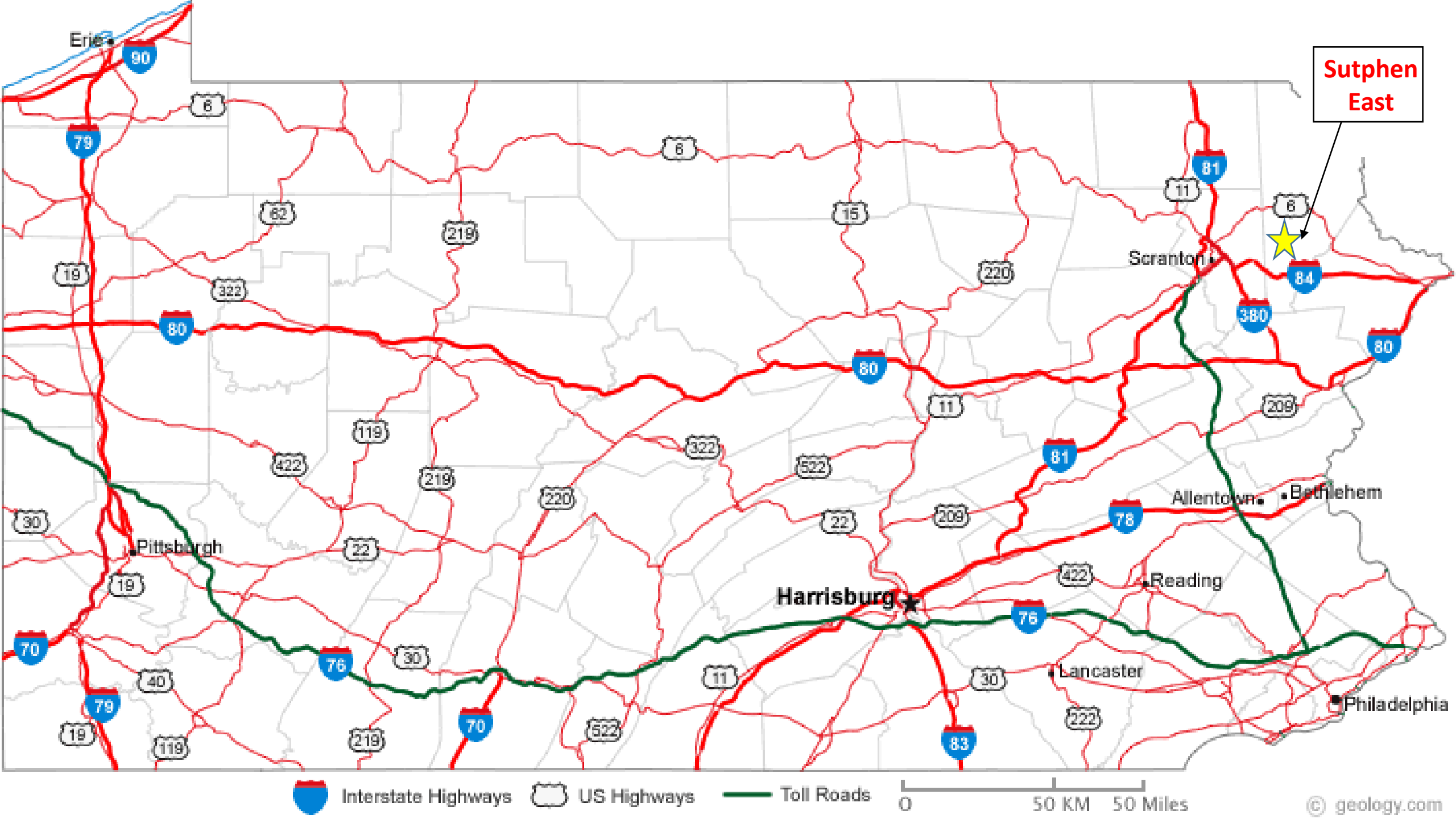

Sutphen  
East



- 25,000 SF Clear Span Building
- 19 ft at Sidewalls
- 100' x 250' - 25' Bay Spacing
- 6.7 Acre Lot





































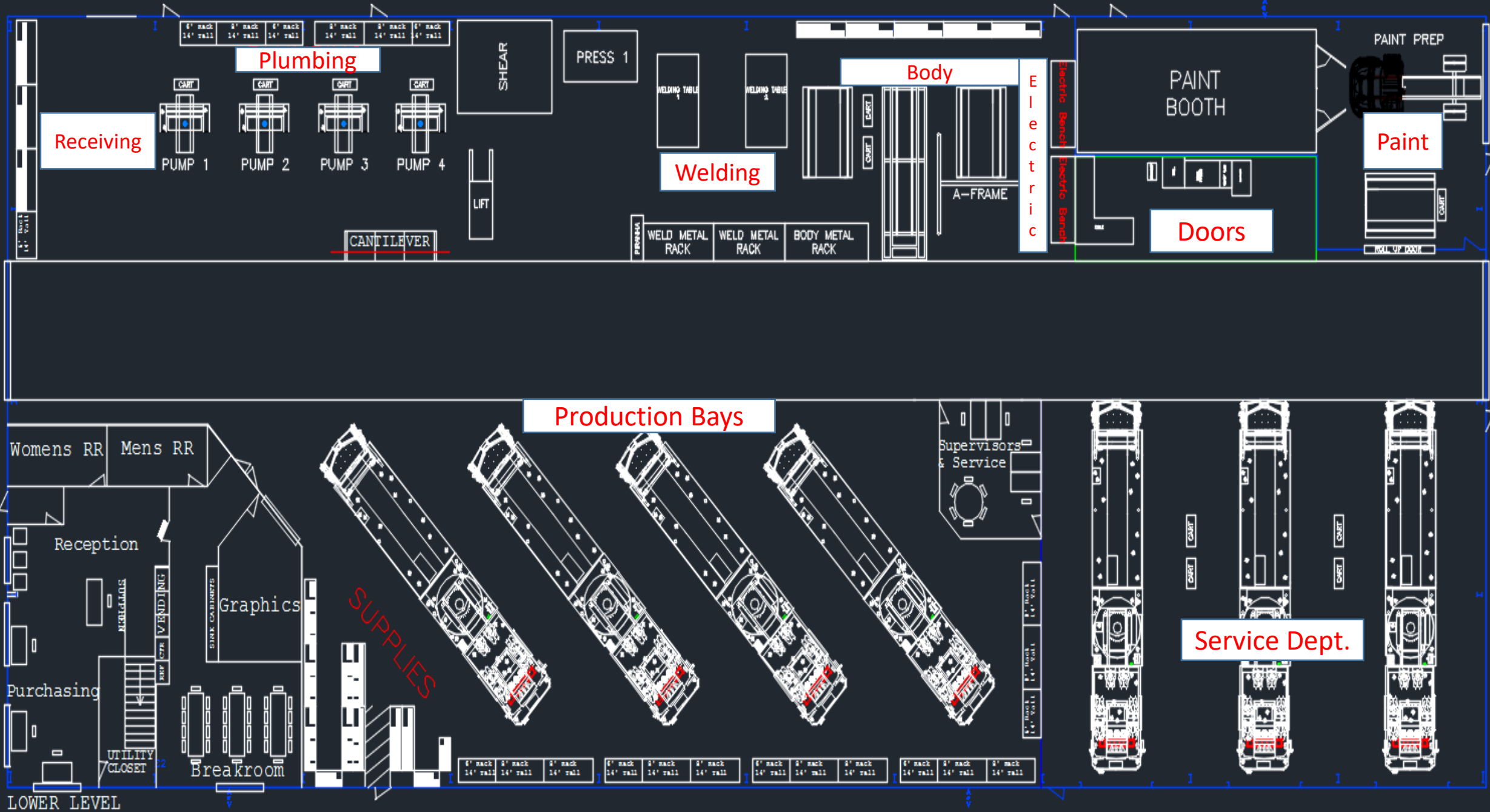

LOWER LEVEL



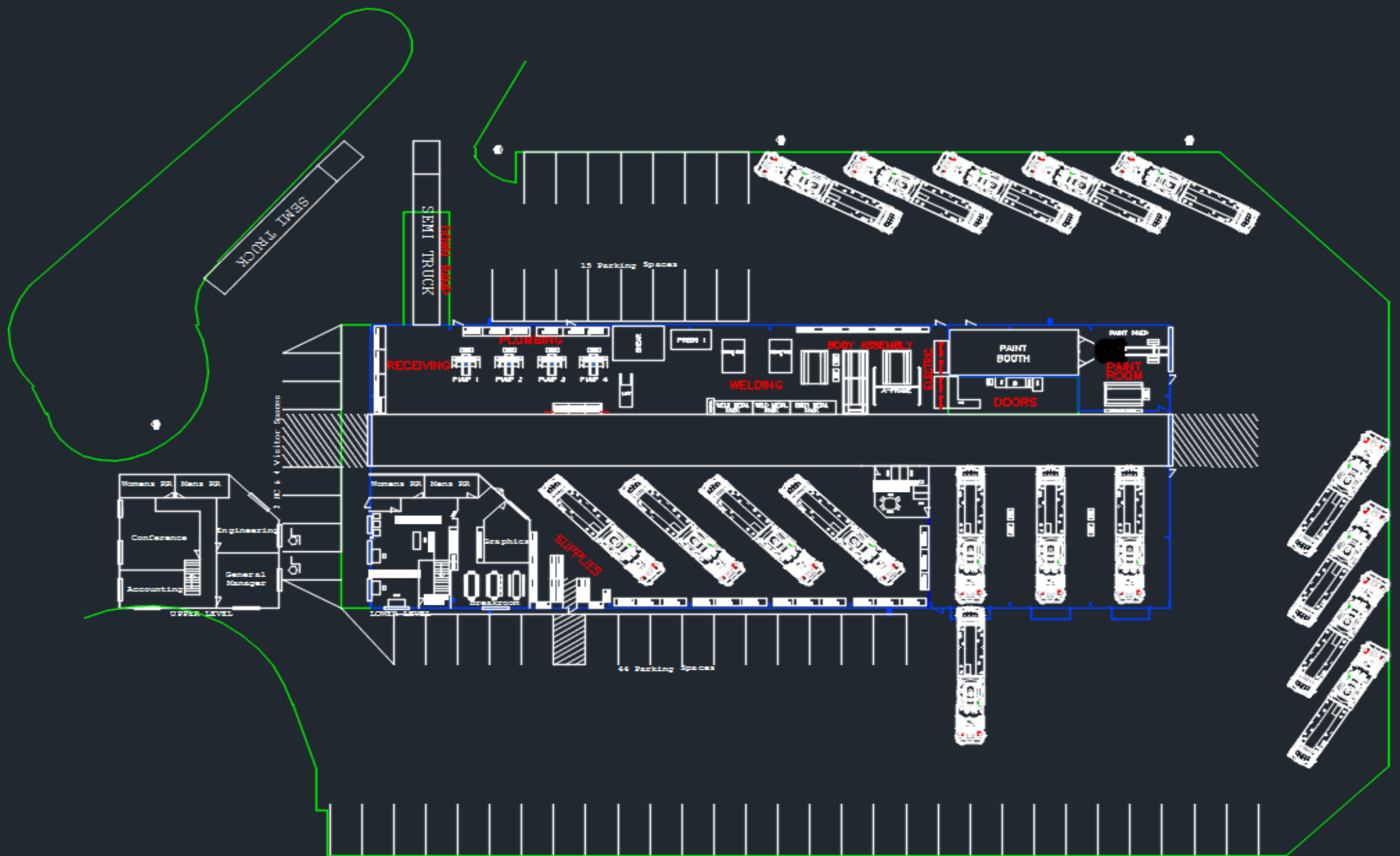



## **Within Minutes!!**

Exxon Station with Diesel at Exit 17

Twin Rocks Diner Truck Stop at Exit 17

Comfort Inn at Exit 17

MacDonald's – 5 minutes

Kentucky Fried Chicken – 5 minutes

Taco Bell – 5 minutes

Dunkin Donuts – 5 minutes

Wine and Spirit Shoppe – 5 minutes

Grocery Stores – 5 minutes

CVS & Rite Aid – 5 minutes

Medical Facilities – 5 minutes

Lake Ariel – 5 minutes

The French Manor Spa, Inn and Restaurant – 15 minutes

Lake Wallenpaupack – 20 minutes

Backdraft restaurant – 20 minutes

Cove Haven Resort – 20 minutes

Shopping Malls, Scranton – 20 minutes

Woodloch Lodge – A top ten international Spa and Hotel – 30 minutes

Woodloch Pines – Top all inclusive family resort – 30 minutes

Woodloch Springs – High end rental properties and Golf Course – 30 minutes

Lackawaxen & Delaware Rivers, Kayaking, Fishing, Rafting – 30 minutes

AAA Yankees Baseball, Scranton/Wilkes-Barre Penguins Hockey

I-84 is 2 minutes from the facility

Scranton PA- 20 minutes











# Lake Wallenpaupack





# AREA GOLF !!

Area Courses:

- Mount Cobb (Scranton Golf Course)
- Red Maples Golf Club
- Honesdale Golf Club
- Cricket Hill Golf Club
- Paupack Hills Golf and Country Club











**MONTAGE MOUNTAIN**

EASIEST TERRAIN	[Icon]
INTERMEDIATE	[Icon]
DIFFICULT TERRAIN	[Icon]
EXPERT TERRAIN	[Icon]
TERRAIN PARK	[Icon]
SKI PATROL	[Icon]
NASTAR	[Icon]
GUEST SERVICES	[Icon]
SNOWTUBING PARK	[Icon]
MAINLINE	[Icon]
HIGHBALL	[Icon]
EASY STREET	[Icon]
LIMITED	[Icon]
RUNAROUND	[Icon]
LEARNING AREA	[Icon]
UPPER FAST TRACK	[Icon]
UPPER RUNAWAY	[Icon]
WHISTLER	[Icon]
SWITCH	[Icon]
SPIKE	[Icon]
SNAKE	[Icon]
CONNECTION	[Icon]
NORDIC	[Icon]
SIDEWINDER	[Icon]
GLADES	[Icon]
SPUR	[Icon]
CANNONBALL	[Icon]
LOWER FAST TRACK	[Icon]
LOWER RUNAWAY	[Icon]
RATTLER	[Icon]
BOOMER	[Icon]
SMOKE	[Icon]
WHITE LIGHTNING	[Icon]

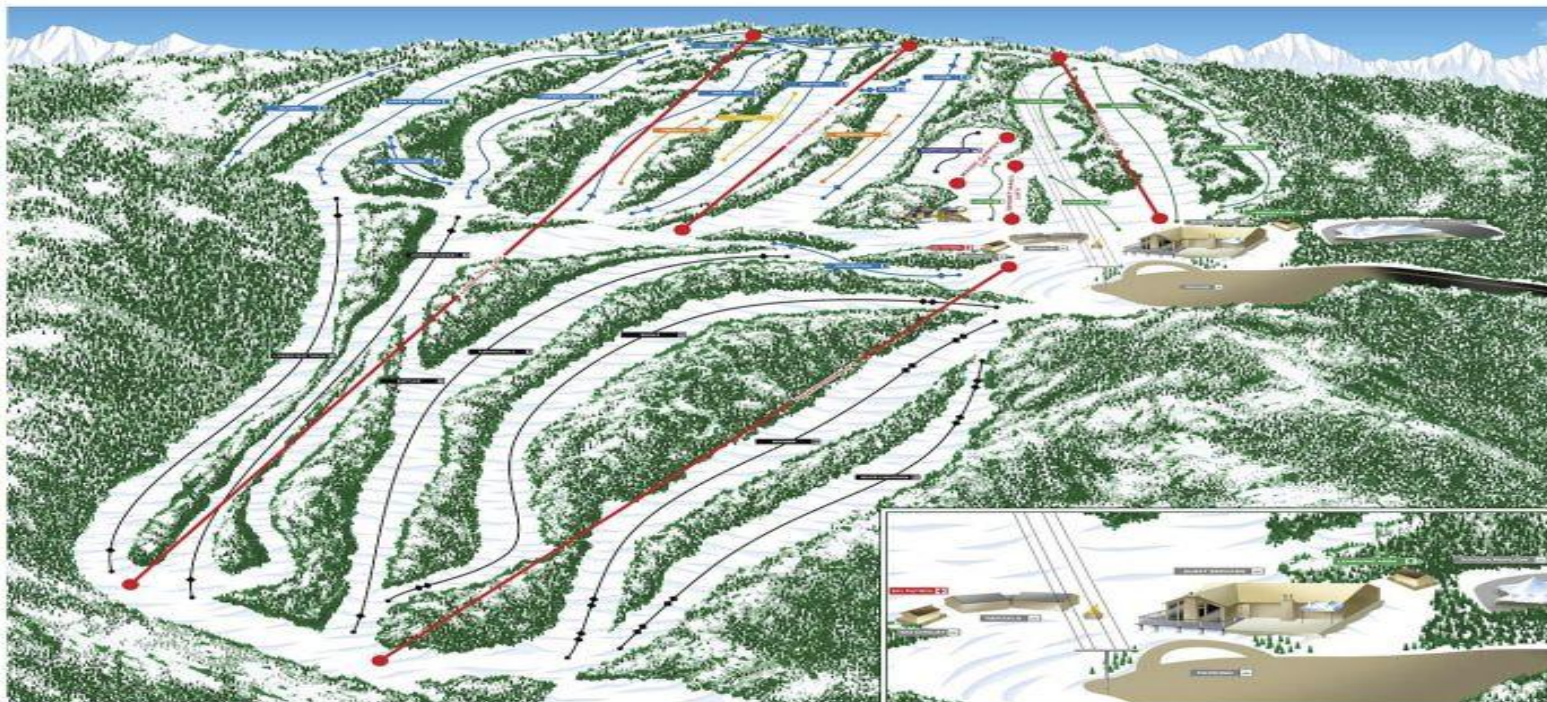



# TANKER PROGRAM CONTINUES TO DEVELOP AND EXPAND!

















# NEW PUMPER OPTIONS





Coffin Landing











Walk-Lay



Up to 250' of  
1  $\frac{3}{4}$ "

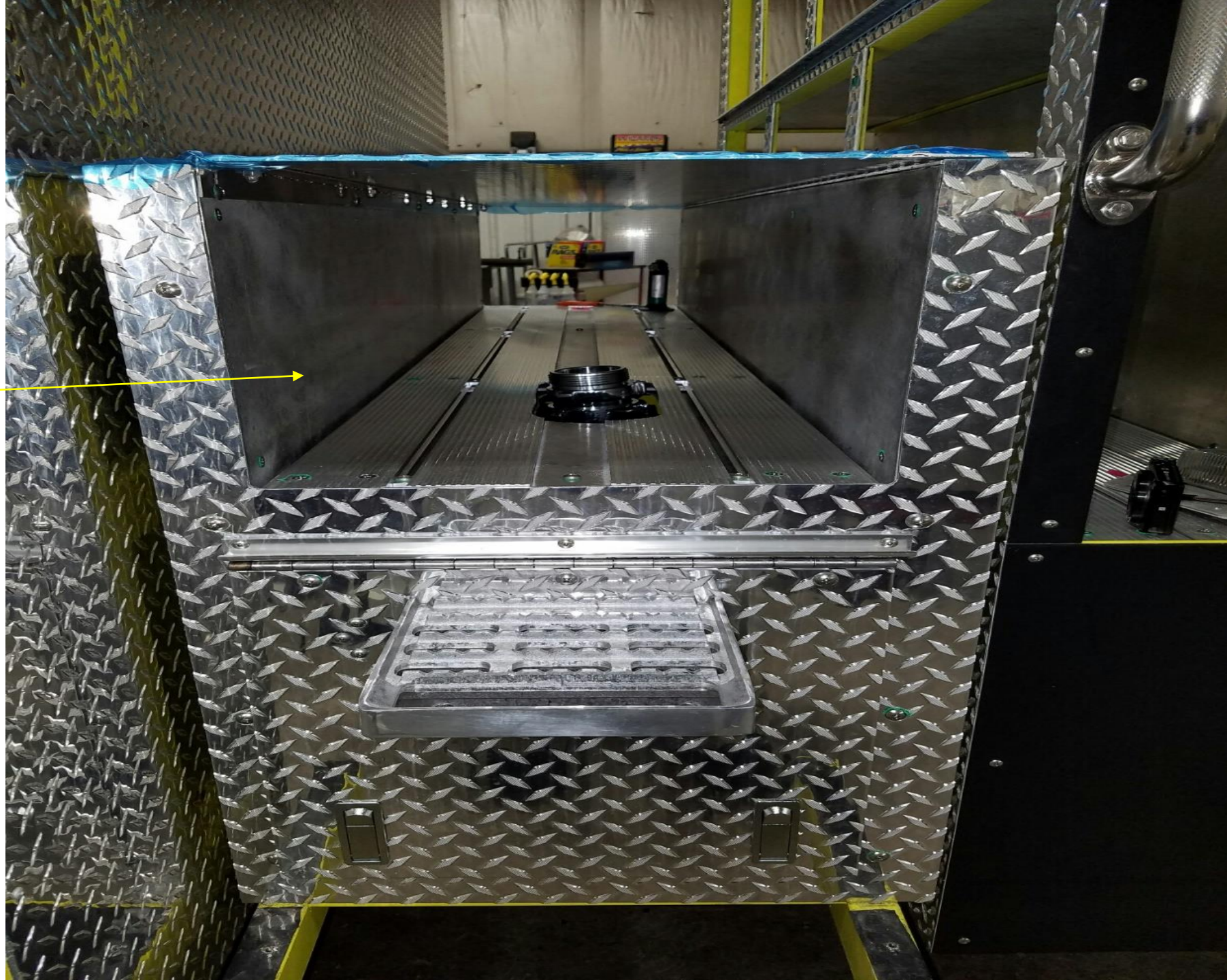



# New key personnel:

- Bonny Kimberlin, Project Coordinator
- Tony Sambuca, Production Engineer
- Please note our new cell numbers in the email Alissa sent out.
- Darryl's new cell # 570-470-3098



# **SUTPHEN**

**STRONG. STABLE. COMMITTED.**  
**SINCE 1890**

