



SUTPHEN CORPORATION

2018 SUTPHEN CHASSIS

**NO ONE BUILDS A
CHASSIS SYSTEM LIKE
SUTPHEN**





SUTPHEN CORPORATION



EXTREME DUTY CHASSIS

Since 1968, our experience and focus on the fire service have driven Sutphen to build the industry's most Extreme Duty Chassis. Every inch of our custom chassis is built to withstand the most severe firefighting conditions. From the cab construction, heavy wall 6061 T6 aluminum extrusions and heavy duty aluminum plate, to the steel box tube design Subframe under cab, our chassis provides superior crash protection and is fully certified to meet all ASME and ECE standards. Our standard double frame rails, cross members, and suspension hangers are Huck Bolted with Grade 8 fasteners, and are bead blasted to prep the surface for better adhesion of the Cathacoat primer and durable Imron top coat paint to ensure that it will be long lasting and safe from corrosion. The front and rear suspension work together resulting in superior handling, a smoother ride, and better turning radius. Interior durability is just as important. We utilize high quality, extreme duty products to provide a rugged interior. There are no plastic trim panels, only heavy duty Durawear seats, headliners, and back wall; full length stainless steel interior door panels; and, durable urethane coated dash, switch console, and engine hood. The bumper is 10-gauge #304 Stainless steel, reinforced with a ¼" steel plate for added crash protection. The grille and headlight housings are 14-gauge #304 stainless steel, never plastic, for durability, and give the chassis that classic Sutphen look. From the moment you see it, you know it's a Sutphen, and it's built to last.

THERE'S NOTHING LIKE A SUTPHEN.



Table of Contents

4: Cab Models (option group: 110)
5: Cab Grilles (option group: 110)
6: Cab Exterior Compartments (option group: 110)
7: Cab Doors (option group: 110)
8-12: Cab Interior Storage (option group: 110)
13: Alternators (option group: 130)
14: Front Axles (option group: 140)
15: Rear Axles (option group: 145)
16: Batteries (option group: 150)
17: Battery Chargers (option group: 150)
18-41: Front Bumpers (option group: 200)
42: Drivelines (option group: 220)
43: Engine Enclosures/Hoods (option group: 225)
44: Engines/Warranties (option group: 230)
45: Frames (option group: 250)
46: Fuel Cells (option group: 260)
47: Cab Exterior Handrails (option group: 270)
48-50: Cab Heating & Air Conditioning (option group: 280)
51: Load Managers (option group: 299)
52-54: Dash & Command Consoles (option group: 300)
55: Cab Interior Paint (option group: 310)
56: Headlights (option group: 325)
57: Cab Interior Lighting (option group: 335 & 340)
58: Cab Mirrors (option group: 380)
59: Driver's Seats (option group: 385)
60: Officer's Seats (option group: 390)
61-63: Crew Seating (option group: 395)
64: SCBA Storage (option group: 396)
65: Steering System (option group: 400)
66: Front Suspensions (option group: 410)
67: Rear Suspensions (option group: 420)
68: Tire Pressure Monitors (option group: 429)
69: Front Tires (option group: 430)
70: Rear Tires (option group: 440)
71-72: Wheels (option group: 442)
73: Tow Eyes (option group: 450)
74: Transmissions (option group: 470)
75-76: Cab Exterior Paint (option group: 900)



SUTPHEN CORPORATION

Cab Models (Option Group: 110)

CAB OPTION	CAB DESCRIPTION
11023200	CAB TSAL4 56" FLAT
11023210	CAB TSAL4A 56" 10" RR 1/2
11023235	CAB TSAL4O 56" 20" RR 1/2
11023240	CAB TSAL4D 73" FLAT
11023250	CAB TSAL4E 73" 10" RR 1/2
11023270	CAB TSAL4G 73" 15" RR 1/2
11023275	CAB TSAL4P 73" 20" RR 1/2
11023291	CAB TSAL4J 62" FLAT
11023292	CAB TSAL4K 62" 10" RR 1/2
11023294	CAB TSAL4M 62" 15" RR 1/2
11023296	CAB TSAL4N 62" 20" RR 1/2
11024200	CAB TSAL4S 56" FLAT
11024210	CAB TSAL4SA 56" 10" RR 1/2
11024240	CAB TSAL4SD 73" FLAT
11024250	CAB TSAL4SE 73" 10" RR 1/2
11024270	CAB TSAL4SG 73" 15" RR 1/2
11024291	CAB TSAL4SJ 62" FLAT
11024292	CAB TSAL4SK 62" 10" RR 1/2
11024294	CAB TSAL4SM 62" 15" RR 1/2

Cab Model Sizes:

- Overall width will be 98"
- Cab extensions range from 56" – 73"
- Flat and half raised roof designs are available - half raised roof options in 10", 15", and 20"

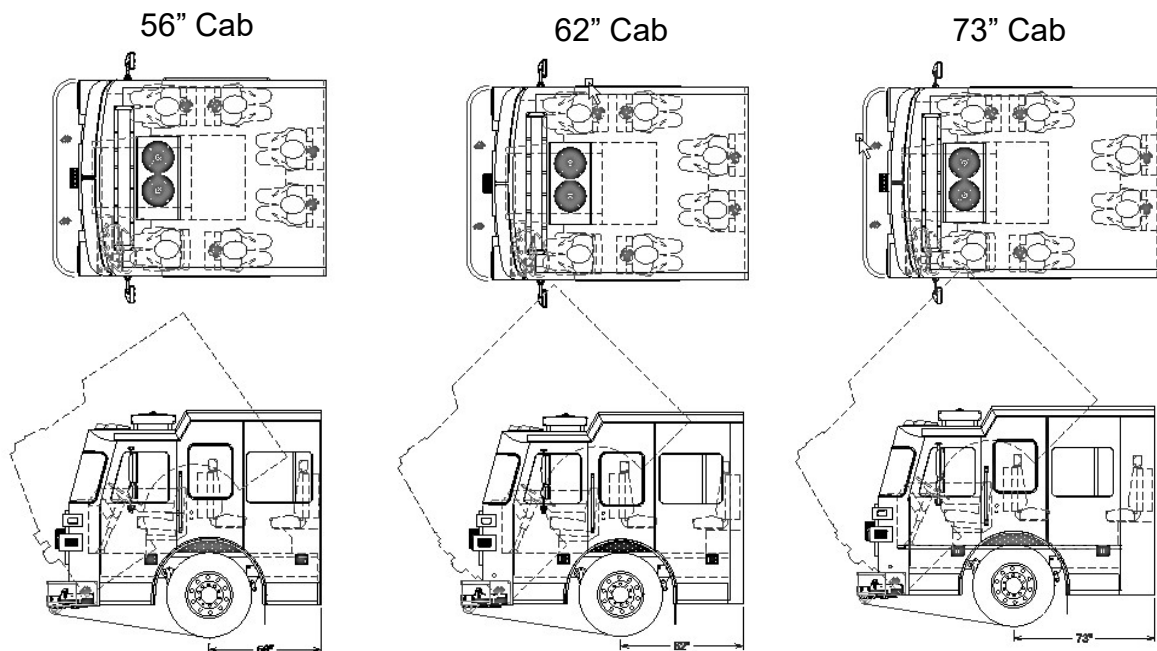



SUTPHEN CORPORATION

Cab Grilles (Option Group: 110)

GRILLE OPTION	GRILLE DESCRIPTION
11024400	RAISED GRILLE, LEVEL STYLE FACADE (ISL)
11024405	RAISED GRILLE, LEVEL STYLE FACADE (ISX)
11024410	RAISED GRILLE, TUBULAR STYLE FACADE (ISL)

- American Flag graphic available for L9 grilles only (option 90530325)
- Available with or w/out Q2B cutout

11024405 (X12-15 Only)



11024400 (L9 Only)



11024410 (L9 Only)





SUTPHEN CORPORATION

Cab Compartments – 73" Cab (Option Group: 110)

COMP'T OPTION	COMPARTMENT DESCRIPTION
11030210	EXTERIOR COMPTS, SIDE OF EXT CAB
11030215	EXTERIOR COMPTS, SIDE OF EXT CAB, TRANSVERSE

- Driver's side compartment: 38" H x 15" W x 24" D
- Officer's side compartment: 38" H x 15" W x 22" D (12" Deep if truck has front suction)

CHF-4524-22N = NON-KEY, -22K = KEY LOCK
(CHF-4524-21N, -21K FOR REAR HINGED)
CHF-4524-12N = NON-KEY, -12K = KEY LOCK
(CHF-4524-11N, -11K FOR REAR HINGED)

OPEN TO SEATBOX
(TRANSVERSE) (11030215)

CHF-4524-24N = NON-KEY, -24K = KEY LOCK
(CHF-4524-23N, -23K FOR REAR HINGED)
CHF-4524-14N = NON-KEY, -14K = KEY LOCK
(CHF-4524-13N, -13K FOR REAR HINGED)

CLOSED TO SEATBOX (11030210)

CHF-4524-32N = NON-KEY, -32K = KEY LOCK
(CHF-4524-31N, -31K FOR REAR HINGED)
CHF-4524-12N = NON-KEY, -12K = KEY LOCK
(CHF-4524-11N, -11K FOR REAR HINGED)

OPEN TO SEATBOX
W/ FRT SUCTION
(TRANSVERSE) (11030215 w/front suction)

CHF-4524-34N = NON-KEY, -34K = KEY LOCK
(CHF-4524-33N, -33K FOR REAR HINGED)
CHF-4524-14N = NON-KEY, -14K = KEY LOCK
(CHF-4524-13N, -13K FOR REAR HINGED)

CLOSED TO SEATBOX
W/ FRT SUCTION (11030210 w/front suction)

COMPARTMENT ASSEMBLY P/N'S AS FOLLOWS:

CHF-4524-XXX

N = NON-LOCKING DOOR
K = KEY LOCKING DOOR

1 = DRIVER SIDE
2 = OFF. SIDE
3 = OFF. SIDE W/FRT SUCTION

1 = REAR HINGED, OPEN (TRANSVERSE)
2 = FWD. HINGED, OPEN (TRANSVERSE)
3 = REAR HINGED, CLOSED
4 = FWD. HINGED, CLOSED

EXAMPLES:

CH-4524-11K = DR. SIDE REAR HINGED/OPEN COMPARTMENT, W/ KEYED LOCK

CHF-4524-34N = OFF. SIDE W/FRT SUCTION & FWD HINGE/CLOSED COMPARTMENT, NON-KEYED

SPECIAL NOTES:

1. FORWARD HINGED COMPARTMENTS ARE STANDARD (REAR HINGED NOTED IN PARENTHESES)

DIMENSIONS ARE IN INCHES DIMENSIONAL TOLERANCES (UNLESS OTHERWISE NOTED)	
.XX = ±.06	ANGLE = ±1°
.XXX = ±.031	FRACT = ±1/16

MATERIAL:	DESCRIPTION:
MATERIAL THICKNESS =	COMPARTMENT OPTIONS, REAR CAB OUTER
FINISH:	DOCUMENT NUMBER
DATE:	CPE-0029
WEIGHT:	SHEET
LBS	1 OF 1

DATE: 02/20/2012

CONFIDENTIAL: THIS DOCUMENT IS THE CONFIDENTIAL AND PROPRIETARY PROPERTY OF SUTPHEN CORPORATION. THE USE, REPRODUCTION OR DISCLOSURE IN WHOLE OR IN PART, OF THE DOCUMENT OR THE INFORMATION CONTAINED THEREIN, IS STRICTLY PROHIBITED WITHOUT THE WRITTEN AUTHORIZATION OF SUTPHEN CORPORATION.

SUTPHEN CORPORATION
FIRE APPARATUS SINCE 1890
6450 ETERNAH ROAD
DUBLIN, OH 43016 600-548-5860

DESIGNED BY: J. MADDALENA



SUTPHEN CORPORATION

Cab Door Options (Option Group: 110)

DOOR OPTION	DOOR DESCRIPTION
11031350	CAB DOORS, FULL LENGTH
11031355	CAB DOORS, BARRIER STYLE

11031350



11031355



- Barrier door stepwells (exposed to outside) will be coated in Scorpion. Scorpion coating can match interior or exterior of cab color.

11031359 Treadplate, back wall of lower cab step wells (for barrier doors option)



11031360 Treadplate, back wall & sides of lower cab step wells (for barrier doors option)





SUTPHEN CORPORATION

Cab Storage – In front of Officer (Option Group: 110)

<u>STORAGE OPTION</u>	<u>STORAGE DESCRIPTION</u>
11031509	GLOVE BOX, FDNY STYLE
11031510	FLAT WORK SURFACE IN LIEU OF GLOVE BOX
11031512	COMPUTER TRAY IN LIEU OF GLOVE BOX
11031515	COMPUTER TRAY W/STATIONARY STORAGE

- Flat work surface - standard (11031510)

11031509



11031512 (AX# 10043820)



11031515

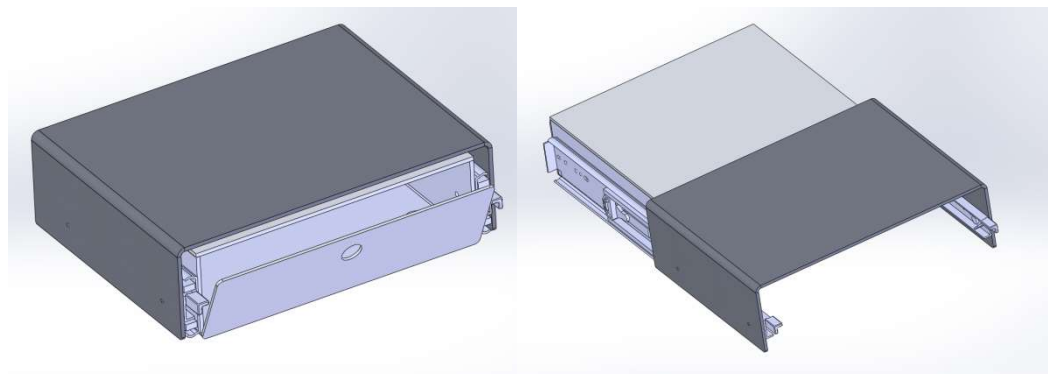



SUTPHEN CORPORATION

Cab Storage – On Engine Hood/Heat-AC Unit (Option Group: 110)

STORAGE OPTION	STORAGE DESCRIPTION
11031670	NO STORAGE ON ENGINE ENCLOSURE
11031679	CENTER CONSOLE, TOP OF ENGINE ENCLOSURE
11031680	CENTER CONSOLE W/MAP BOOK STORAGE, TOP OF ENGINE ENCLOSURE
11031681	TOOL MOUNTING PLATE, TOP OF ENGINE ENCLOSURE
11031682	TOOL TRAY W/1" LIP, TOP OF ENGINE ENCLOSURE
11031685	MAP BOOK STORAGE COMPARTMENT, TOP OF HEAT/AC UNIT
11031686	TOOL TRAY, 24.5"x 18.5" W/2" LIP, TOP OF HEAT/AC UNIT
11031687	TOOL MOUNTING PLATE, 25" x 19.5", TOP OF HEAT/AC UNIT (STANDARD)
11031690	STORAGE COMPT, BACK OF HEAT/AC UNIT

11031679

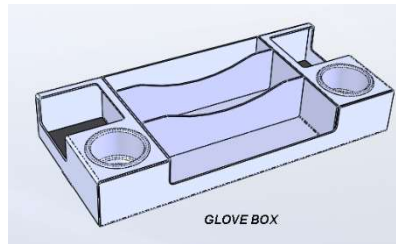

11031680

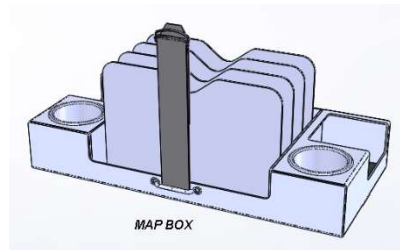

11031681

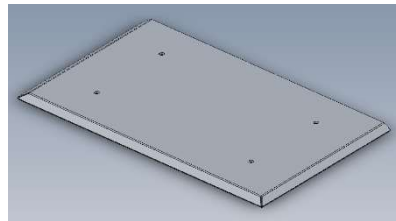

11031682

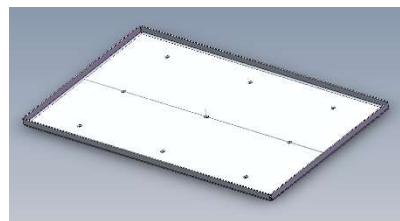

11031685

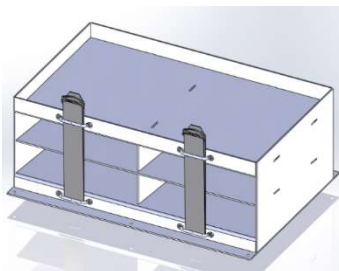

11031686

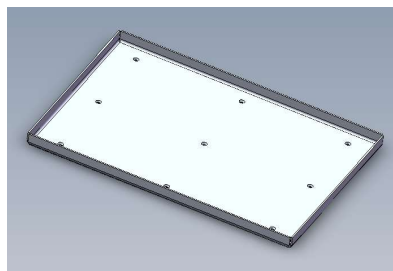

11031687



11031690



SUTPHEN CORPORATION

Cab – Glove box storage, crew cab area (Option Group: 110)

<u>STORAGE OPTION</u>	<u>STORAGE DESCRIPTION</u>
11031701	GLOVE BOX HOLDERS IN UPPER CREW DOORS (SLANT BACK, RR)
11031702	GLOVE BOX HOLDERS IN UPPER CREW DOORS (FLAT BACK, RR)

11031701



11031702





SUTPHEN CORPORATION

Overhead Storage Cabinets (Option Group: 110)

<u>STORAGE OPTION</u>	<u>STORAGE DESCRIPTION</u>
11031740	OVERHEAD STORAGE, FRONT OF 10" RR W/NET
11031745	OVERHEAD STORAGE, FRONT OF 10" RR W/DOORS
11031750	OVERHEAD STORAGE, FRONT OF 15" RR W/NET
11031755	OVERHEAD STORAGE, FRONT OF 15" RR W/DOORS
11031756	OVERHEAD STORAGE, REAR OF 15" RR W/DOORS
11031757	OVERHEAD STORAGE, REAR OF 15" RR W/NET
11031760	OVERHEAD STORAGE, FRONT OF 20" RR W/NET
11031765	OVERHEAD STORAGE, FRONT OF 20" RR W/DOORS
11031766	OVERHEAD STORAGE, REAR OF 20" RR W/DOORS
11031767	OVERHEAD STORAGE, REAR OF 20" RR W/NET

Flip-up Doors

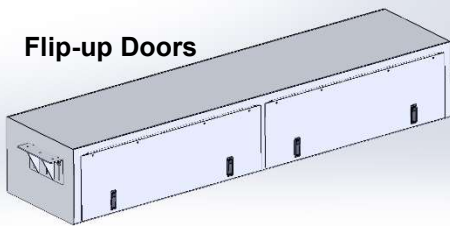

Rear facing cabinets w/doors:

- 11031745: 84"W x 9.5"H x 20"D (9ft³)
- 11031755: 84"W x 14.5"H x 20"D (14ft³)
- 11031765: 84"W x 19.5"H x 20"D (19ft³)

Netting

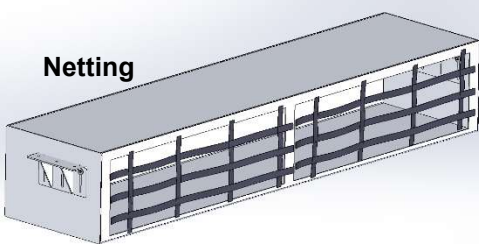

Rear facing cabinets w/nets:

- 11031740: 84"W x 9.5"H x 20"D (9ft³)
- 11031750: 84"W x 14.5"H x 20"D (14ft³)
- 11031760: 84"W x 19.5"H x 20"D (19ft³)

Flip-up Doors

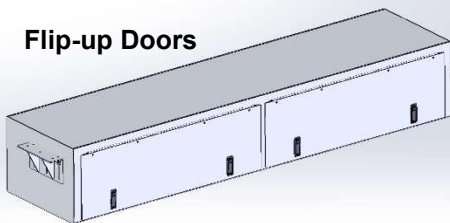

Forward facing cabinets w/doors (available for 73" flat back cabs):

- 11031746: 84"W x 9.5"H x 16"D (7ft³)
- 11031756: 84"W x 14.5"H x 16"D (11ft³)
- 11031766: 84"W x 19.5"H x 16"D (15ft³)

Netting

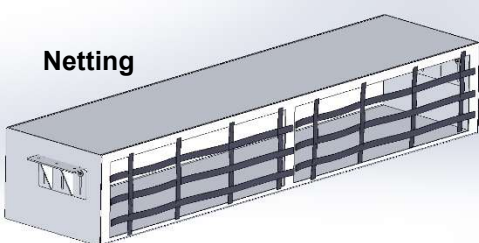

Forward facing cabinets w/nets (available for 73" flat back cabs):

- 11031747: 84"W x 9.5"H x 16"D (7ft³)
- 11031757: 84"W x 14.5"H x 16"D (11ft³)
- 11031767: 84"W x 19.5"H x 16"D (15ft³)



SUTPHEN CORPORATION

EMS Cabinets (Option Group: 110)

CABINET OPTION	CABINET DESCRIPTION
11031800	EMS CABINET, FORWARD FACING, SINGLE
11031806	EMS CABINET, OUTWARD FACING, FLAT ROOF
11031808	EMS CABINET, OUTWARD FACING, RAISED ROOF
11031812	EMS CABINET, FORWARD FACING, ON FLOOR (OUTBOARD)
11031814	EMS CABINET, FORWARD FACING, SINGLE (AERIAL)
11031821	EMS CABINET, REAR FACING, BEHIND DRIVER
11031822	EMS CABINET, REAR FACING, BEHIND OFFICER
11031825	EMS CABINET, FORWARD FACING, DOUBLE ON CREW SEAT RISER
11031827	EMS CABINET, FORWARD FACING, DOUBLE ON CREW SEAT RISER (FLAT ROOF)
11031828	EMS CABINET, FORWARD FACING, DOUBLE ON CREW SEAT RISER (RAISED ROOF)
11031835	EMS CABINET, REAR FACING, EXTERIOR ROLL-UP & INTERIOR HINGED DOOR
11031836	EMS CABINET, REAR FACING, EXTERIOR HINGED & INTERIOR ROLL-UP DOOR
11031837	EMS CABINET, REAR FACING, EXTERIOR HINGED & INTERIOR HINGED DOOR
11031850	ADDITIONAL ADJUSTABLE SHELF FOR EMS CABINET

- Available with ROM or Amdor doors, or netting (specify on Shop Order)
- EMS color/finish will match cab interior color

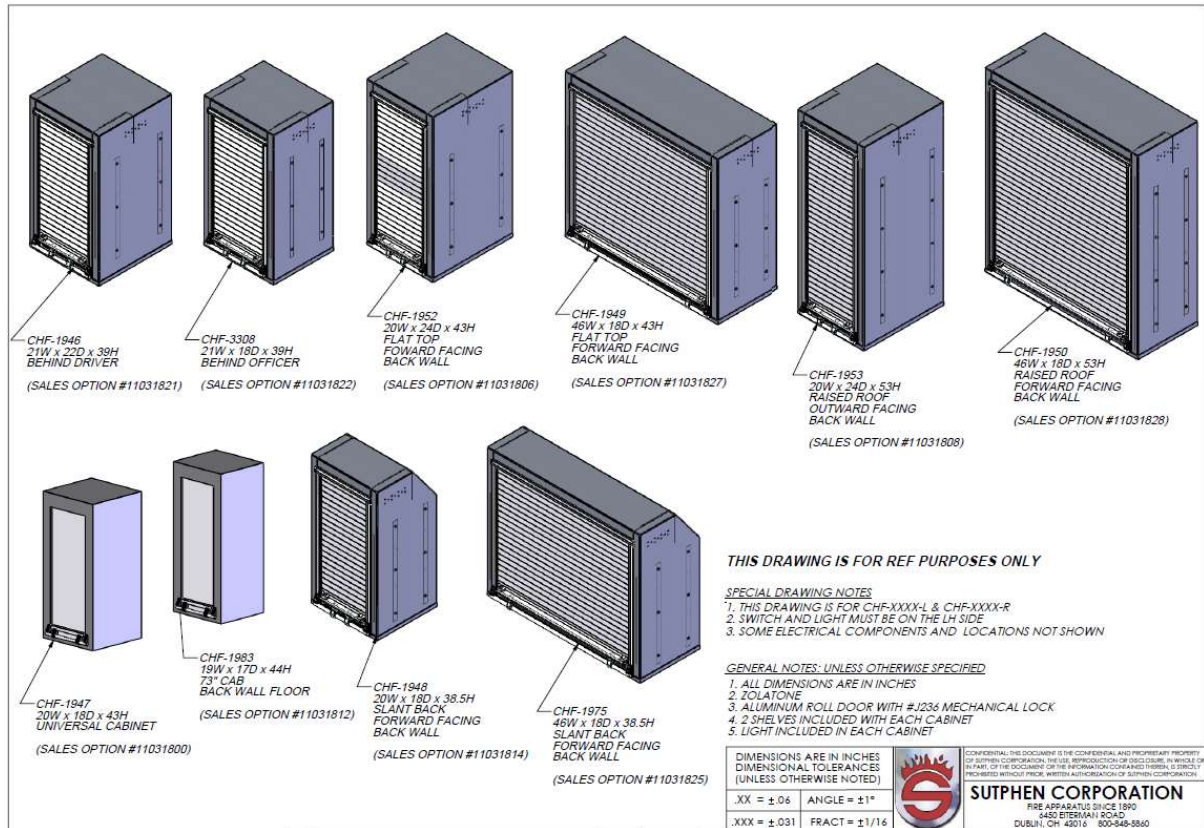



SUTPHEN CORPORATION

Alternators (Option Group: 130)

ALTERNATOR OPTION	ALTERNATOR DESCRIPTION
13010050	ALTERNATOR, LEECE NEVILLE 270 AMP 4949PA
13010110	ALTERNATORS LEECE NEVILLE 270 AMP DUAL 4949PA
13010205	ALTERNATOR, LEECE NEVILLE 320 AMP 4962PA
13012115	ALTERNATOR, NIEHOFF, 360 AMP
13012120	ALTERNATOR, NIEHOFF, 430 AMP

Available Alternator Applications:

(*KEY: Standard Duty AC – TM21 AC Compressor/Severe Duty AC – TM31 AC Compressor)

	Engine				
Alternator	L9 with TM21	L9 with TM31	X12 with TM21	X12 with TM31	X15 with TM21
270A Leece Neville (13010050)	X	X	X	X	X
320A Leece Neville (13010205)	X	X	X	X	X
540A Leece Neville (270A Duals, 13010110)	Not Available	Not Available	X	X	Not Available
360A Niehoff (13012115)	X	X	X	X	X
430A Niehoff (13012120)	Not Available	Not Available	X	X	Not Available
Note: TM31 not available w/X15					



SUTPHEN CORPORATION

Front Axles (Option Group: 140)

Available front axle options:

(23K – 25.5K Front Axle require steering assist)

<u>FRONT AXLE OPTION</u>	<u>FRONT AXLE DESCRIPTION</u>	<u>BRAKE OPTIONS</u>
14010505	FRONT AXLE, MERITOR MFS-18-133A 18,000 LB.	S-CAM/DISC
14010520	FRONT AXLE, MERITOR MFS-18-133A 19,000 LB.	S-CAM/DISC
14010524	FRONT AXLE, MERITOR MFS-20-133A 20,000 LB.	S-CAM/DISC
14010527	FRONT AXLE, MERITOR MFS-20-133A 23,000 LB.	S-CAM/DISC
14021600	FRONT AXLE, DANA EFA245T, 25,500 LBS.	S-CAM ONLY



SUTPHEN CORPORATION

Rear Axles (Option Group: 145)

Available rear axle options:

FRONT AXLE OPTION	FRONT AXLE DESCRIPTION	BRAKE OPTIONS
14510520	REAR AXLE, MERITOR RS-24-160 24,000 LB.	S-CAM/DISC
14510530	REAR AXLE, MERITOR RS-26-185 27,000 LB.	S-CAM/DISC
14510540	REAR AXLE, MERITOR RS-30-185 31,000 LB.	S-CAM ONLY
14511500	REAR AXLE, DANA S35-580 35,000 LBS.	S-CAM ONLY
14520305	REAR AXLE, MERITOR RT-40-145 40,000 LB TANDEM	S-CAM/DISC
14520307	REAR AXLE, MERITOR RT-44-145 44,000 LB TANDEM	S-CAM/DISC
14520308	REAR AXLE, MERITOR RT-48-160 48,000 LB TANDEM	S-CAM/DISC
14520310	REAR AXLE, MERITOR RT-50-180 52,000 LB TANDEM	S-CAM/DISC
14520312	REAR AXLE, MERITOR RT-60-180 58,000 LB TANDEM	S-CAM/DISC

Top speeds:

50K GVWR and under: 68 MPH

51K GVWR and over: 60 MPH



SUTPHEN CORPORATION

Batteries (Option Group: 150)

Available battery options:

BATTERY OPTION	BATTERIES DESCRIPTION
15010500	BATTERIES, INTERSTATE TYPE 31 MHD (4)
15010501	BATTERIES, INTERSTATE TYPE 31 MHD (4) Multi
15010510	BATTERIES, INTERSTATE TYPE 31 MHD (6)
15010511	BATTERIES, INTERSTATE TYPE 31 MHD (6) Multi
15010600	BATTERIES, WORLDWIDE TYPE 31 (4)
15010601	BATTERIES, WORLDWIDE TYPE 31 (4) Multi
15010610	BATTERIES, WORLDWIDE TYPE 31 (6)
15010611	BATTERIES, WORLDWIDE TYPE 31 (6) Multi

Battery box, point-to-point electrical system:



Battery box, multiplex electrical system:



OPTION	DESCRIPTION
15031700	BATTERY JUMPER TERMINALS
15030215	MASTER BATTERY DISCONNECT SWITCH





SUTPHEN CORPORATION

Battery Chargers (Option Group: 150)

Available battery charger options:

BATTERY CHARGER OPTIONS	OPTION DESCRIPTION
15030410	120V SHORELINE INLET, MANUAL, HUBBEL #HBL61CM64 (GRAY)
15030420	120V SHORELINE INLET, MANUAL, KUSSMAUL WPR-1-XX
15030430	120V SHORELINE INLET, KUSSMAUL SUPER 20 AUTO EJECT
15030440	120V SHORELINE INLET, KUSSMAUL SUPER 30 AUTO EJECT
15031560	BATTERY CHARGER, KUSSMAUL LPC 40 W/REMOTE BAR GRAPH DISPLAY
15031577	BATTERY CHARGER, IOTA DLS-45
15031590	GREEN INDICATOR LIGHT FOR BATTERY CHARGER



Bar graph display
(visible from
Driver's cab
side window):



Kussmaul 20A
Auto Eject:

Weatherproof
exterior display



Green
indicator
light for
battery
charger:

Manual
Shoreline
inlet:



Kussmaul
30A Auto
Eject:

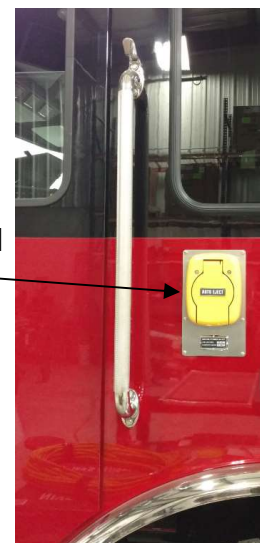



SUTPHEN CORPORATION

Front Bumpers (Option Group: 200)

Available front bumper options:

BUMPER OPTION	BUMPER DESCRIPTION
20010070	BUMPER, 6" EXTENSION
20010075	BUMPER, 12" EXTENSION
20010080	BUMPER, 18" EXTENSION
20010085	BUMPER, 24" EXTENSION
20011500	BUMPER, 30" EXTENSION (RESCUE PACKAGE)
20012200	BUMPER, 12" FORMED STEEL CHANNEL, PAINTED
20012210	BUMPER, 18" FORMED STEEL CHANNEL, PAINTED
20012220	BUMPER, 24" FORMED STEEL CHANNEL, PAINTED
20012300	BUMPER, 12" EXTREME DUTY STEEL, PAINTED
20012310	BUMPER, 18" EXTREME DUTY STEEL, PAINTED
20012320	BUMPER, 24" EXTREME DUTY STEEL, PAINTED

Available front bumper storage well options:

STORAGE WELL OPTION	STORAGE WELL DESCRIPTION
20040100	STORAGE WELL, SHALLOW, FULL WIDTH (18" BUMPER)
20040102	STORAGE WELL, SHALLOW, 3/4 WIDTH (18" BUMPER)
20040105	STORAGE WELL, DEEP CENTER, FULL WIDTH (18" BUMPER)
20040107	STORAGE WELL, DEEP CENTER, 3/4 WIDTH (18" BUMPER)
20040110	STORAGE WELL, CENTER ONLY (18" BUMPER)
20040200	STORAGE WELL, CENTER ONLY (24" BUMPER)
20040210	STORAGE WELL, SHALLOW, FULL WIDTH (24" BUMPER)
20040215	STORAGE WELL, DEEP CENTER, FULL WIDTH (24" BUMPER)
20040220	STORAGE WELL, ALL DEEP COMPTS, FULL WIDTH (24" BUMPER)
20040230	STORAGE WELL, DEEP CENTER, 3/4 WIDTH (24" BUMPER)
20040300	1" LIP AROUND BUMPER TROUGH

Available storage well lid options:

STORAGE WELL LID OPTION	STORAGE WELL LID DESCRIPTION
20030100	COVER FOR BUMPER TROUGH, TREADPLATE, 2" RAISE
20030120	COVER FOR BUMPER TROUGH, TREADPLATE, 4" RAISE
20030200	VELCRO STRAPS (2), BUMPER TROUGH
20030300	COVER FOR BUMPER TROUGH, VINYL

- Painted steel bumpers: available with treadplate sides (partial wrap) or painted steel sides (full wrap).
- Recessed side pockets (for warning/scene lighting & cab tilt switching): available for 18", 24" & 30" bumpers.



Front Bumpers (Option Group: 200)

6" Bumper Options:

6" Bumper, Stainless Steel Skin, Rectangular Air Horns Outboard, ISX Perforations, Tow Eyes Below (ASSY Number: CHF-6066 – ISL Version: CHF-7979)

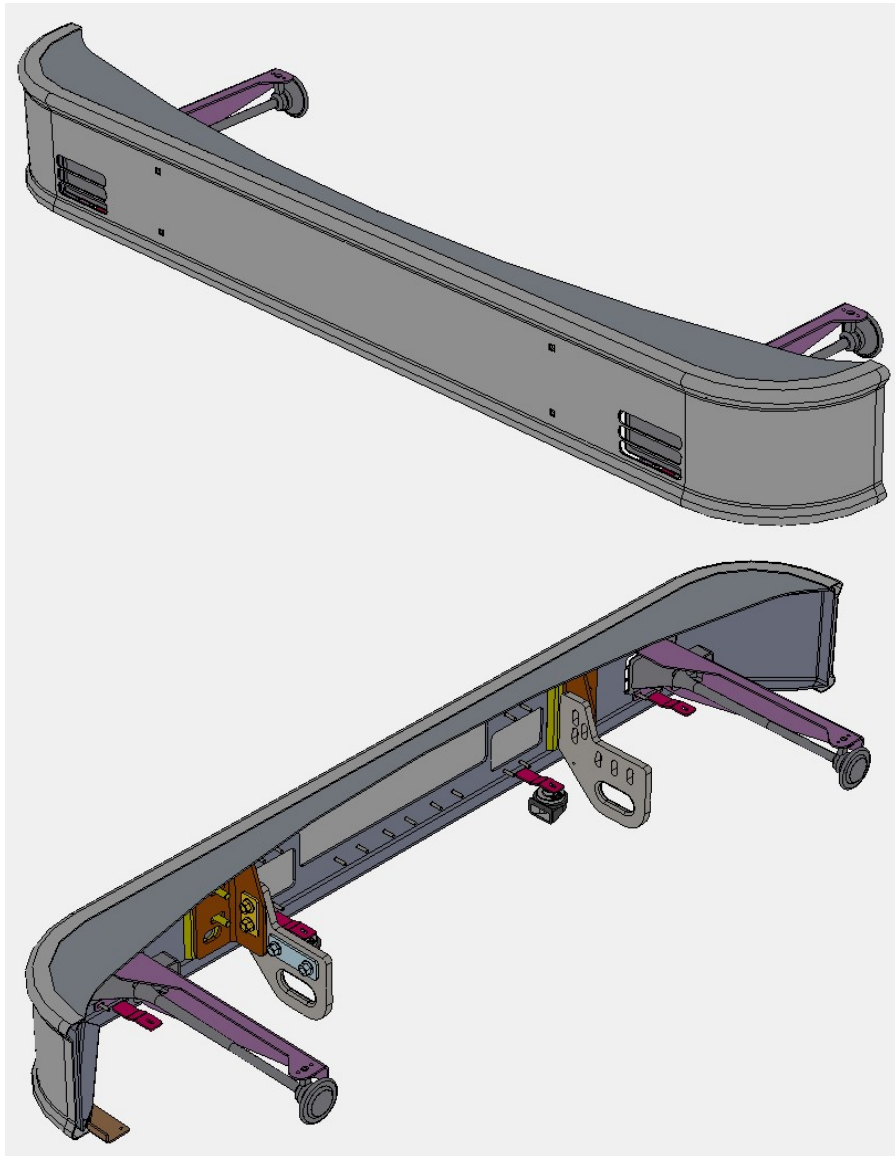



Front Bumpers (Option Group: 200)

6" Bumper Options:

6" Bumper, Painted Steel Skin, Rectangular Air Horns Outboard, ISX Perforations, Tow Eyes Below (ASSY Number: CHF-6017 – ISL Version: TBD)

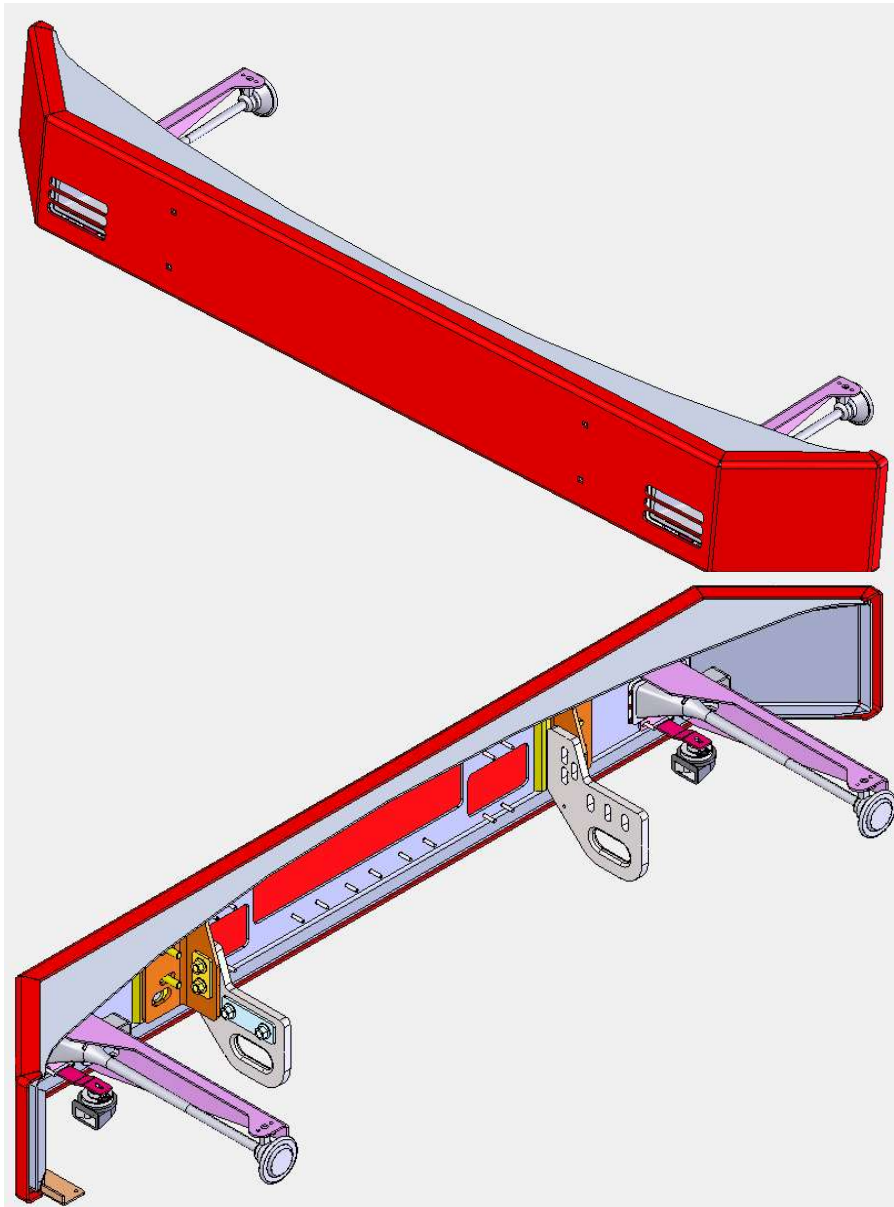



Front Bumpers (Option Group: 200)

12" Bumper Options:

12" Bumper, Stainless Steel Skin, Rectangular Air Horns Outboard, ISX Perforations, Tow Eyes Below (ASSY Number: CHF-6035 – ISL Version: CHF-6048)

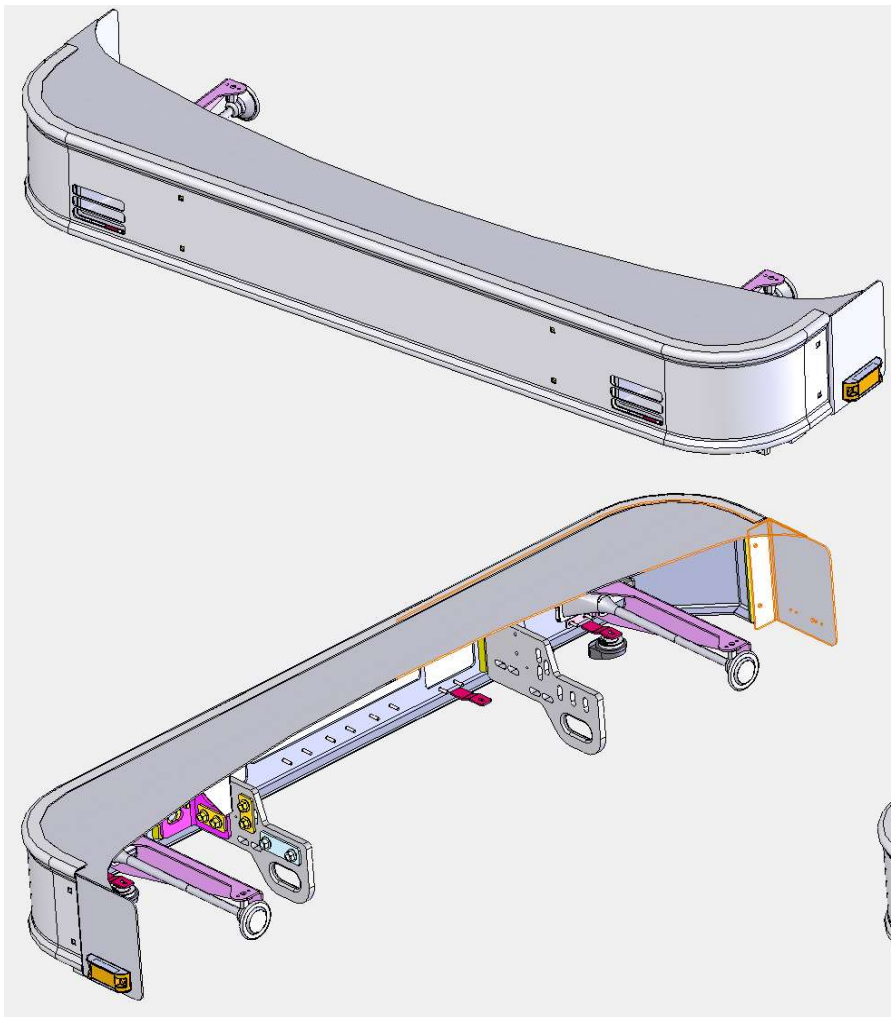



Front Bumpers (Option Group: 200)

12" Bumper Options:

12" Bumper, Painted Steel Skin, Rectangular Air Horns Outboard, ISX Perforations, Tow Eyes Below (ASSY Number: CHF-7717 – ISL Version: TBD)

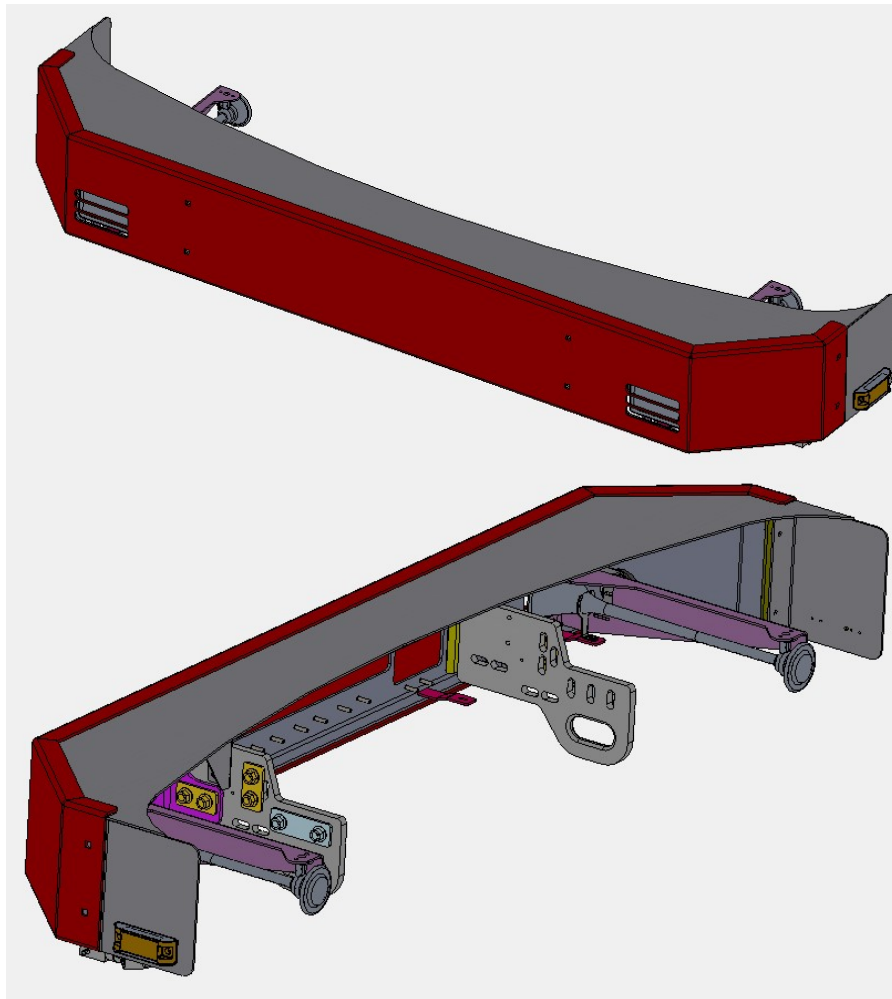



Front Bumpers (Option Group: 200)

18" Bumper Options:

18" Bumper, Stainless Steel Skin, Full Width/Shallow Trough, Rectangular Air Horns Outboard, ISL Perforations, Tow Eyes Below (ASSY Number: CHF-6091 – ISX Version: TBD)

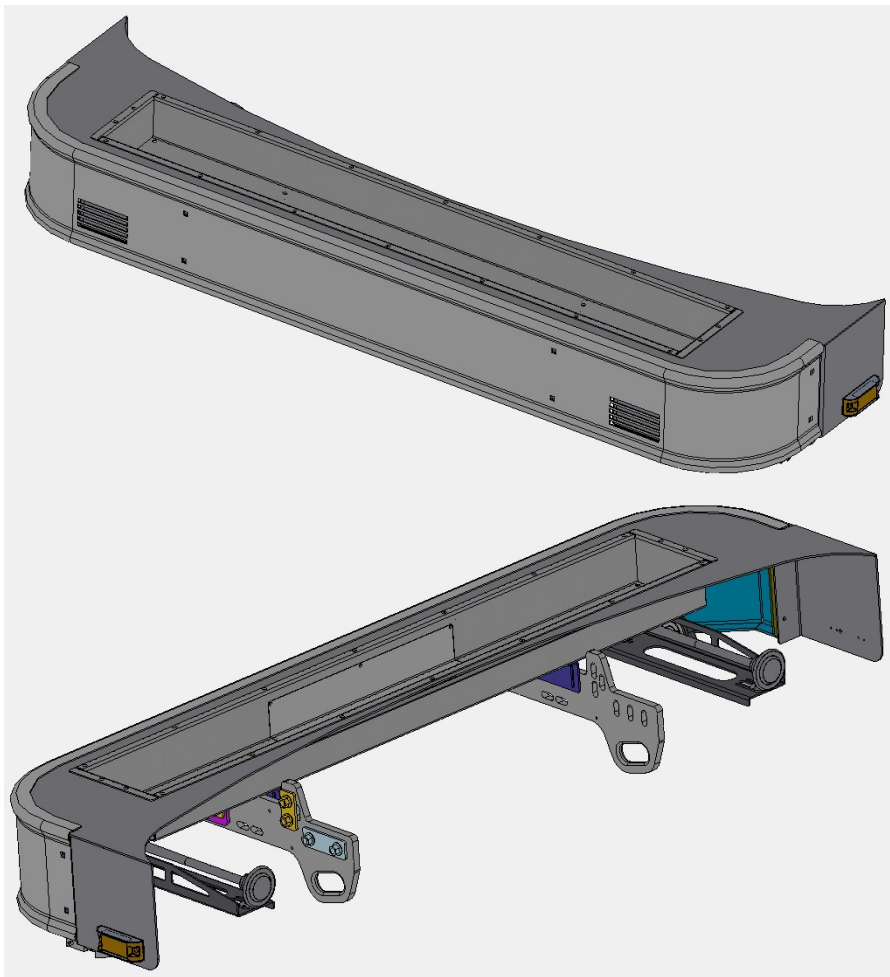



Front Bumpers (Option Group: 200)

18" Bumper Options:

18" Bumper, Painted Steel Skin, Full Width/Shallow Trough, Rectangular Air Horns Outboard, ISL Perforations, Tow Eyes Below (ASSY Number: CHF-7400 – ISX Version: TBD)

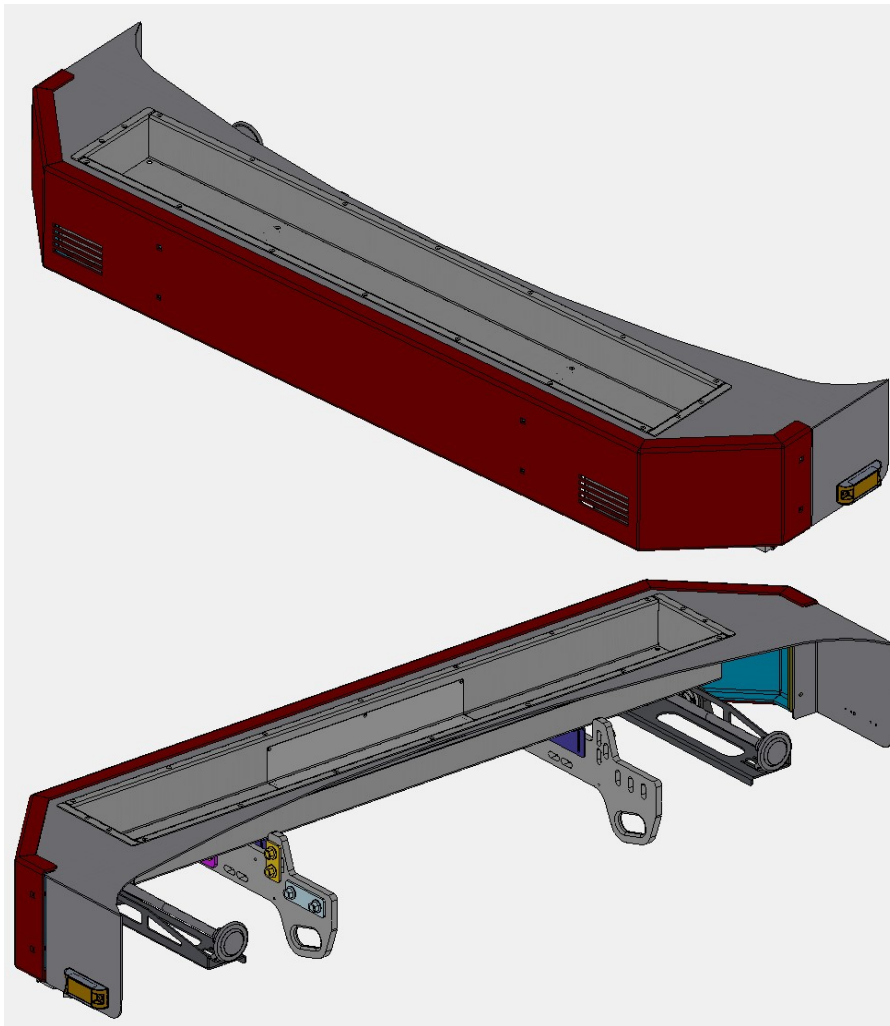



SUTPHEN CORPORATION

Front Bumpers (Option Group: 200)

18" Bumper Options:

18" Bumper, Stainless Steel Skin, Full Width/Shallow Trough W/1" Lip, Rectangular Air Horns Outboard, ISL Perforations, Tow Eyes Below (ASSY Number: CHF-5974 – ISX & Painted Versions: TBD)

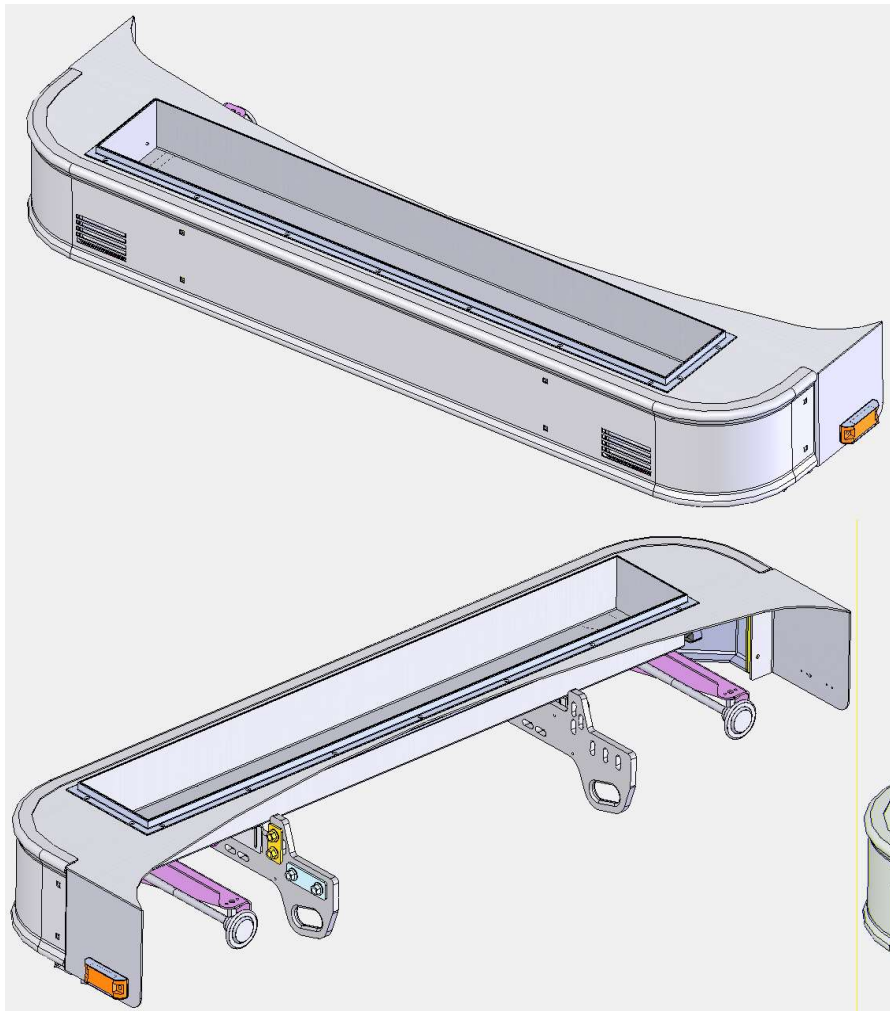



Front Bumpers (Option Group: 200)

18" Bumper Options:

18" Bumper, Stainless Steel Skin, Full Width/Deep Center Trough, Rectangular Air Horns Outboard, ISL Perforations, Tow Eyes Below (ASSY Number: CHF-7250 – ISX Version: CHF-7131)

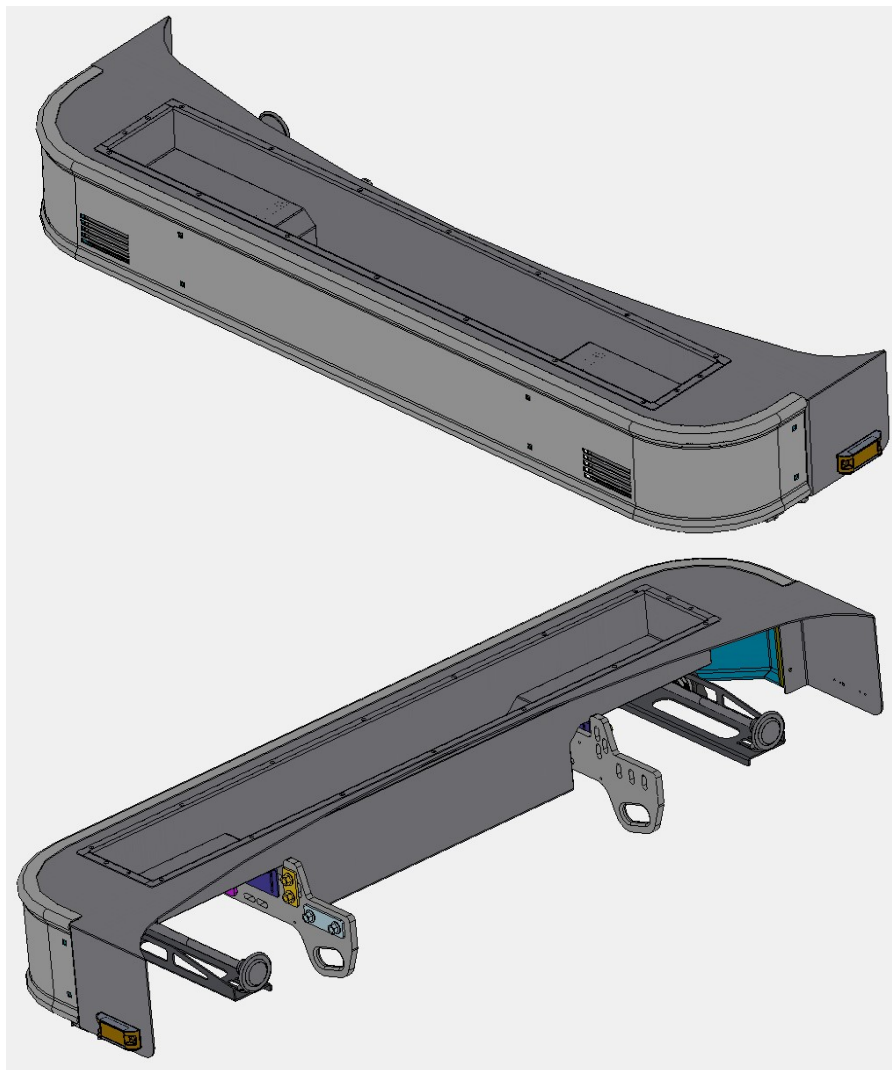



Front Bumpers (Option Group: 200)

18" Bumper Options:

18" Bumper, Painted Steel Skin, Full Width/Deep Center Trough, Rectangular Air Horns Outboard, ISL Perforations, Tow Eyes Below (ASSY Number: CHF-7928 – ISX Version: TBD)

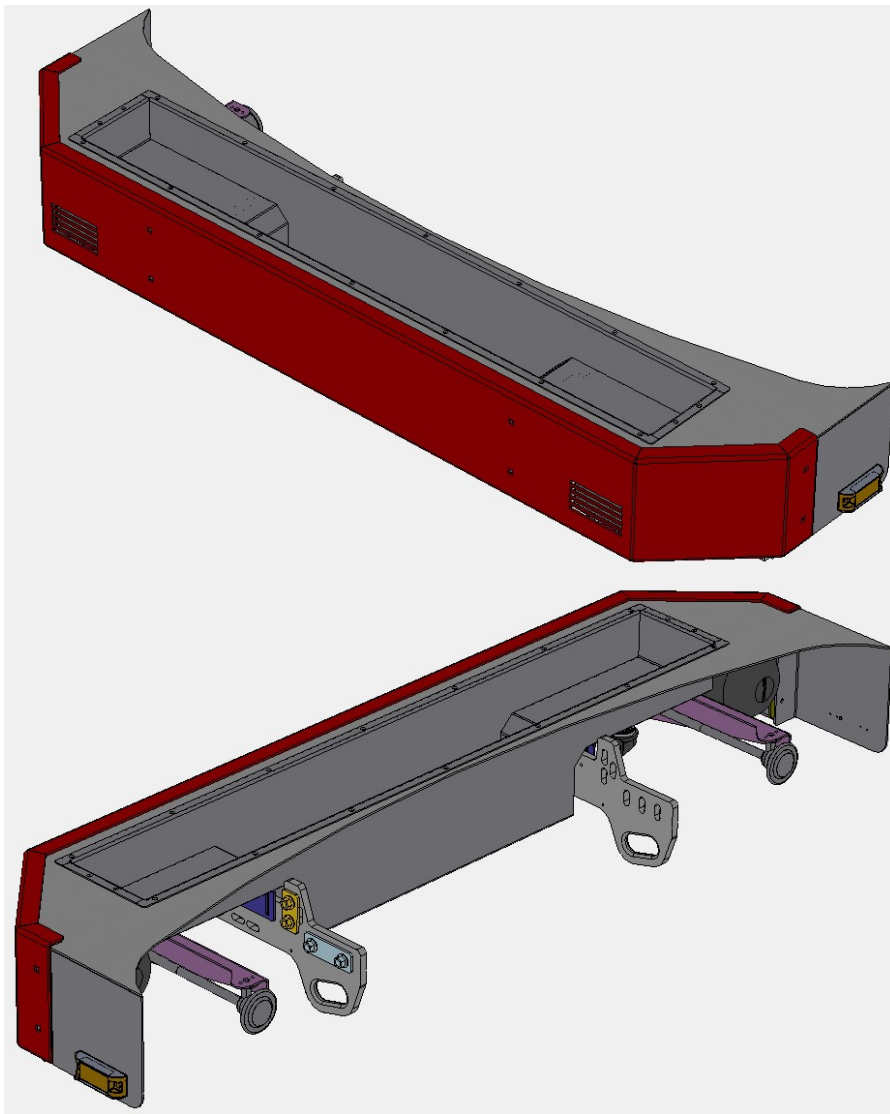



Front Bumpers (Option Group: 200)

18" Bumper Options:

18" Bumper, Stainless Steel Skin, Full Width/Deep Center Trough W/1" Lip, Rectangular Air Horns Outboard, ISL Perforations, Tow Eyes Below (ASSY Number: CHF-5867 – ISX & Painted Versions: TBD)

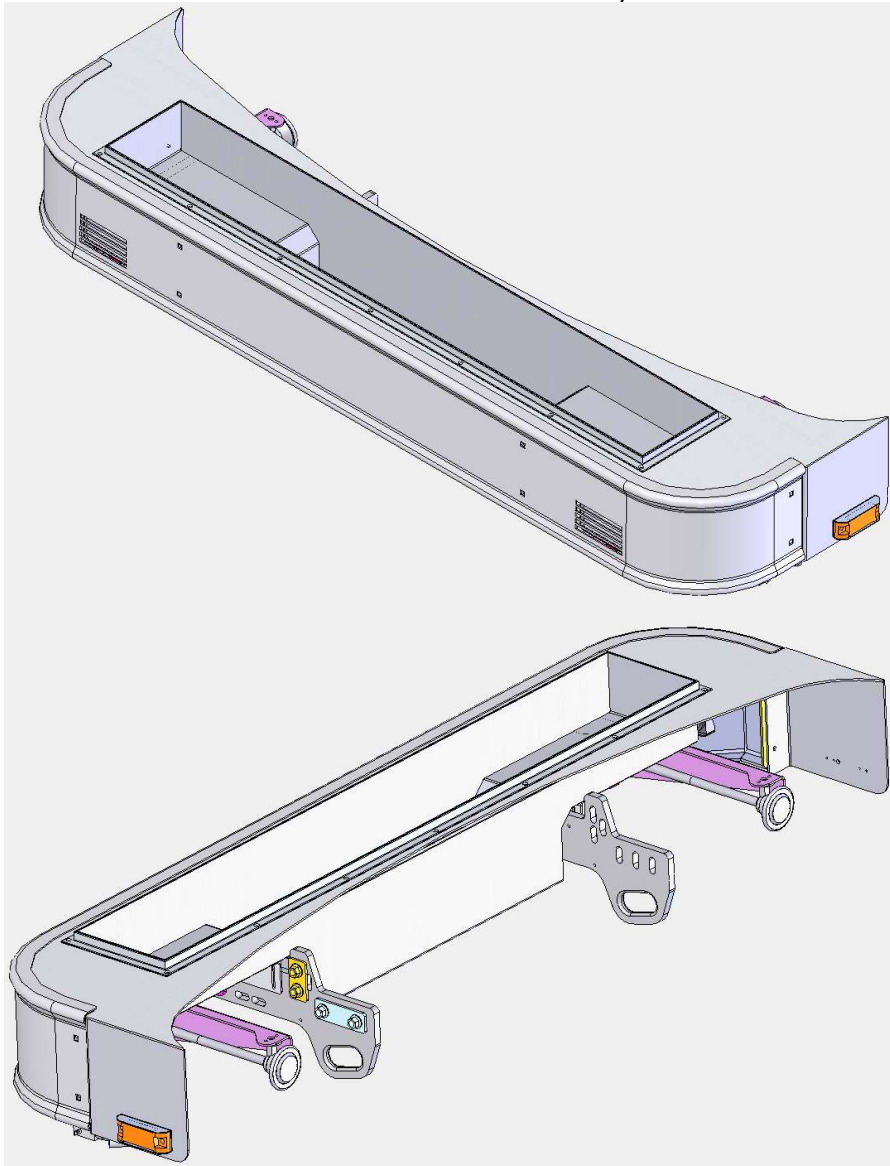



Front Bumpers (Option Group: 200)

18" Bumper Options:

18" Bumper, Stainless Steel Skin, Deep Center Trough, Rectangular Air Horns Outboard, ISL Perforations, Tow Eyes Below (ASSY Number: CHF-5765 – ISX & Painted Versions: TBD)

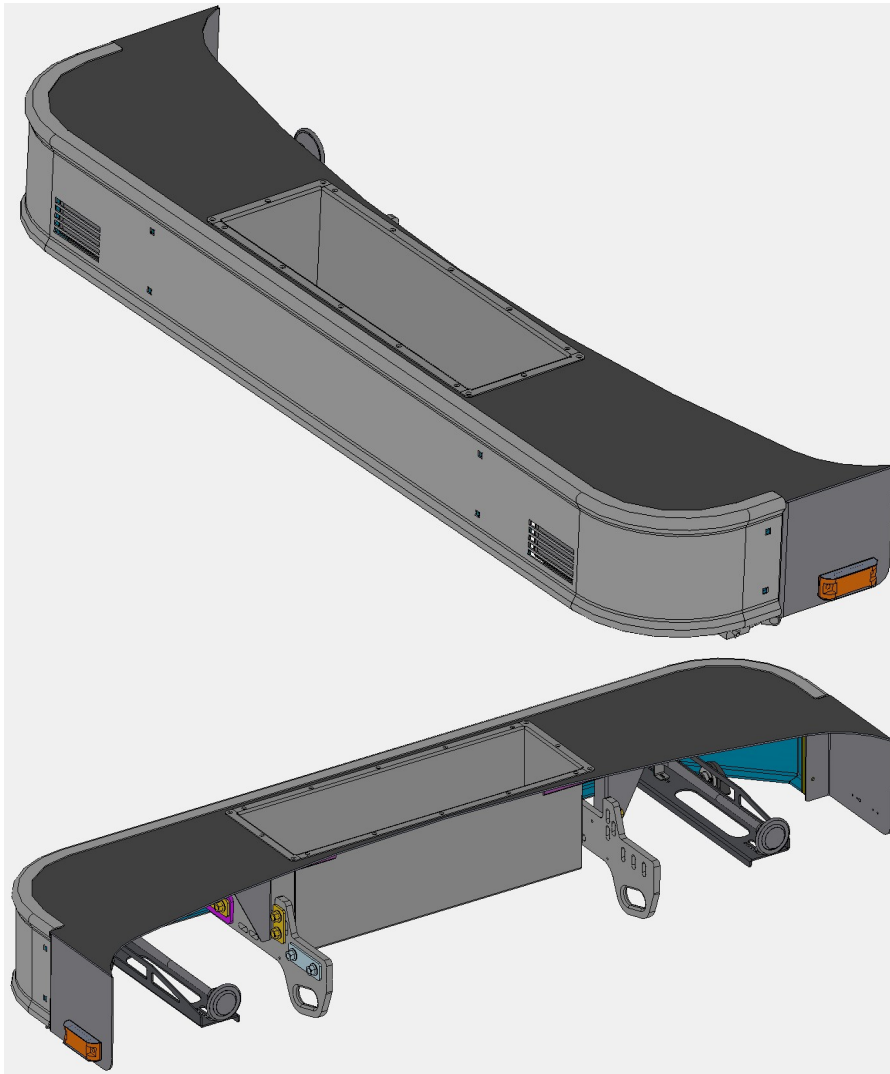



SUTPHEN CORPORATION

Front Bumpers (Option Group: 200)

18" Bumper Lid Options:

18" Bumper Trough Lid, 2" Rise, Diamondplate W/Knurled Stainless Steel Handle (ASSY Number: CHF-7604-100 – For Trough W/1" Lip: CHF-7591-100)



18" Bumper Trough Lid, 4" Rise, Diamondplate W/Knurled Stainless Steel Handle (ASSY Number: CHF-7915-100 – For Trough W/1" Lip: CHF-7642-100)





Front Bumpers (Option Group: 200)

18" Bumper Lid Options:

***18" Bumper Trough Lid, Center Only Trough, 2" Rise, Diamondplate
W/Knurled Stainless Steel Handle (ASSY Number: CHF-7749-100)***

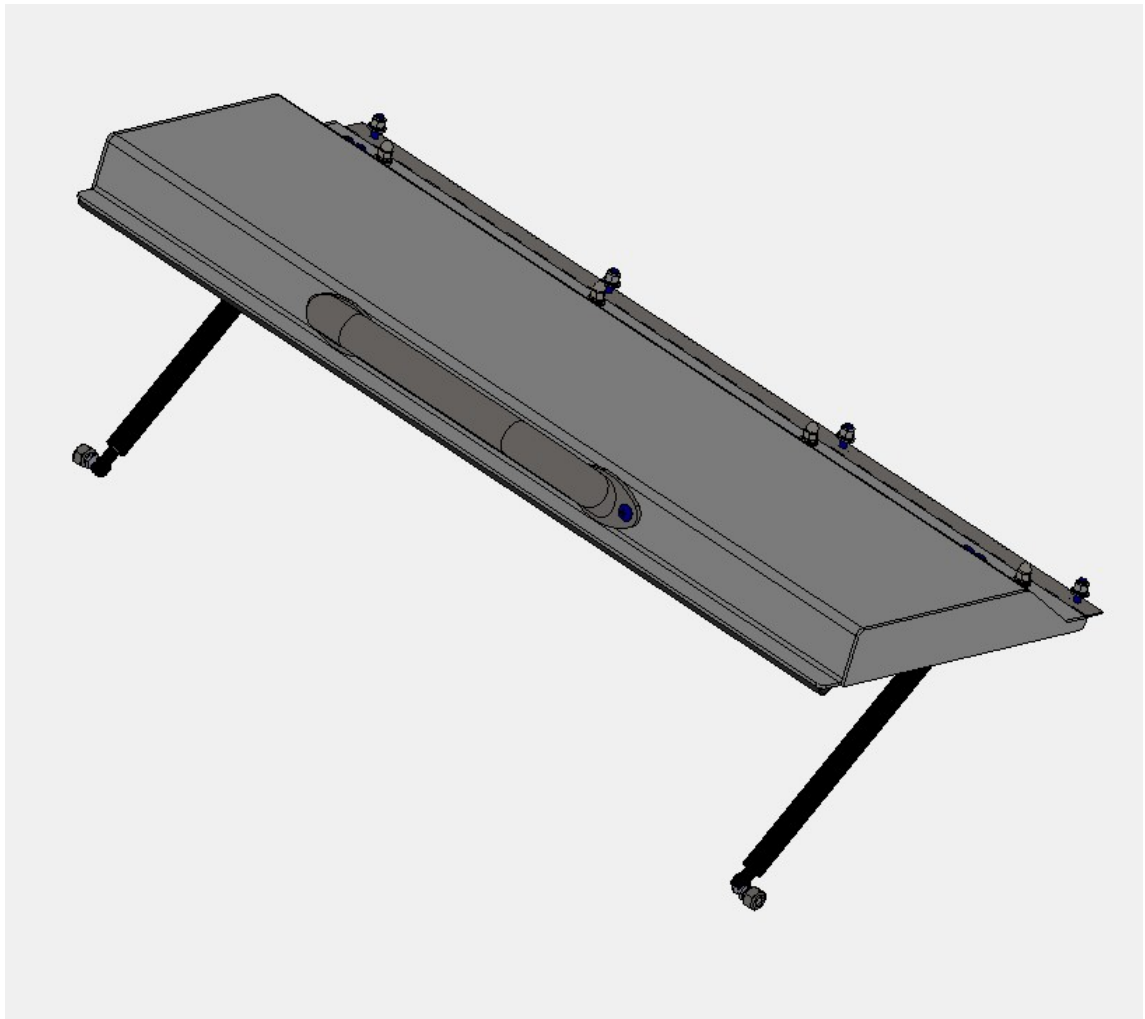



Front Bumpers (Option Group: 200)

24" Bumper Options:

24" Bumper, Stainless Steel Skin, No Trough, Rectangular Air Horns Inboard, ISL Perforations, Tow Eyes Below (ASSY Number: CHF-7354 – ISX & Painted Versions: TBD)

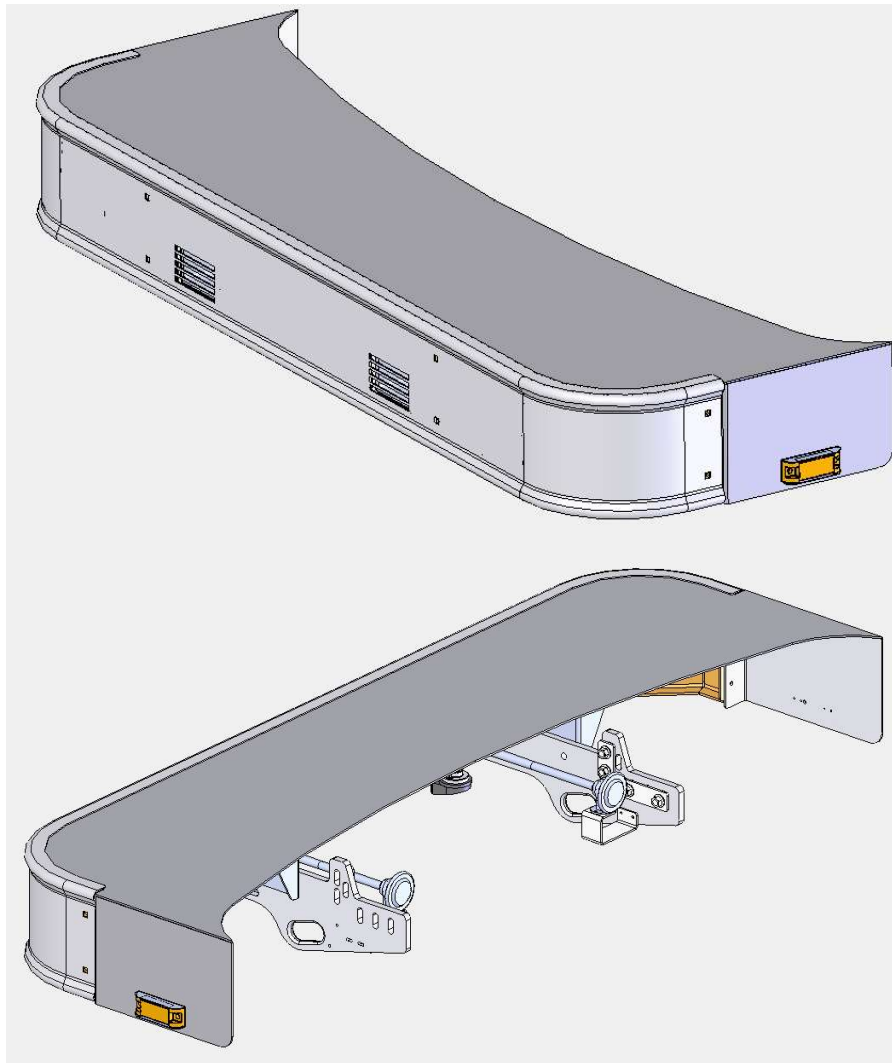



Front Bumpers (Option Group: 200)

24" Bumper Options:

24" Bumper, Stainless Steel Skin, Full Width/Shallow Trough, Rectangular Air Horns Inboard, ISL Perforations, Tow Eyes Below (ASSY Number: CHF-5734 – ISX & Painted Versions: TBD)

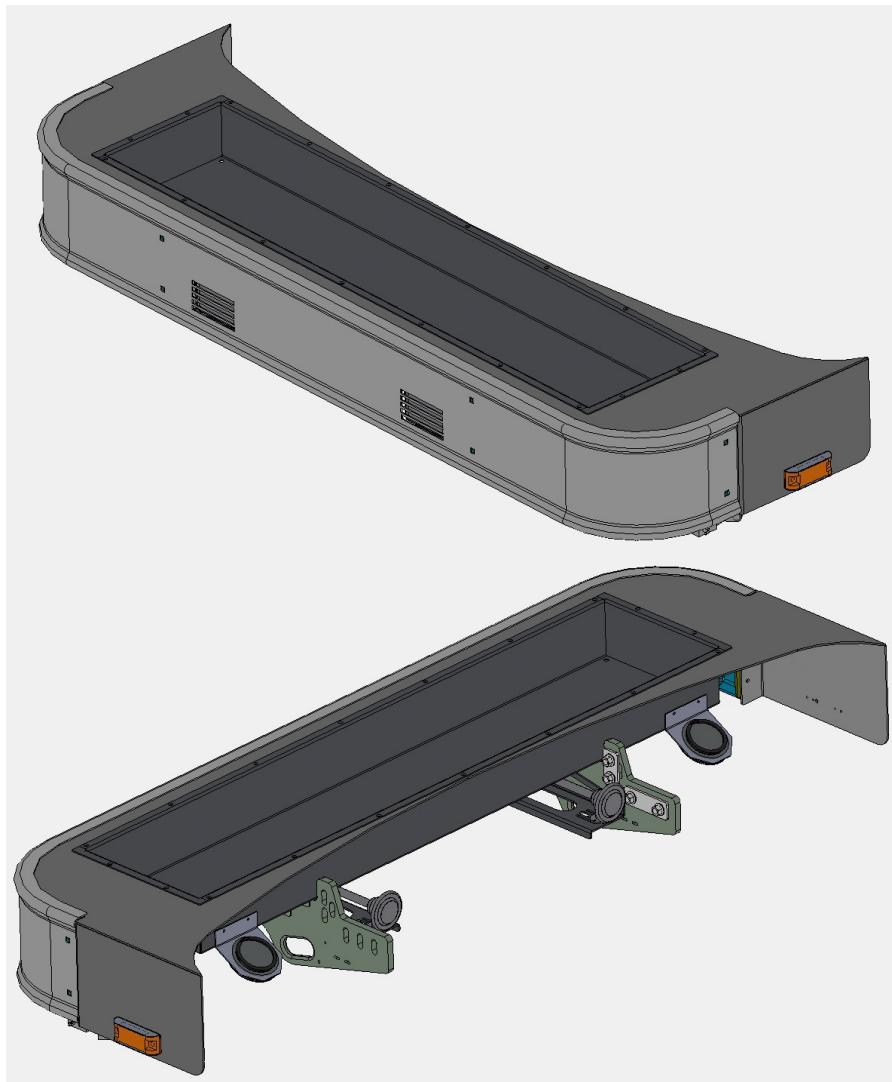



SUTPHEN CORPORATION

Front Bumpers (Option Group: 200)

24" Bumper Options:

24" Bumper, Stainless Steel Skin, Full Width/Deep Center Trough, Rectangular Air Horns Inboard, ISX Perforations, Tow Eyes Below (ASSY Number: CHF-6021 – ISL Version: CHF-6010)

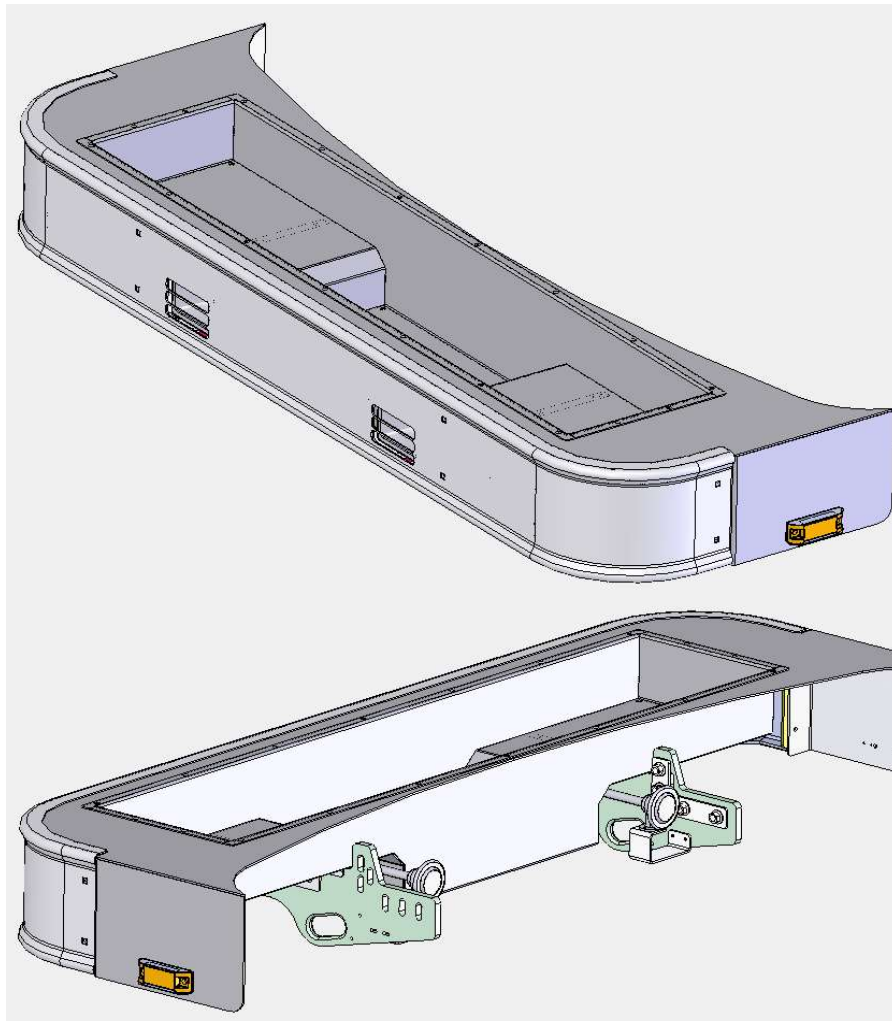



SUTPHEN CORPORATION

Front Bumpers (Option Group: 200)

24" Bumper Options:

24" Bumper, Painted Steel Skin, Full Width/Deep Center Trough, Rectangular Air Horns Inboard, ISX Perforations, Tow Eyes Below (ASSY Number: CHF-5753 – ISL Version: TBD)

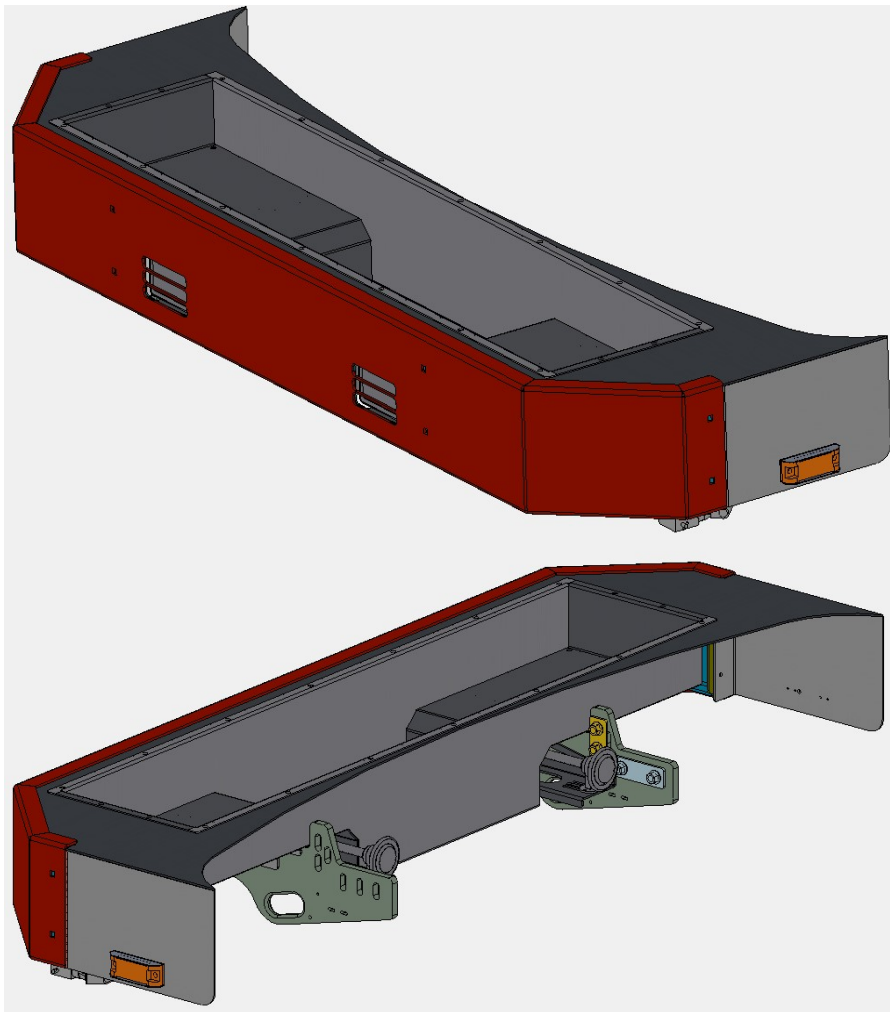



SUTPHEN CORPORATION

Front Bumpers (Option Group: 200)

24" Bumper Options:

24" Bumper, Stainless Steel Skin, Full Width/Deep Center Trough W/1" Lip, Rectangular Air Horns Inboard, ISL Perforations, Tow Eyes Below (ASSY Number: CHF-7009 – ISX & Painted Versions: TBD)

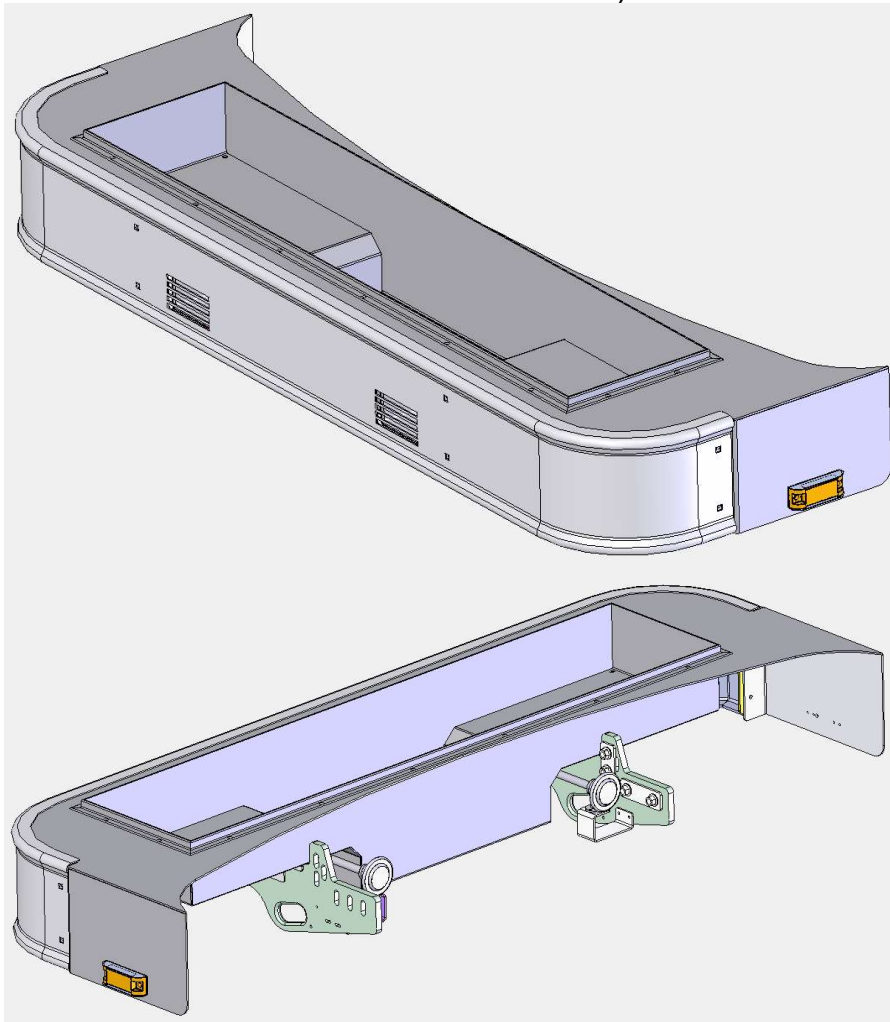



Front Bumpers (Option Group: 200)

24" Bumper Options:

24" Bumper, Stainless Steel Skin, Full Width/All Deep Compartments, Rectangular Air Horns Inboard, ISL Perforations, Tow Eyes Below (ASSY Number: CHF-6053 – ISX & Painted Versions: TBD)

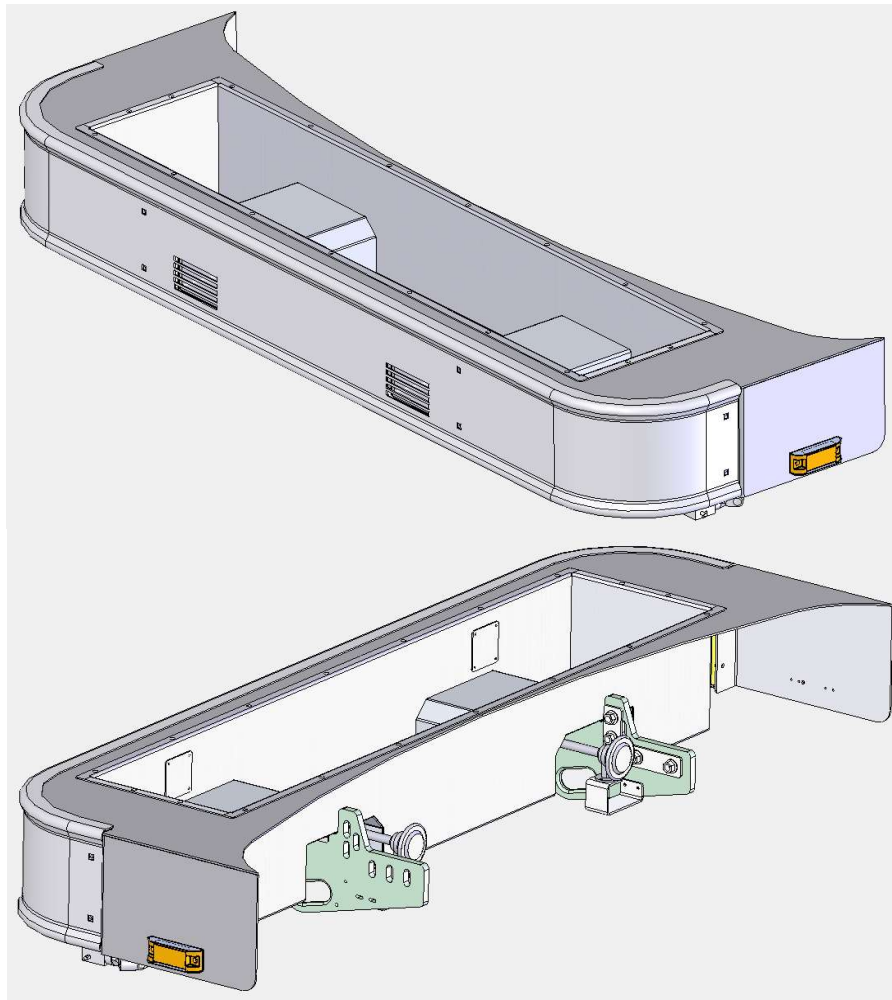



SUTPHEN CORPORATION

Front Bumpers (Option Group: 200)

24" Bumper Options (front suction options):

24" Bumper, Stainless Steel Skin, 3/4 Width/Deep Center Trough, Keyhole For Top Front Suction, Rectangular Air Horns Inboard, ISL Perforations, Tow Eyes Below (ASSY Number: CHF-5932 – ISX Version: CHF: 6068 - Painted Versions: TBD)

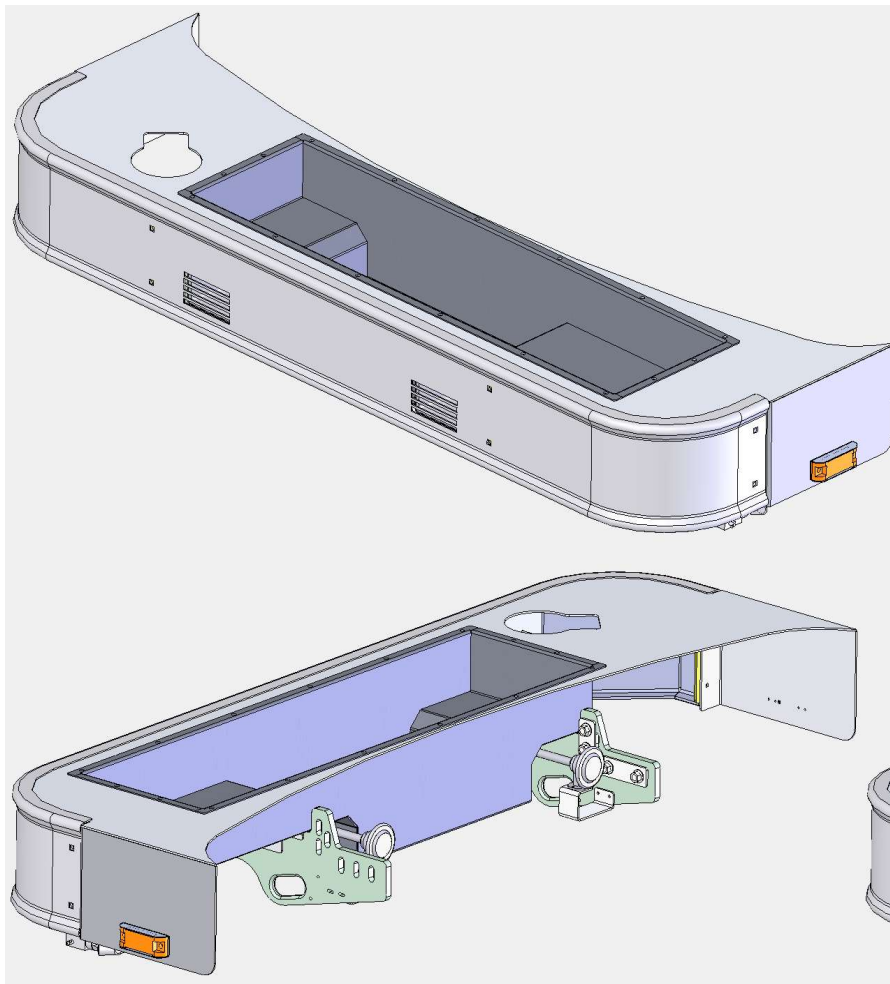



SUTPHEN CORPORATION

Front Bumpers (Option Group: 200)

24" Bumper Options (front suction options):

24" Bumper, Stainless Steel Skin, 3/4 Width/Deep Center Trough, Hole For Thru Front Suction, Rectangular Air Horns Inboard, ISL Perforations, Tow Eyes Below (ASSY Number: CHF-6046 – ISX Version & Painted Versions: TBD)

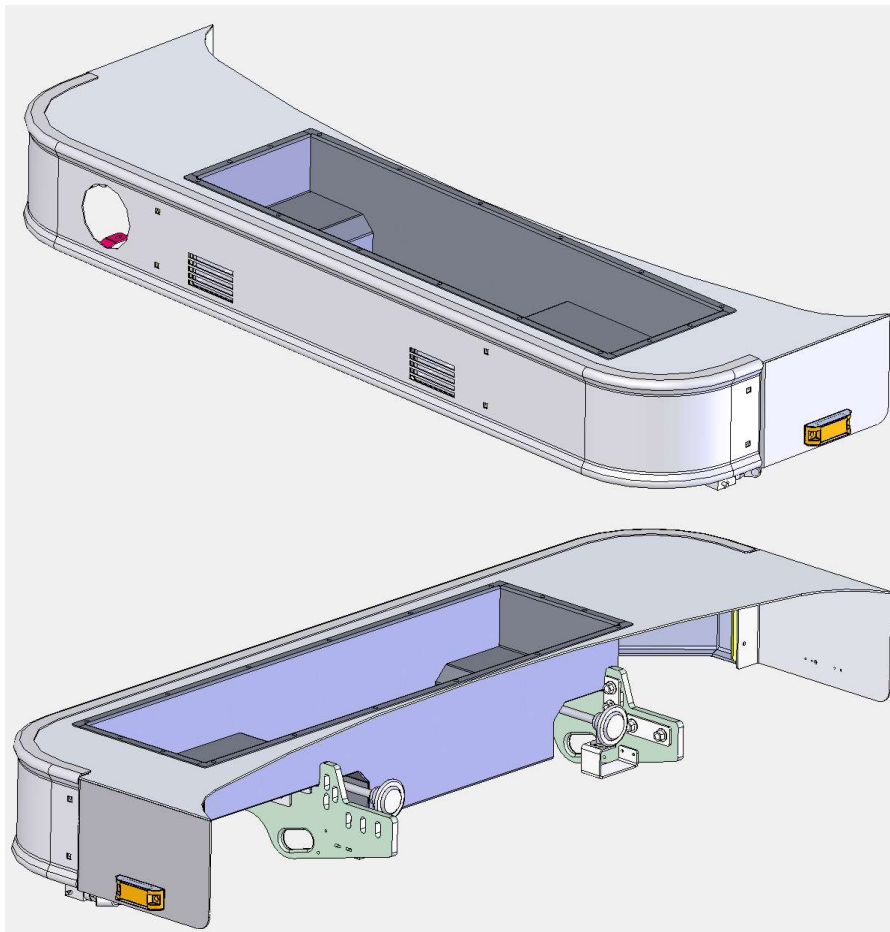



SUTPHEN CORPORATION

Front Bumpers (Option Group: 200)

24" Bumper Lid Options:

24" Bumper Trough Lid, 2" Rise, Diamondplate W/Knurled Stainless Steel Handle (ASSY Number: CHF-7460-100 – For Trough W/1" Lip: CHF-7563-100)

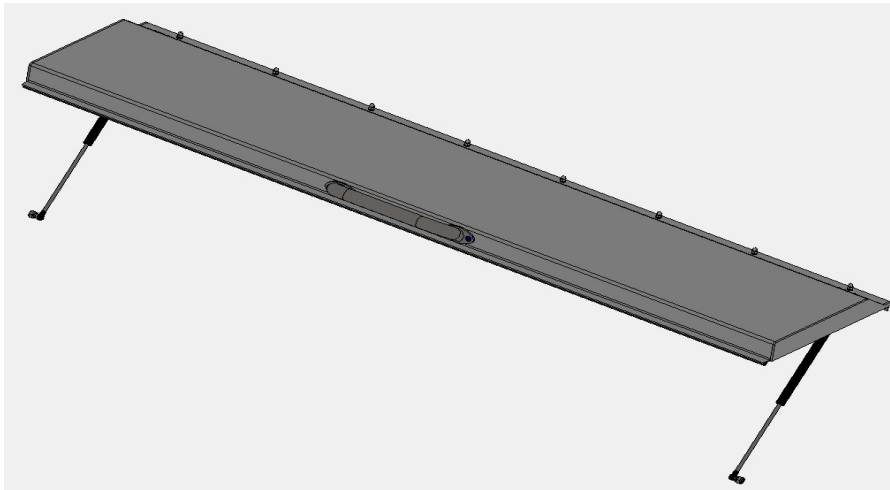

24" Bumper Trough Lid, 4" Rise, Diamondplate W/Knurled Stainless Steel Handle (ASSY Number: CHF-7505-100 – For Trough W/1" Lip: CHF-7715-100)

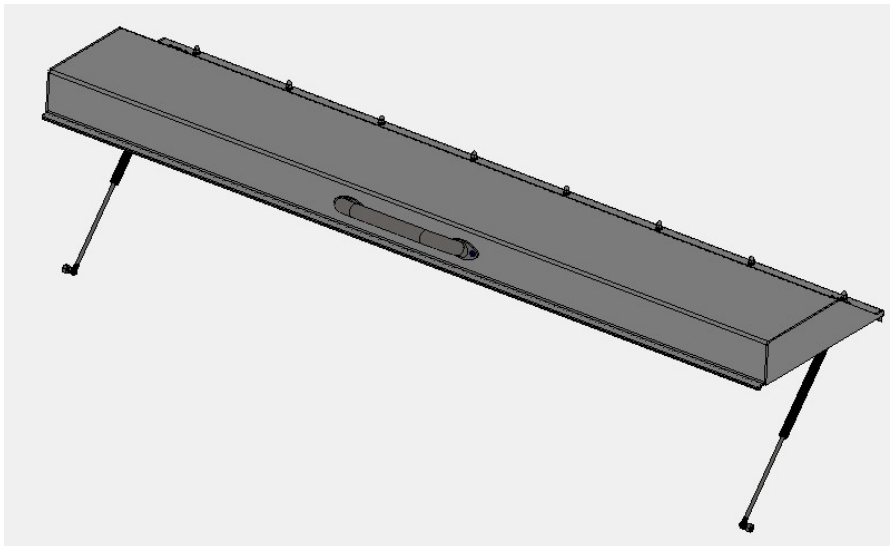



Front Bumpers (Option Group: 200)

24" Bumper Lid Options (For 3/4 troughs W/Front Suction):

24" Bumper Trough Lid, 3/4 Width For Front Suction, 2" Rise, Diamondplate W/Knurled Stainless Steel Handle (ASSY Number: CHF-7607-100 – For Trough W/1" Lip: TBD)

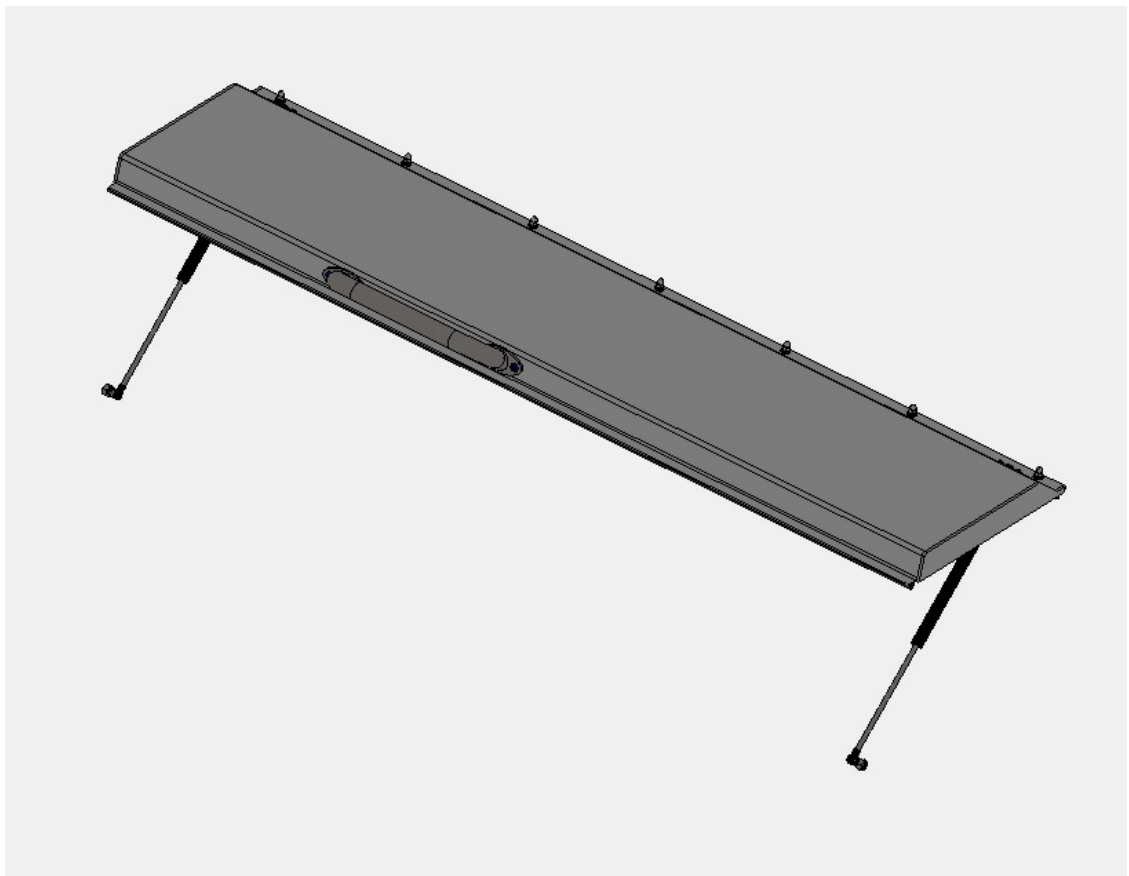



SUTPHEN CORPORATION

Drivelines (Option Group: 220)

DRIVELINE OPTION	DRIVELINE DESCRIPTION	APPLICABLE ENGINE
22010000	DRIVE LINE, SPICER, 1710 SERIES	L9
22010001	DRIVE LINE, SPICER, 1710 SERIES (Tandem)	L9
22010050	DRIVE LINE, SPICER, 1810 SERIES	X12 (optional for L9)
22010100	DRIVE LINE, SPICER, 1810 SERIES (Tandem)	X12 (optional for L9)
22010200	DRIVE LINE, SPICER, SPL250	X15 (optional for X12)
22010250	DRIVE LINE, SPICER, SPL250 (Tandem)	X15 (optional for X12)

Driveshaft length vs. RPM's:

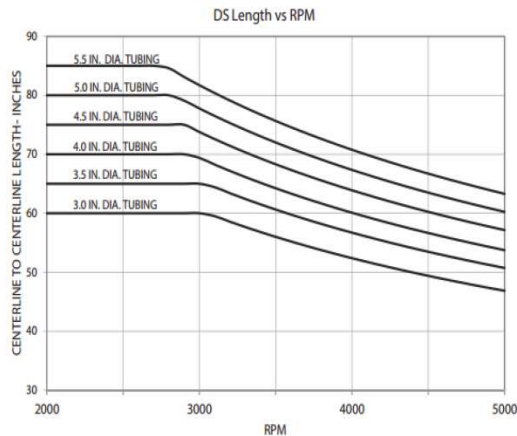

LENGTH	4.095" DIA		4.590" DIA	
	1/2 CS	SAFE RPM	1/2 CS	SAFE RPM
60	3,695	4,153	4,161	4,677
62	3,460	3,890	3,897	4,380
64	3,248	3,650	3,657	4,111
66	3,054	3,432	3,439	3,865
68	2,877	3,233	3,240	3,641
70	2,715	3,051	3,057	3,436
72	N/A	N/A	2,890	3,248
74	N/A	N/A	2,736	3,075

1/2 CS - 1/2 Critical Speed (RPM's). The point where tubing length will cause a vibration that cannot be balanced

SAFE RPM - Refers to the RPM that once exceeded can cause critical failure

U-joint life per coupling angle:

Joint Life vs. Joint Angle

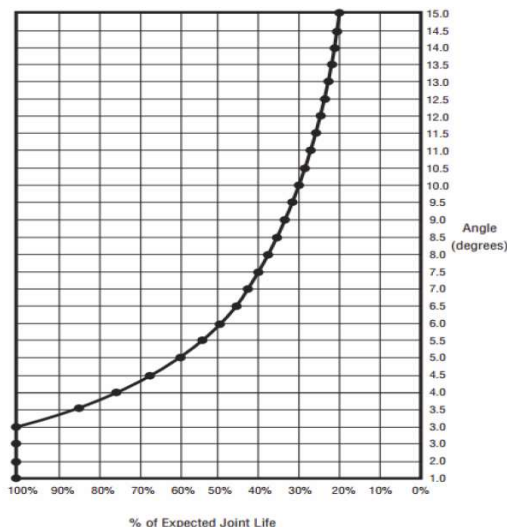

The operating angles of each end of the shaft should be within 1° of each other and ideally have a max 3° operating angle for each coupling. I have seen the max for 3500 RPM reach as high as 5° 50' is some literature. Up to that point It is mainly a discussion of u-joint life.

- Cross and caps must be free of debris.
- Grease must be applied until it purges all 4 caps.
- Inspect the grease for discoloration
- Inspect the cross for signs of wear
- Straps should not be reused on a reinstall.



SUTPHEN CORPORATION

Engine Enclosure (Option Group: 225)

ENCLOSURE OPTION	ENGINE ENCLOSURE DESCRIPTION	APPLICABLE ENGINE
22510100	ENGINE ENCLOSURE, FULL SIZE	L9, X12
22510102	ENGINE ENCLOSURE, FULL SIZE, WELDED ALUM	L9, X12, X15
22510110	ENGINE ENCLOSURE, SMALL PROFILE	L9 ONLY
22510112	ENGINE ENCLOSURE, SMALL PROFILE, WELDED ALUMINUM	L9 ONLY

Full size engine enclosure/tunnel:



Small profile engine enclosure/tunnel (8" notch for additional leg room in crew cab):



COVERING OPTION	COVERING DESCRIPTION
22510530	ENGINE ENCLOSURE COVERING, SCORPION BLACK URETHANE BLEND
22510531	ENGINE ENCLOSURE COVERING, SCORPION GRAY URETHANE BLEND
22510532	ENGINE ENCLOSURE COVERING, SCORPION BLACK URETHANE BLEND (G)
22510533	ENGINE ENCLOSURE COVERING, SCORPION GRAY URETHANE BLEND (G)



SUTPHEN CORPORATION

Engine Options (Option Group: 230)

<u>ENGINE OPTION</u>	<u>ENGINE DESCRIPTION</u>	<u>CORRESPONDING TRANSMISSION</u>
23014110	ENGINE, CUMMINS L 9 380HP DOC-DPF-DEF-SCR OBD	EVS3000 SERIES
23014120	ENGINE, CUMMINS L 9 400HP DOC-DPF-DEF-SCR OBD	EVS3000 SERIES
23014130	ENGINE, CUMMINS L 9 450HP DOC-DPF-DEF-SCR OBD	EVS3000 SERIES
23014220	ENGINE, CUMMINS X 12 455HP DOC-DPF-DEF-SCR OBD	EVS4000 SERIES
23014230	ENGINE, CUMMINS X 12 500HP DOC-DPF-DEF-SCR OBD	EVS4000 SERIES
23014310	ENGINE, CUMMINS X 15 600HP DOC-DPF-DEF-SCR OBD	EVS4000 SERIES

Available engine warranties, per engine:

<u>WARRANTY OPTION</u>	<u>WARRANTY DESCRIPTION</u>
23029100	ENGINE WARRANTY, 5 YEAR, 100,000 MILES FOR CUMMINS L9
23029105	ENGINE WARRANTY, 6 YEAR, 100,000 MILES FOR CUMMINS L9
23029110	ENGINE WARRANTY, 7 YEAR, 100,000 MILES FOR CUMMINS L9
23029115	ENGINE WARRANTY, 8 YEAR, 100,000 MILES FOR CUMMINS L9
23029120	ENGINE WARRANTY, 10 YEAR, 200,000 MILES FOR CUMMINS L9 MAJOR COMPONENTS COVERAGE (FCM)
23029200	ENGINE WARRANTY, 5 YEAR, 100,000 MILES FOR CUMMINS X12 / X15
23029205	ENGINE WARRANTY, 6 YEAR, 100,000 MILES FOR CUMMINS X12 / X15
23029210	ENGINE WARRANTY, 7 YEAR, 100,000 MILES FOR CUMMINS X12 / X15
23029215	ENGINE WARRANTY, 8 YEAR, 100,000 MILES FOR CUMMINS X12 / X15
23029220	ENGINE WARRANTY, 10 YEAR, 200,000 MILES FOR CUMMINS X12 / X15 MAJOR COMPONENTS COVERAGE (FCM)



Frame Options (Option Group: 250)

FRAME OPTION	FRAME DESCRIPTION
25010000	FRAME, 10" SINGLE RAILS, SINGLE AXLE (50K PSI)
25010100	FRAME, 10" DOUBLE RAILS, SINGLE AXLE (50K PSI)
25010115	FRAME, 10" DOUBLE RAILS, DOMEX, TANDEM AXLE (110K PSI)
25010250	FRAME, 10" SINGLE RAILS, DOMEX, SINGLE AXLE (110K PSI)
25010255	FRAME, 10" DOUBLE RAILS, DOMEX, SINGLE AXLE (110K PSI)
25020120	FRAME, 10" DOUBLE RAILS, DOMEX, TANDEM AXLE - AERIAL (110K PSI)

- Trucks with wheelbases 200" and over will require double rails
- All Aerial & Industrial Products will require Domex rails



SUTPHEN CORPORATION

Fuel Cell/Fill Options (Option Group: 260)

FUEL TANK OPTION	FUEL TANK DESCRIPTION
26010000	FUEL TANK, STEEL, 65 GALLON
26010010	FUEL TANK, STAINLESS STEEL, 65 GAL
26020100	FUEL BEAM, 65 GALLON (AERIALS)
26028888	FUEL TANK, STAINLESS STEEL, 100 GAL

- **FMCSA Certified fuel tanks**
- **Fuel system – tank, hoses, and fittings capable of accommodating Biodiesel fuel up to B20**
- **All fuel tanks are coated with Corsol Corrosion Solution**
 - <http://www.prpindustries.com/news/166-corsol-outperforms-both-powder-coating-and-galvanizing-in-ford-proving-ground-testing>



FUEL FILL OPTION	FUEL FILL DESCRIPTION
26030000	FUEL FILL
26030050	DUAL FUEL FILL (FUEL TANK)
26030055	DUAL FUEL FILL (FUEL BEAM)

- **The fuel fill position is located on the Driver's side as standard. Dual position options are available for Customers who requests dual fuel fill necks, or the fuel fill neck on the Officer's side**
- **Fiber reinforced plastic (FRP) fuel disconnect**





SUTPHEN CORPORATION

Cab Exterior Handrail Options (Option Group: 270)

HANDRAIL OPTION	HANDRAIL DESCRIPTION
27022000	HANDRAILS, CAB, KNURLED STAINLESS STEEL
27030007	HANDRAILS, REAR CAB INTERIOR DOOR WINDOW KNURLED STS
27030500	SCUFF PLATE BEHIND HANDRAILS, MIRRORED STS
27030600	COAT HOOKS FOR GRAB HANDRAILS (4)
27030605	COAT HOOKS FOR GRAB HANDRAILS (2)
27030710	HANDRAILS, FRONT OF CAB, KNURLED STAINLESS STEEL (PAIR)
27030725	SCUFF PLATES, STAINLESS STEEL, BEHIND HANDRAILS (FRONT OF CAB)

Exterior stainless handrails, behind cab doors:



Exterior stainless handrails w/coat hooks:

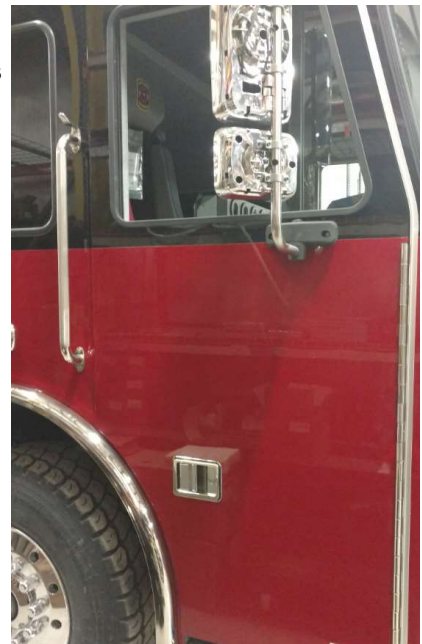

Handrails, front of cab (Sutphen Headlight Housings):



Handrails, front of cab (Guardian Headlight Housings):





SUTPHEN CORPORATION

Cab Heating & Air Conditioning (Option Group: 280)

HVAC OPTION	OPTION DESCRIPTION	AC COMPRESSOR ON ENGINE
28010050	DEFROSTER ONLY	NO AC COMPRESSOR
28010710	DEFROSTER & HEATER (NO A/C)	NO AC COMPRESSOR
28010740	DEFROSTER, HEATER & A/C (COMPACT)	TM21 AC COMPRESSOR
28010750	DEFROSTER, HEATER & A/C-SEVERE CLIM (COMPACT)	TM31 AC COMPRESSOR

2018 Standard, raised defroster (the bottom of the defroster is above windshields, to provide optimal view for the Driver):



Heat or heat/AC, as shown on engine tunnel hood:

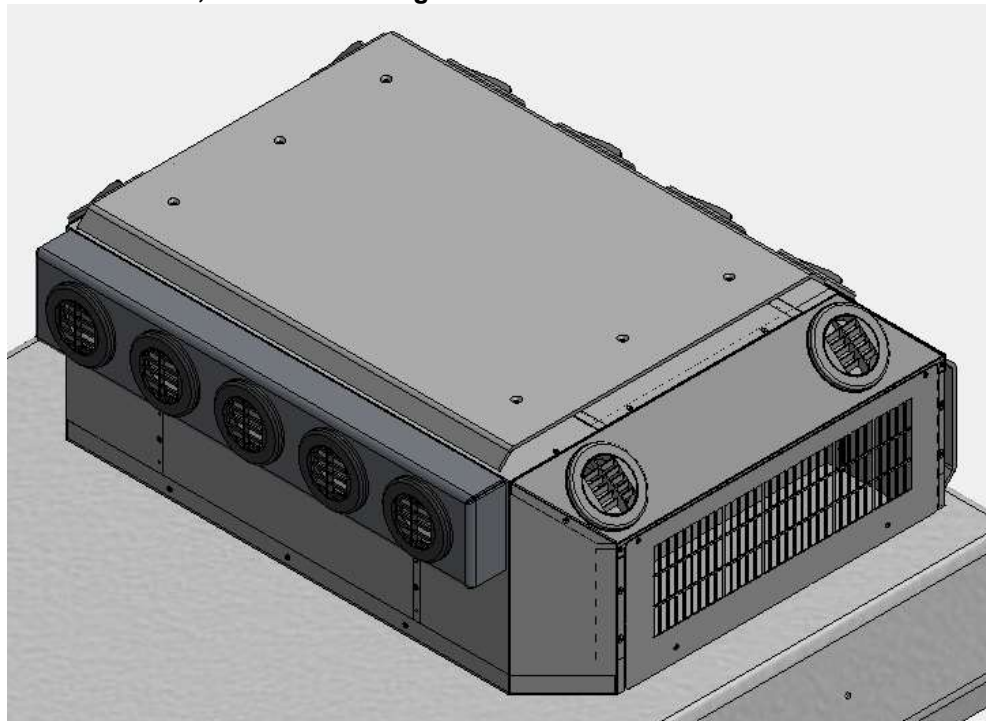



SUTPHEN CORPORATION

Cab Heating & Air Conditioning (Option Group: 280)

<u>ADDITIONAL OPTIONS</u>	<u>OPTION DESCRIPTION</u>
28030000	METAL VENT COVERS FOR DEFROSTER/AC
28030500	DEFROSTER DUCTWORK, ENTIRE WINDSHIELD
28031000	FAN, 12 VOLT, DRIVER'S SIDE
28031100	FAN, 12 VOLT, OFFICER'S SIDE
28090003	HEAT TO FEET

Heavy Duty plastic, adjustable heat/AC vents



Defroster ductwork (diffuser):



Metal (fixed, non-adjustable) heat/AC vents:



Defroster fans:



Heat to feet:

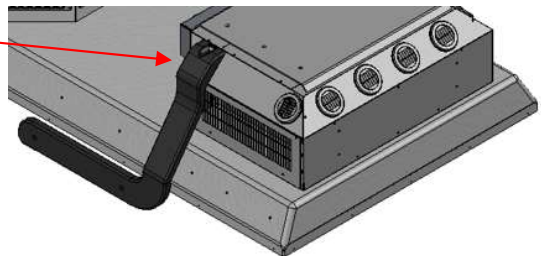
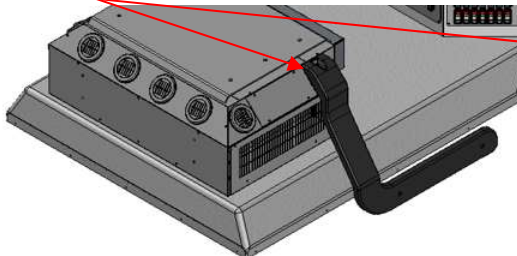



SUTPHEN CORPORATION

RVAC Options (Option Group: 280)

HVAC OPTION	OPTION DESCRIPTION
28032000	RV AIR CONDITIONER 15,000 BTU
28032010	DEFLECTOR, FORWARD OF RV AC, TREADPLATE
28032015	DEFLECTOR, FORWARD OF RV AC, PAINTED
28032020	DEFLECTOR, PAINTED, FORWARD AND SIDES OF RV AC

RVAC controls in crew cab:



RVAC with Treadplate Deflector:



Painted and full-wrap deflectors are also available options:

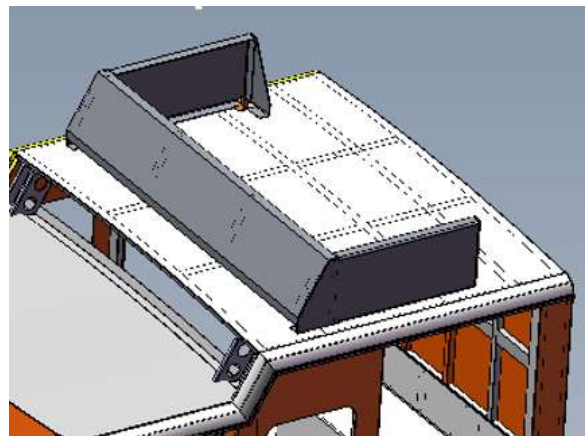



SUTPHEN CORPORATION

Load Managers (Option Group: 299)

OPTION	OPTION DESCRIPTION
29910000	LOAD MANAGER, CLASS-1
29910100	PROGRAMMABLE LOAD MANAGER, CLASS-1 SUPERNODE II

New 2017 Sutphen Programmable Load Manager

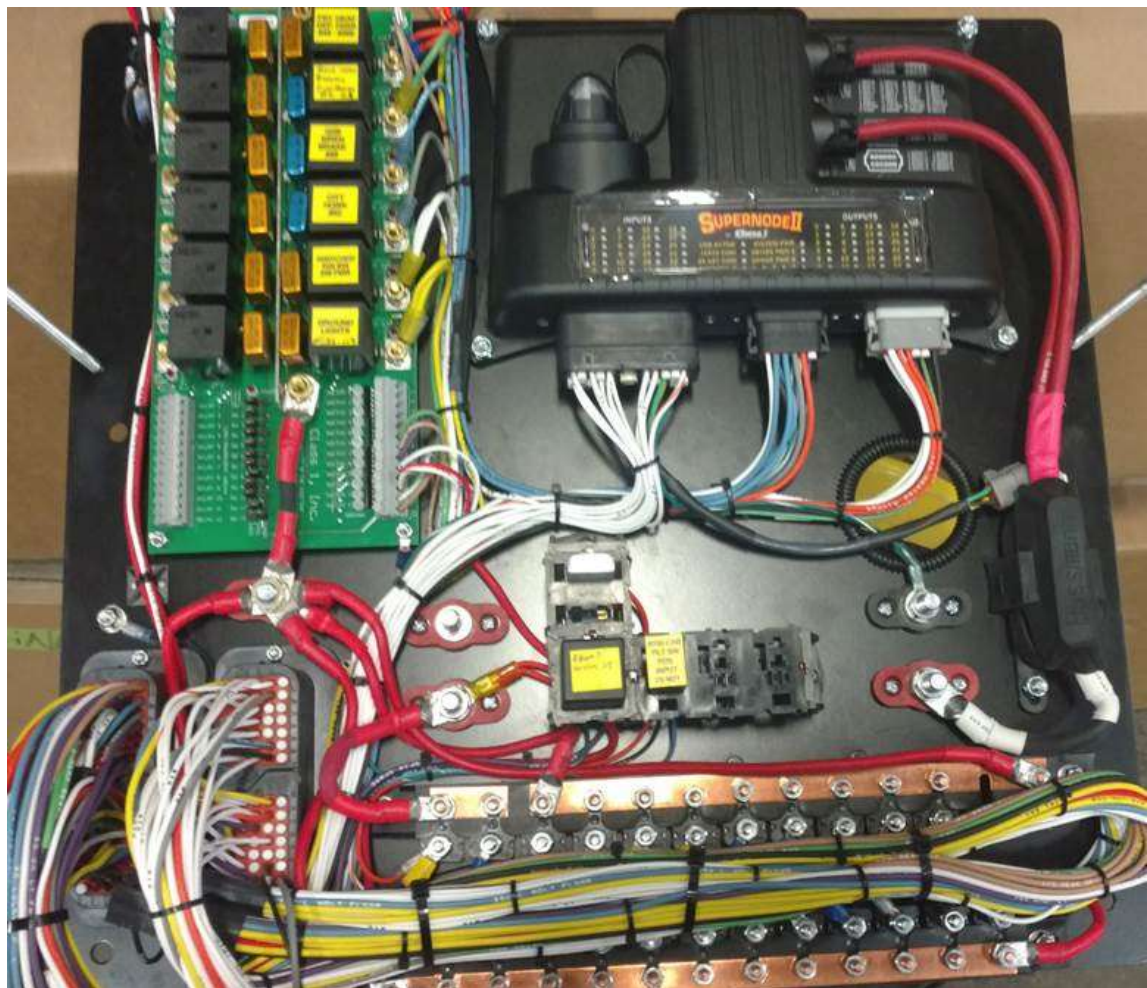



SUTPHEN CORPORATION

Instrumentation (Option Group: 300)

OPTION	OPTION DESCRIPTION
30010120	INSTRUMENTATION, BEEDE GAUGES W/ CENTER & OVERHEAD CONSOLES
30010125	INSTRUMENTATION, BEEDE GAUGES W/ CENTER & OVERHEAD CONSOLES (AERIALS)
30010220	INSTRUMENTATION, BEEDE GAUGES, FOR MULTIPLEX W/CENTER & OVERHEAD CONSOLE
30010225	INSTRUMENTATION, BEEDE GAUGES, FOR MULTIPLEX W/CENTER & OVERHEAD CONSOLE (AERIALS)

2017 Dash, constructed of thermoformed ABS 750 (color/finish to match engine enclosure-hood):





SUTPHEN CORPORATION

Command Consoles (Option Group: 300)

OPTION	OPTION DESCRIPTION
30010120	INSTRUMENTATION, BEEDE GAUGES W/ CENTER & OVERHEAD CONSOLES
30010125	INSTRUMENTATION, BEEDE GAUGES W/ CENTER & OVERHEAD CONSOLES (AERIALS)
30010220	INSTRUMENTATION, BEEDE GAUGES, FOR MULTIPLEX W/CENTER & OVERHEAD CONSOLE
30010225	INSTRUMENTATION, BEEDE GAUGES, FOR MULTIPLEX W/CENTER & OVERHEAD CONSOLE (AERIALS)

Upper Command Console:

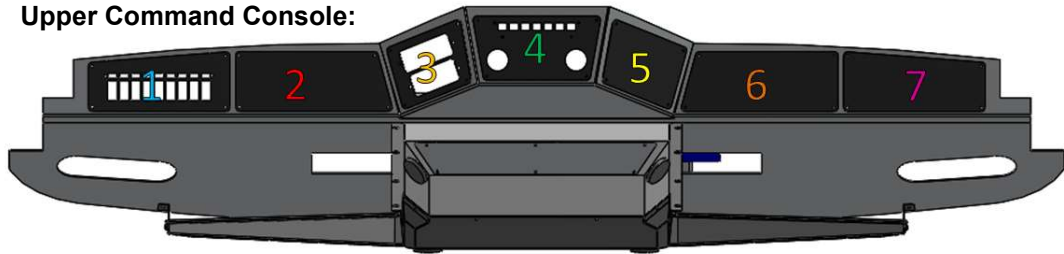

Lower Command Console
(9L & 12L engines):

Mirror controls:

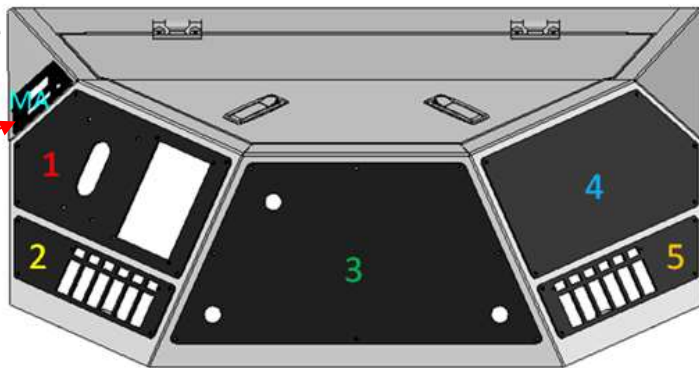

Lower Command Console (15L engine):

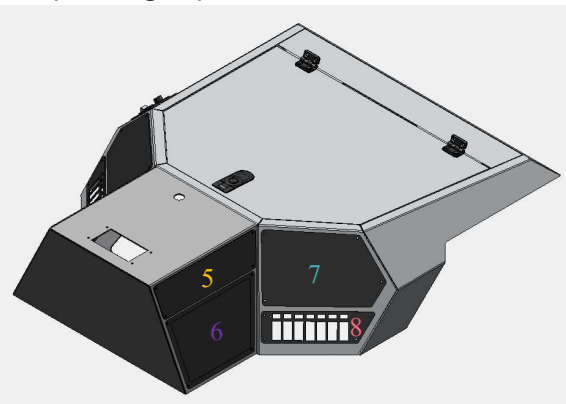
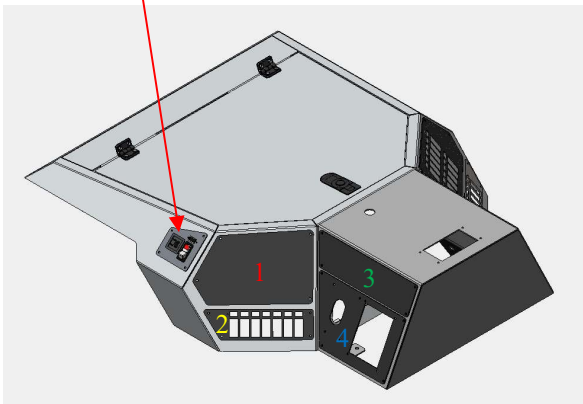



SUTPHEN CORPORATION

Additional Options for Command Consoles (Option Group: 300)

OPTION	OPTION DESCRIPTION
30010700	CAB PUMP SHIFT
30030050	AMMETER
30030100	OFFICER'S SIDE SPEEDOMETER
30030200	CAB LOCKDOWN INDICATOR LIGHT, IN CAB
30030800	TRANSMISSION OIL PRESSURE GAUGE ON DASH
30031100	HIGH IDLE SWITCH
30031300	METRIC GAUGES ON DASH
30031600	ECCO 6220 DOOR AJAR STROBE IN CAB

Officer's side speedometer:

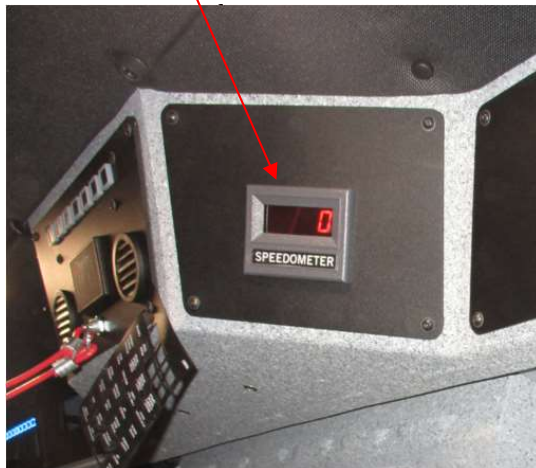

Cab pump shift:



High idle switch:

Ammeter, ECCO strobe light in cab:

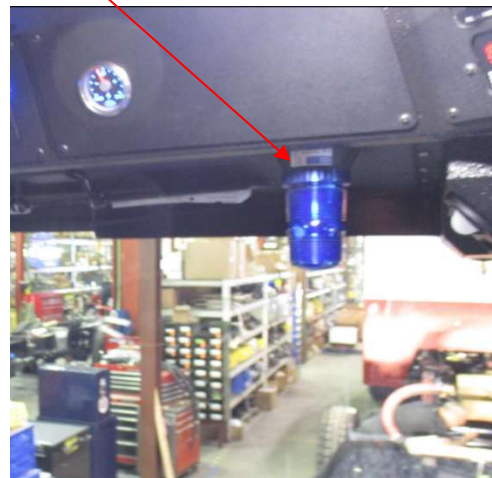



SUTPHEN CORPORATION

Cab Interior Options (Option Group: 310)

INTERIOR OPTION	INTERIOR DESCRIPTION
31010285	INTERIOR, MULTISPEC BLACK SPECKLE PAINT W/GRAY-BLACK DURAWEAR
31010286	INTERIOR, SCORPION BLACK URETHANE BLEND W/GRAY-BLACK DURAWEAR
31010287	INTERIOR, MULTISPEC GRAY SPECKLE PAINT W/GRAY-BLACK DURAWEAR
31010288	INTERIOR, SCORPION GRAY URETHANE BLEND W/GRAY-BLACK DURAWEAR
31010290	CAB INTERIOR FLOOR COVERING, GRAY RUBBERIZED
31010291	CAB INTERIOR FLOOR COVERING, BLACK RUBBERIZED

Gray Multispec interior/gray Scorpion hood/gray carpet:



Black Multispec interior/black Scorpion hood/black carpet:





SUTPHEN CORPORATION

Headlights Options (Option Group: 325)

HEADLIGHTS OPTION	HEADLIGHTS DESCRIPTION
32510000	HEADLIGHTS, HALOGEN, DUAL STS HOUSINGS
32520510	HEADLIGHTS, LED, J.W. SPEAKER 8800, DUAL STS HOUSINGS
32520520	HEADLIGHTS, LED, FIRETECH FT-4X6, DUAL STS HOUSINGS
32520600	HEADLIGHTS, HALOGEN, COMBO STS HOUSINGS
32520610	HEADLIGHTS, LED, J.W. SPEAKER 8800, STS COMBO HOUSINGS
32520620	HEADLIGHTS, LED, FIRETECH FT-4X6, STS COMBO HOUSINGS
32520650	HEADLIGHTS, HALOGEN, SINGLE STS HOUSING
32520660	HEADLIGHTS, LED, J.W. SPEAKER 8800, SINGLE STS HOUSINGS

Headlights w/dual stainless housings:



Headlights w/single stainless housings:



Headlights w/combo housings:





SUTPHEN CORPORATION

Cab Interior Light Options (Option Groups: 335 & 340)

INTERIOR LIGHT OPTIONS	INTERIOR LIGHT DESCRIPTIONS
33510030	INTERIOR CAB LIGHTS, RED/CLEAR LED (2)
33510035	INTERIOR CAB LIGHTS, RED/CLEAR LED (3)
33510040	INTERIOR CAB LIGHTS, RED/CLEAR LED (4)
33530652	INTERIOR CAB DOOR WARNING LIGHTS, WHELEN 500 TIR6 LED, 50*03Z*R (QTY 4)
33530654	INTERIOR CAB DOOR WARNING LIGHTS, WHELEN ION T-SERIES LED, TLI* (QTY 4)
33530660	INTERIOR CAB DOOR WARNING LIGHTS, CODE 3 MEGA THIN LED, ULT6-* (QTY 4)
33530662	INTERIOR CAB DOOR WARNING LIGHTS, CODE 3 MR6 LED, MR6FM-* (QTY 4)
33530670	INTERIOR CAB DOOR WARNING LIGHTS, FEDERAL SIGNAL IMPAXX6 LED, IPX600B-* (QTY 4)
33530672	INTERIOR CAB DOOR WARNING LIGHTS, FEDERAL SIGNAL MICROPULSE ULTRA 6 LED, MPS600U-** (QTY 4)
33530674	INTERIOR CAB DOOR WARNING LIGHTS, FEDERAL SIGNAL MICROPULSE WIDE ANGLE LED, MPSW9-* (QTY 4)
33530720	MAP LIGHT, SUNNEX, HALOGEN (1)
33530721	MAP LIGHTS, SUNNEX, HALOGEN (2)
33530722	MAP LIGHT, SUNNEX, LED (1)
33530723	MAP LIGHTS, SUNNEX, LED (2)
34010030	INTERIOR CREW LIGHTS, RED/CLEAR LED (2)
34010035	INTERIOR CREW LIGHTS, RED/CLEAR LED (3)
34010040	INTERIOR CREW LIGHTS, RED/CLEAR LED (4)

Cab interior lighting (2):



Crew Cab interior lighting (3):



Sunnex map light:

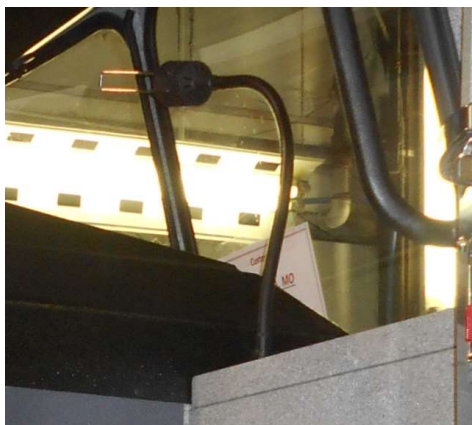

Cab interior door lighting:





SUTPHEN CORPORATION

Cab Mirror Options (Option Group: 380)

<u>MIRROR OPTION</u>	<u>MIRROR DESCRIPTION</u>
38010015	MIRRORS LANG MEKRA 300 SERIES REMOTE
38010020	MIRRORS LANG MEKRA 300 SERIES HEATED & REMOTE
38010120	MIRRORS VELVAC 2030 BUS STYLE HEATED & REMOTE
38010215	MIRRORS, RAMCO HEATED & REMOTE RGT COWL MNT LFT DOOR MNT
38010218	MIRRORS, RAMCO HEATED & REMOTE COWL MOUNT LEFT & RIGHT
38030205	BLIND SPOT MIRROR, VELVAC, ON CAB ROOF

Lang Mekra Mirrors:



Velvac Mirrors:



Ramco Mirrors (cowl mount):



Velvac Blind Spot Mirror:





SUTPHEN CORPORATION

Driver's Cab Seating (Option Group: 385)

Driver's Seat Options:

OPTION	OPTION DESCRIPTION
38510075	DRIVER'S SEAT, BOSTROM, NAVIGATOR AIR-50RX/D AIR RIDE (DURAWEAR PLUS, LOW SEAM)
38510110	DRIVER'S SEAT, BOSTROM TANKER 450 AIR RIDE SCBA (DURAWEAR)
38510195	DRIVER'S SEAT, BOSTROM SIERRA ELECTRIC (DURAWEAR)
38510255	DRIVER'S SEAT, BOSTROM TANKER 550 AIR RIDE SCBA (DURAWEAR PLUS, LOW SEAM)
38510400	DRIVER'S SEAT, USSC VALOR, AIR RIDE, ABTS
38510405	DRIVER'S SEAT, USSC VALOR, ELECTRIC, ABTS
38510510	DRIVER'S SEAT, SEATS INC 911 BATTALION, AIR RIDE ABTS
38510515	DRIVER'S SEAT, SEATS INC 911 BATTALION, ELECTRIC ABTS

2018 Bostrom Navigator Air Ride Driver's Seat (non-ABTS)

Adjustable height to accommodate various sized Drivers

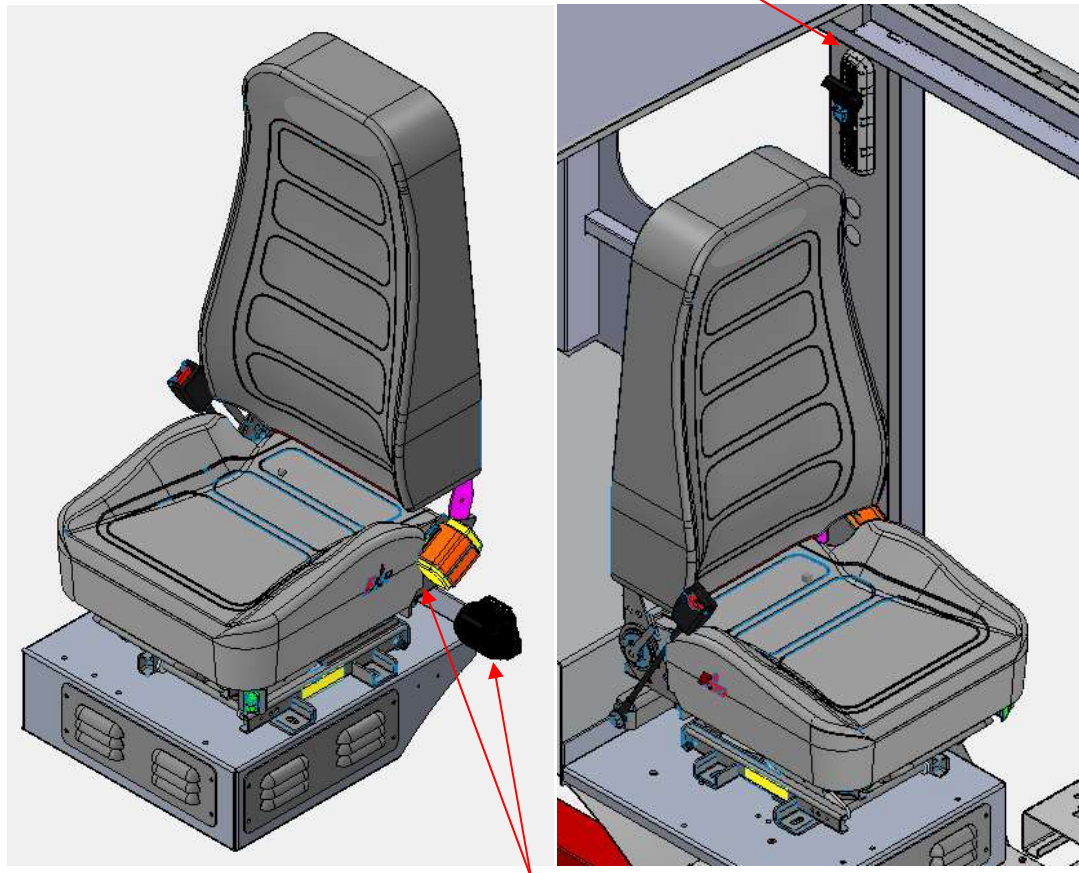

Dual retractor belt system



SUTPHEN CORPORATION

Officer's Cab Seating (Option Group: 390)

Officer's Seat Options:

OPTION	OPTION DESCRIPTION
39010075	OFFICER'S SEAT, BOSTROM, NAVIGATOR AIR-50RX/D AIR RIDE (DURAWEAR PLUS, LOW SEAM)
39010120	OFFICER'S SEAT, BOSTROM TANKER 450, ABTS SCBA (DURAWEAR)
39010125	OFFICER'S SEAT, BOSTROM TANKER 450, AIR RIDE ABTS SCBA (DURAWEAR)
39010130	OFFICER'S SEAT, BOSTROM SIERRA, ABTS HIGH BACK (DURAWEAR)
39010150	OFFICER'S SEAT, BOSTROM SIERRA, ELECTRIC ABTS
39010210	OFFICER'S SEAT, BOSTROM TANKER 550, ABTS SCBA (DURAWEAR PLUS, LOW SEAM)
39010215	OFFICER'S SEAT, BOSTROM TANKER 550, AIR RIDE ABTS SCBA (DURAWEAR PLUS, LOW SEAM)
39010400	OFFICER'S SEAT, USSC VALOR, ABTS SCBA
39010510	OFFICER'S SEAT, SEATS INC 911 BATTALION, ABTS SCBA
39010515	OFFICER'S SEAT, SEATS INC 911 BATTALION, AIR RIDE ABTS SCBA

Officer's Seatbox Options:

OPTION	OPTION DESCRIPTION
39030010	OFFICER'S SEAT COMPT, OPEN FRONT
39030020	OFFICER'S SEAT COMPT, FRONT DOOR
39030030	OFFICER'S SEAT COMPT, FRONT DOOR W/LOCKING LATCH



Seatbox
w/open
front:



Seatbox
w/door:



SUTPHEN CORPORATION

Crew Cab Seating, Rear Facing (Option Group: 395)

Rear Facing Crew Seat Options:

OPTION	OPTION DESCRIPTION
39521105	CREW SEAT 1, BOSTROM TANKER 350, ABTS SCBA (DURAWEAR)
39521106	CREW SEAT 2, BOSTROM TANKER 350, ABTS SCBA (DURAWEAR)
39521125	CREW SEAT 1, BOSTROM TANKER 450, ABTS SCBA (DURAWEAR)
39521126	CREW SEAT 2, BOSTROM TANKER 450, ABTS SCBA (DURAWEAR)
39521205	CREW SEAT 1, BOSTROM SIERRA, ABTS HIGH BACK (DURAWEAR)
39521206	CREW SEAT 2, BOSTROM SIERRA, ABTS HIGH BACK (DURAWEAR)
39521307	CREW SEAT 1, BOSTROM TANKER 550, ABTS SCBA (DURAWEAR PLUS, LOW SEAM)
39521308	CREW SEAT 2, BOSTROM TANKER 550, ABTS SCBA (DURAWEAR PLUS, LOW SEAM)
39521310	CREW SEAT 1, USSC VALOR, ABTS SCBA
39521311	CREW SEAT 2, USSC VALOR, ABTS SCBA
39521320	CREW SEAT 1, SEATS INC 911 BATTALION, ABTS SCBA
39521321	CREW SEAT 2, SEATS INC 911 BATTALION, ABTS SCBA

Bostrom 350/450 Series Crew Seat:

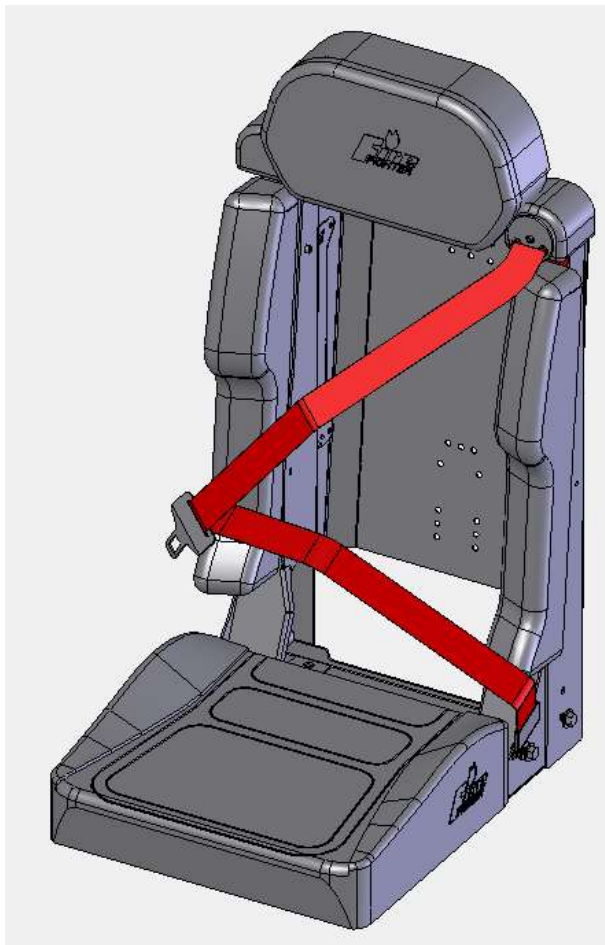



SUTPHEN CORPORATION

Crew Cab Seating, Forward Facing (Option Group: 395)

Forward Facing Crew Seat Options:

OPTION	OPTION DESCRIPTION	APPLICABLE CAB
39521405	CREW SEAT 3, BOSTROM TANKER 300CT, ABTS SCBA FLIP UP (DURAWEAR)	ALL CABS
39521406	CREW SEAT 4, BOSTROM TANKER 300CT, ABTS SCBA FLIP UP (DURAWEAR)	ALL CABS
39521407	CREW SEAT 5, BOSTROM TANKER 300CT, ABTS SCBA FLIP UP (DURAWEAR)	73" CABS, OR 62" CAB W/3-MAN CREW SEAT BOX
39521408	CREW SEAT 6, BOSTROM TANKER 300CT, ABTS SCBA FLIP UP (DURAWEAR)	73" CABS ONLY
39521425	CREW SEAT 3, BOSTROM TANKER 400CT, ABTS SCBA FLIP UP (DURAWEAR)	ALL CABS
39521426	CREW SEAT 4, BOSTROM TANKER 400CT, ABTS SCBA FLIP UP (DURAWEAR)	ALL CABS
39521427	CREW SEAT 5, BOSTROM TANKER 400CT, ABTS SCBA FLIP UP (DURAWEAR)	73" CABS, OR 62" CAB W/3-MAN CREW SEAT BOX
39521428	CREW SEAT 6, BOSTROM TANKER 400CT, ABTS SCBA FLIP UP (DURAWEAR)	73" CABS ONLY
39521450	CREW SEAT 3, BOSTROM TANKER 350, ABTS SCBA FIXED (DURAWEAR)	ALL CABS
39521451	CREW SEAT 4, BOSTROM TANKER 350, ABTS SCBA FIXED (DURAWEAR)	ALL CABS
39521452	CREW SEAT 5, BOSTROM TANKER 350, ABTS SCBA FIXED (DURAWEAR)	73" CABS, OR 62" CAB W/3-MAN CREW SEAT BOX
39521453	CREW SEAT 6, BOSTROM TANKER 350, ABTS SCBA FIXED (DURAWEAR)	73" CABS ONLY
39521455	CREW SEAT 3, BOSTROM TANKER 450, ABTS SCBA FIXED (DURAWEAR)	ALL CABS
39521456	CREW SEAT 4, BOSTROM TANKER 450, ABTS SCBA FIXED (DURAWEAR)	ALL CABS
39521457	CREW SEAT 5, BOSTROM TANKER 450, ABTS SCBA FIXED (DURAWEAR)	73" CABS, OR 62" CAB W/3-MAN CREW SEAT BOX
39521458	CREW SEAT 6, BOSTROM TANKER 450, ABTS SCBA FIXED (DURAWEAR)	73" CABS ONLY
39521470	CREW SEAT 3, BOSTROM SIERRA, ABTS HIGH BACK (DURAWEAR)	ALL CABS
39521471	CREW SEAT 4, BOSTROM SIERRA, ABTS HIGH BACK (DURAWEAR)	ALL CABS
39521472	CREW SEAT 5, BOSTROM SIERRA, ABTS HIGH BACK (DURAWEAR)	73" CABS, OR 62" CAB W/3-MAN CREW SEAT BOX
39521473	CREW SEAT 6, BOSTROM SIERRA, ABTS HIGH BACK (DURAWEAR)	73" CABS ONLY
39521505	CREW SEAT 3, BOSTROM SIERRA, ABTS HIGH BACK FLIP UP (DURAWEAR)	ALL CABS
39521506	CREW SEAT 4, BOSTROM SIERRA, ABTS HIGH BACK FLIP UP (DURAWEAR)	ALL CABS
39521507	CREW SEAT 5, BOSTROM SIERRA, ABTS HIGH BACK FLIP UP (DURAWEAR)	73" CABS, OR 62" CAB W/3-MAN CREW SEAT BOX
39521508	CREW SEAT 6, BOSTROM SIERRA, ABTS HIGH BACK FLIP UP (DURAWEAR)	73" CABS ONLY
39521623	CREW SEAT 3, BOSTROM TANKER 550, ABTS, SCBA (DURAWEAR PLUS, LOW SEAM)	ALL CABS
39521624	CREW SEAT 4, BOSTROM TANKER 550, ABTS, SCBA (DURAWEAR PLUS, LOW SEAM)	ALL CABS
39521625	CREW SEAT 5, BOSTROM TANKER 550, ABTS, SCBA (DURAWEAR PLUS, LOW SEAM)	73" CABS, OR 62" CAB W/3-MAN CREW SEAT BOX
39521626	CREW SEAT 6, BOSTROM TANKER 550, ABTS, SCBA (DURAWEAR PLUS, LOW SEAM)	73" CABS ONLY
39521633	CREW SEAT 3, BOSTROM TANKER 500, ABTS SCBA FLIP-UP (DURAWEAR PLUS, LOW SEAM)	ALL CABS
39521634	CREW SEAT 4, BOSTROM TANKER 500, ABTS SCBA FLIP-UP (DURAWEAR PLUS, LOW SEAM)	ALL CABS
39521635	CREW SEAT 5, BOSTROM TANKER 500, ABTS SCBA FLIP-UP (DURAWEAR PLUS, LOW SEAM)	73" CABS, OR 62" CAB W/3-MAN CREW SEAT BOX
39521636	CREW SEAT 6, BOSTROM TANKER 500, ABTS SCBA FLIP-UP (DURAWEAR PLUS, LOW SEAM)	73" CABS ONLY
39521700	CREW SEAT 3, USSC VALOR, ABTS, SCBA	ALL CABS
39521701	CREW SEAT 4, USSC VALOR, ABTS, SCBA	ALL CABS
39521702	CREW SEAT 5, USSC VALOR, ABTS, SCBA	73" CABS, OR 62" CAB W/3-MAN CREW SEAT BOX
39521703	CREW SEAT 6, USSC VALOR, ABTS, SCBA	73" CABS ONLY
39521710	CREW SEAT 3, USSC VALOR, ABTS SCBA FLIP-UP BASE	ALL CABS
39521711	CREW SEAT 4, USSC VALOR, ABTS SCBA FLIP-UP BASE	ALL CABS
39521712	CREW SEAT 5, USSC VALOR, ABTS SCBA FLIP-UP BASE	73" CABS, OR 62" CAB W/3-MAN CREW SEAT BOX
39521713	CREW SEAT 6, USSC VALOR, ABTS SCBA FLIP-UP BASE	73" CABS ONLY
39521800	CREW SEAT 3, SEATS INC 911 BATTALION, ABTS SCBA	ALL CABS
39521801	CREW SEAT 4, SEATS INC 911 BATTALION, ABTS SCBA	ALL CABS
39521802	CREW SEAT 5, SEATS INC 911 BATTALION, ABTS SCBA	73" CABS, OR 62" CAB W/3-MAN CREW SEAT BOX
39521803	CREW SEAT 6, SEATS INC 911 BATTALION, ABTS SCBA	73" CABS ONLY
39521810	CREW SEAT 3, SEATS INC 911 BATTALION, ABTS SCBA FLIP-UP	ALL CABS
39521811	CREW SEAT 4, SEATS INC 911 BATTALION, ABTS SCBA FLIP-UP	ALL CABS
39521812	CREW SEAT 5, SEATS INC 911 BATTALION, ABTS SCBA FLIP-UP	73" CABS, OR 62" CAB W/3-MAN CREW SEAT BOX
39521813	CREW SEAT 6, SEATS INC 911 BATTALION, ABTS SCBA FLIP-UP	73" CABS ONLY



SUTPHEN CORPORATION

Additional Crew Cab Seating, Forward Facing (Option Group: 395)

Additional Forward Facing Crew Seat Options:

<u>OPTION</u>	<u>OPTION DESCRIPTION</u>
39530400	CREW SEAT 5, FLIP UP JUMP SEAT (DURAWEAR)
39530401	CREW SEAT 6, FLIP UP JUMP SEAT (DURAWEAR)

Flip-up jump seat:



Sutphen Chassis

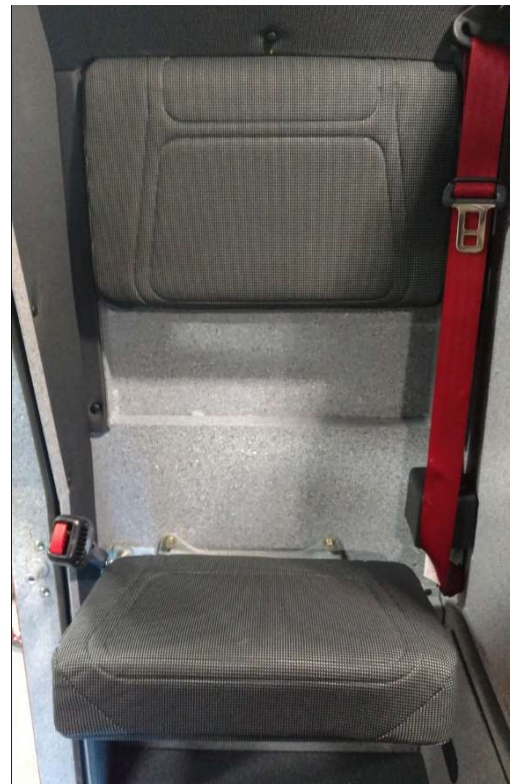



SUTPHEN CORPORATION

Cab Seating, SCBA Options (Option Group: 396)

Available SCBA Options, per seat:

<u>OPTION</u>	<u>OPTION DESCRIPTION</u>	<u>APPLICABLE SEATS</u>
39610000	SCBA BRACKETS, BOSTROM, SECURE ALL	BOSTROM
39610100	SCBA BRACKETS, ZIAMATIC, WALKAWAY	USSC VALOR
39610105	SCBA BRACKETS, ZIAMATIC, LOAD & LOCK	BOSTROM, SEAT INC 911
39610110	SCBA BRACKETS, ZIAMATIC, QUICK HOLD	BOSTROM, USSC VALOR
39610112	SCBA BRACKETS, ZIAMATIC, EZ-LOC	USSC VALOR, SEAT INC 911
39610115	SCBA BRACKETS, IMMI SMART DOCK	BOSTROM, USSC VALOR, SEAT INC 911



SUTPHEN CORPORATION

Steering System (Option Group: 400)

OPTION	OPTION DESCRIPTION
40010250	STEERING - ROSS TAS-85

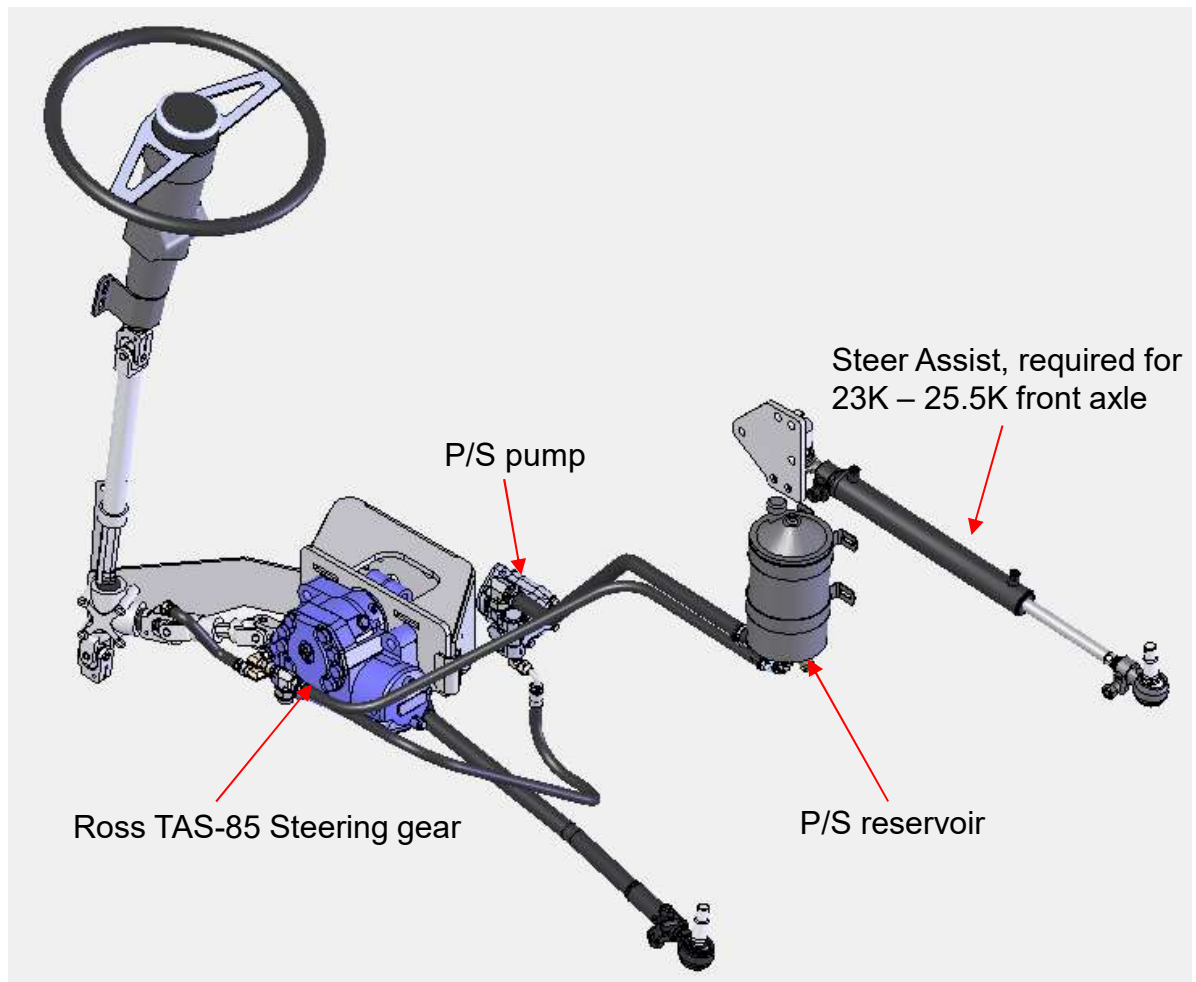



SUTPHEN CORPORATION

Front Suspensions (Option Group: 410)

Available front suspension options:

FRONT SUSPENSION OPTION	FRONT SUSPENSION DESCRIPTION	RIDE HEIGHT (LOADED)
41010015	SUSPENSION FRONT 18,000 LBS. 54" LEAF	12 ½"
41010105	SUSPENSION FRONT 19,000 LBS. 54" LEAF	12 ½"
41010115	SUSPENSION FRONT 20,000 LBS. 54" LEAF	13"
41010217	SUSPENSION FRONT 23,000 LBS. 54" LEAF	13 ½"
41021550	SUSPENSION FRONT 25,500 LBS. 54" LEAF	13 1/8"

18/19K (3 leaf):

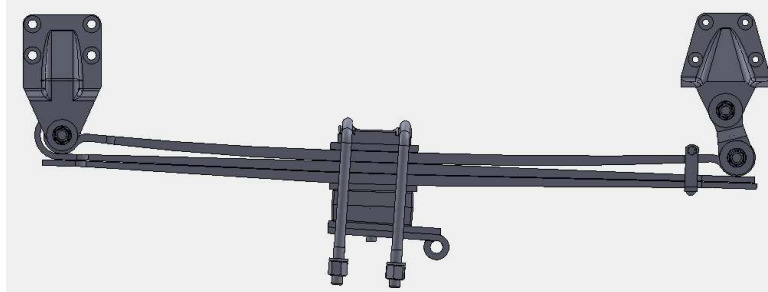

20K (3 leaf):

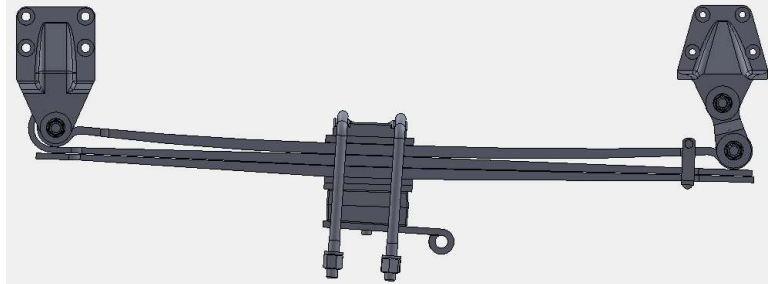

23K (4 leaf):

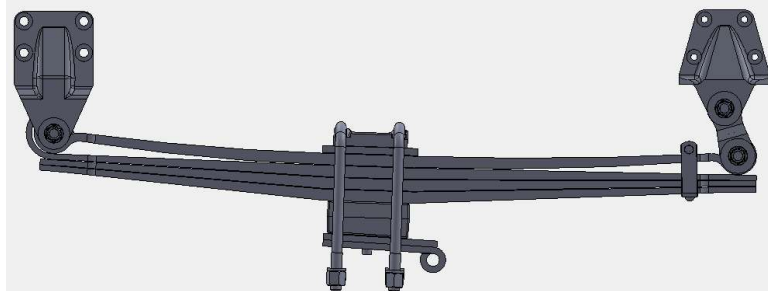

25.5K (4 leaf):

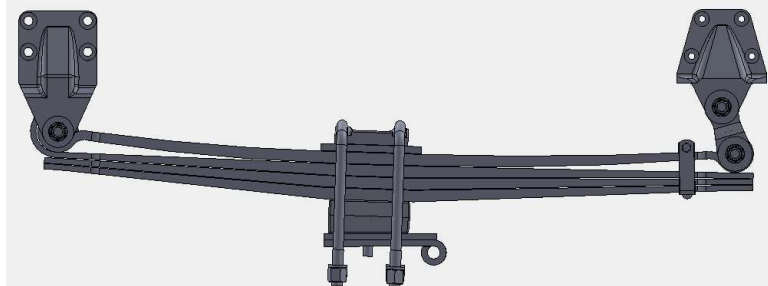



SUTPHEN CORPORATION

Rear Suspensions (Option Group: 420)

Available rear suspension options:

REAR SUSPENSION OPTION	REAR SUSPENSION DESCRIPTION	RIDE HEIGHT (LOADED)
42010000	SUSPENSION REAR REYCO 24,000 LBS. LEAF	9.3"
42010001	SUSPENSION REAR REYCO 27,000 LBS. LEAF	9.5"
42010010	SUSPENSION REAR FIREMAAX 24,000 LBS. AIR RIDE	10 ½"
42010015	SUSPENSION REAR FIREMAAX 27,000 LBS. AIR RIDE	10 ½"
42010025	SUSPENSION REAR FIREMAAX 31,000 LBS. AIR RIDE	10 ½"
42010500	SUSPENSION REAR REYCO 31,000 LBS. LEAF	10"
42010600	SUSPENSION REAR LINK ATLAS 35,000 LBS. AIR RIDE	10 ½"
42020020	SUSPENSION REAR RAYDAN 40,000 LBS. AIR RIDE	11 ¾"
42020023	SUSPENSION REAR RAYDAN 44,000 LBS. AIR RIDE	11 ¾"
42020024	SUSPENSION REAR RAYDAN 48,000 LBS. AIR RIDE	11 ¾"
42020025	SUSPENSION REAR RAYDAN 52,000 LBS. AIR RIDE	11 ¾"
42020030	SUSPENSION REAR RAYDAN 58,000 LBS. AIR RIDE	11"
42020200	SUSPENSION REAR HENDRICKSON 40,000 LBS. SPRING	TBD
42020210	SUSPENSION REAR HENDRICKSON 44,000 LBS. SPRING	TBD



Tire Pressure Monitors (Option Group: 429)

OPTION	OPTION DESCRIPTION
42910000	TIRE PRESSURE MONITOR, CROSSFIRE
42910100	TIRE PRESS MONITOR, DORAN 360HD
42910200	TIRE PRESSURE MONITOR, REAL WHEELS, LED
42910300	TIRE PRESSURE MONITOR, QUICK PRESSURE
42920000	TIRE PRESSURE MONITOR, CROSSFIRE
42920100	TIRE PRESS MONITOR, DORAN 360HD
42920200	TIRE PRESSURE MONITOR, REAL WHEELS, LED
42920300	TIRE PRESSURE MONITOR, QUICK PRESSURE



SUTPHEN CORPORATION

Front Tire Options (Option Group: 430)

OPTION	OPTION DESCRIPTION	AXLE	DIAMETER	LOADED RADIUS
43010300	FRONT TIRES GOODYEAR 315/80R22.5 LRL G291 HWY 22.5 X 9 WHEELS	18K	42.3"	19.7"
43010301	FRONT TIRES GOODYEAR 315/80R22.5 289 WHA 22.5 x 12.25 WHEELS	18K	43.1"	20"
43010305	FRONT TIRES GOODYEAR 385/65R22.5 LRJ G296 22.5 x 12.25 WHEELS	20K	42.5"	19.8"
43010308	FRONT TIRES MICHELIN 385/65R22.5 LRJ XZY3 22.5 x 12.25 WHEELS	20K	42.4"	19.6"
43010320	FRONT TIRES GOODYEAR 425/65R22.5 LRL G296 HGW 22.5 X 12.25 WHEELS	23K	44.4"	20.6"
43010350	FRONT TIRES MICHELIN 315/80R22.5 LRL XZA2 22.5 X 9 WHEELS	18K	42.3"	19.5"
43010370	FRONT TIRES MICHELIN 425/65R22.5 LRL XFE 22.5 X 12.25 WHEELS	23K	44.5"	20.6"
43010700	FRONT TIRES, GOODYEAR 445/65R22.5 G296A SS, 22.5X13 WHEELS	25.5K	45.5"	20.9"
43010750	FRONT TIRES, MICHELIN 445/65R22.5 XFE WIDE BASE, 22.5X13 WHEELS	25.5K	45.6"	21"
43010755	FRONT TIRES, MICHELIN 445/65R22.5 XZY3 WIDE BASE, 22.5X13 WHEELS	25.5K	45.8"	21.1"



SUTPHEN CORPORATION

Rear Tire Options (Option Group: 440)

TIRE OPTION	TIRE DESCRIPTION	DIAMETER	LOADED RADIUS
44010305	TIRES, REAR, GOODYEAR 12R22.5 X 8.25 LRH G661 HIGHWAY 24,000 - 27,000 GVWR	42.9"	20.1"
44010310	TIRES, REAR, GOODYEAR 315/80R22.5X 9, LRL G291 HGWY, 31,000 GVWR	42.3"	19.7"
44010320	TIRES, REAR, GOODYEAR 12R22.5 LRH G622 MUD & SNOW 24,000 - 27,000 GVWR	43.3"	20.3"
44010330	TIRES, REAR, GOODYEAR 315/80R22.5 LRJ RHD2 MUD & SNOW, 31,000 GVWR	42.9"	19.8"
44010350	TIRES, REAR, MICHELIN 12R22.5 LRH XZE HIGHWAY 24,000 - 27,000 GVWR	42.6"	19.8"
44010360	TIRES, REAR, MICHELIN 315/80R22.5 X 9 LRL XZA-2 HIGHWAY 31,000 GVWR	42.3"	19.5"
44010370	TIRES, REAR, MICHELIN 12R22.5 LRH XDS MUD & SNOW 24000 - 27,000 GVWR	42.8"	19.9"
44010380	TIRES, REAR, MICHELIN 315/80R22.5 LRL XDY MUD & SNOW 31,000 GVWR	43"	20"
44010400	TIRES, REAR, GOODYEAR 315/80R22.5X 9, LRL G289 WHA HGWY, 35,000 GVWR	43.1"	20"
44020200	TIRES, REAR, GOODYEAR 11R22.5 LRH G661 HIGHWAY UP TO 48,000 GVWR (OBSOLETE)	41.8"	19.5"
44028888	TIRES, REAR, GOODYEAR 11R22.5 ENDURANCE RSA (REPLACEMENT FOR G661)		
44020210	TIRES, REAR, GOODYEAR 11R22.5 LRH G622 MUD & SNOW UP TO 48,000 GVWR	42"	19.7"
44020250	TIRES, REAR MICHELIN 11R22.5 LRH XZE2 HIGHWAY UP TO 48,000 GVWR	41.3"	19.3"
44020260	TIRES, REAR MICHELIN 11R22.5 LRH XDS MUD & SNOW UP TO 48,000 GVWR	41.9"	19.6"
44020270	TIRES, REAR, MICHELIN 12R22.5 LRH XZE HIGHWAY 52,000 GVWR	42.6"	19.8"
44020275	TIRES, REAR, MICHELIN 12R22.5 LRH XDS MUD & SNOW 52,000 GVWR	42.8"	19.9"
44020280	TIRES, REAR, GOODYEAR 12R22.5 LRH G661 HIGHWAY 52,000 GVWR	42.9"	20.1"
44020285	TIRES, REAR, GOODYEAR 12R22.5 LRH G622 MUD & SNOW 52,000 GVWR	43.3"	20.3"
44020290	TIRES, REAR, GOODYEAR 315/80R22.5 G670 HGWY 58,000 GVWR	42.3"	19.7"



SUTPHEN CORPORATION

Wheel Options (Option Group: 442)

<u>WHEELS OPTION</u>	<u>WHEELS DESCRIPTION</u>
44080050	WHEELS, STEEL
44080051	WHEELS, ALUMINUM
44080100	WHEELS, STEEL
44080105	WHEELS, STEEL (TANDEM)
44080110	WHEELS, ALUMINUM
44080115	WHEELS, ALUMINUM (TANDEM)
44210000	WHEELS, STEEL (max 27K rear)
44210100	WHEELS, ALUM, ACCURIDE (max 27K rear)
44210110	WHEELS, ALUM, ACCURIDE, ACCUSHIELD (max 27K rear)
44210200	WHEELS, ALUM, ALCOA (max 27K rear)
44210210	WHEELS, ALUM, ALCOA, DURABRITE (max 27K rear)
44215000	WHEELS, STEEL (max 35K rear)
44215100	WHEELS, ALUM, ACCURIDE (max 35K rear)
44215110	WHEELS, ALUM, ACCURIDE, ACCUSHIELD (max 35K rear)
44215200	WHEELS, ALUM, ALCOA (max 35K rear)
44215210	WHEELS, ALUM, ALCOA, DURABRITE (max 35K rear)
44220000	WHEELS, STEEL (max 58K rear)
44220100	WHEELS, ALUM, ACCURIDE (max 58K rear)
44220110	WHEELS, ALUM, ACCURIDE, ACCUSHIELD (max 58K rear)
44220200	WHEELS, ALUM, ALCOA (max 58K rear)
44220210	WHEELS, ALUM, ALCOA, DURABRITE (max 58K rear)



SUTPHEN CORPORATION

Additional Wheel Options (Option Group: 442)

OPTION	OPTION DESCRIPTION
44230110	INNER WHEELS COATED, SINGLE AXLE
44230120	INNER WHEELS COATED, TANDEM AXLE
44230210	BALANCE STEEL WHEELS, SINGLE AXLE
44230220	BALANCE STEEL WHEELS, TANDEM AXLE
44270100	HUB COVERS, FRONT & REAR, POLISHED STS (Single Axle)
44270105	HUB COVERS, FRONT & REAR, POLISHED STS (Tandem Axle)
44270200	WHEEL COVERS, FULL DELUXE POLISHED STS (Single Axle)
44270205	WHEEL COVERS, FULL DELUXE POLISHED STS (Tandem Axle)
44270300	CHROME LUG NUT CAPS, FRONT & REAR (Single Axle)
44270305	CHROME LUG NUT CAPS, FRONT & REAR (Tandem Axle)
44270500	PAINTED SILVER STRIPE FOR STEEL WHEELS SINGLE AXLE
44270505	PAINTED SILVER STRIPE FOR STEEL WHEELS TANDEM AXLE



SUTPHEN CORPORATION

Tow Eye Options (Option Group: 450)

OPTION	OPTION DESCRIPTION	APPLICABLE BUMPERS
45010001	FRONT TOW EYES, BELOW BUMPER	6", 12", 18", 24", 30"
45010002	FRONT TOW EYES, THROUGH BUMPER FACE	6", 12", 18", 24", 30"
45010003	FRONT TOW EYES, TOP OF BUMPER	12", 18", 24", 30"
45010015	FRONT TOW EYE FINISH, PAINTED	6", 12", 18", 24", 30"
45010016	FRONT TOW EYE FINISH, POLISHED STAINLESS	6", 12", 18", 24", 30"

Tow eyes below bumper (standard):

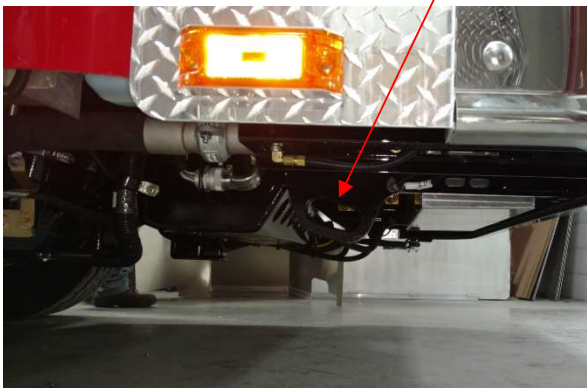

Tow eyes, through bumper face:



Tow eyes, top of bumper:





SUTPHEN CORPORATION

Transmission Options (Option Group: 470)

OPTION	OPTION DESCRIPTION	APPLICABLE ENGINE
47012430	TRANSMISSION, ALLISON GEN 5, EVS3000	L9
47012435	TRANSMISSION, ALLISON GEN 5, EVS3000R W/RETARDER	L9
47012440	TRANSMISSION, ALLISON GEN 5, EVS4000	X12, X15
47012445	TRANSMISSION, ALLISON GEN 5, EVS4000R W/RETARDER	X12, X15

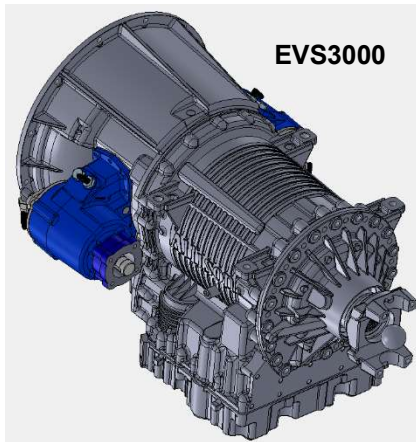

EVS3000

**EVS3000, 4 & 8
O'Clock PTO
positions
available:**

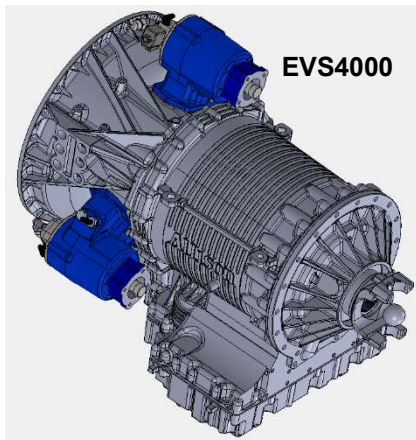
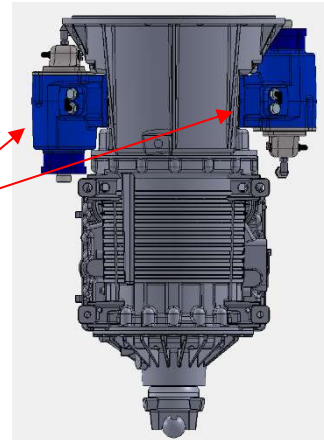

EVS4000

**EVS4000, 1 & 8
O'Clock PTO
positions
available:**

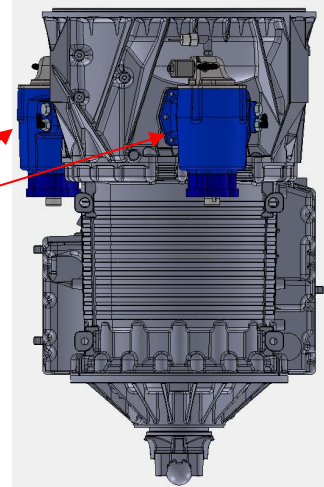

Additional transmission options:

OPTION	OPTION DESCRIPTION
47024050	TRANSMISSION COOLER
47025000	TRANSMISSION FLUID, CASTROL TRANSYND
47030000	ALLISON TOUCH PAD SHIFTER
47031000	HOT SHIFT PTO
47031050	SWITCH FOR HOT SHIFT PTO
47031100	PTO PAINTED TO MATCH THE FRAME



SUTPHEN CORPORATION

Cab Paint Options (Option Group: 900)

CAB PAINT BREAK OPTION	OPTION DESCRIPTION
90030005	TWO TONE CAB TO BOTTOM OF WINDSHIELD
90030006	TWO TONE CAB WITH SPECIAL PAINT BREAK LINE
90030010	TWO TONE CAB & BODY
90030012	TWO TONE CAB, BODY & PUMP MODULE

90030005 Cab paint break, option #1:



90030006 Special cab paint breaks, options #2 - #8:

Option #2, paint break to top of grille:



Option #3, paint break to top of grille w/grille swoop:



Option #4, paint break w/windshield swoop, to top of grille

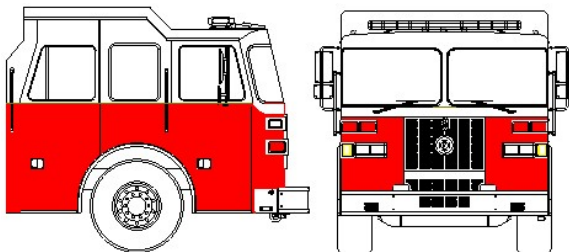

Option #5, paint break w/windshield swoop and grille swoop

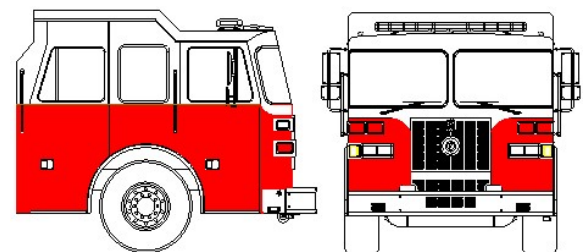



SUTPHEN CORPORATION

Cab Paint Options, Cont'd (Option Group: 900)

90030006 Special cab paint breaks, options #2 - #8:

Option #6, paint break w/grille swoop:



Option #7, paint break w/windshield swoop, to top of grille:

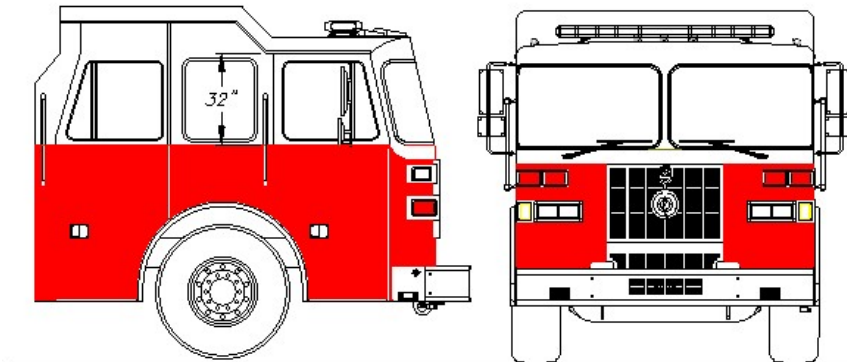

Option #8, custom paint break – specify dimension from cab drip rail:

