



Family Owned and Operated Since 1890

DUBLIN ENGINEERING

CURRENT STAFFING

- (3) design engineers for the pumper product line
- (2) design engineers for the aerial product line
 - (1) design engineer has split duties between pumpers and aerials
- (2) Electrical Engineers covering both product lines
- (1) Advanced Manufacturing Engineer
- (1) Professional Engineer (Mechanical Engineering)

PUMP MODULE ELECTRICAL CENTER (PMEC)

- Provide more flexibility for pumper body and pump module electrical systems.
- Completely sealed and waterproof U/L Tested enclosure.
- Flange mount connectors provide waterproof interfaces to electrical systems.
- Status LED's reflect state of on-board electrical systems.
- Self-documenting stickers label the electrical components.
- Transparent cover enables visual troubleshooting without any disassembly.

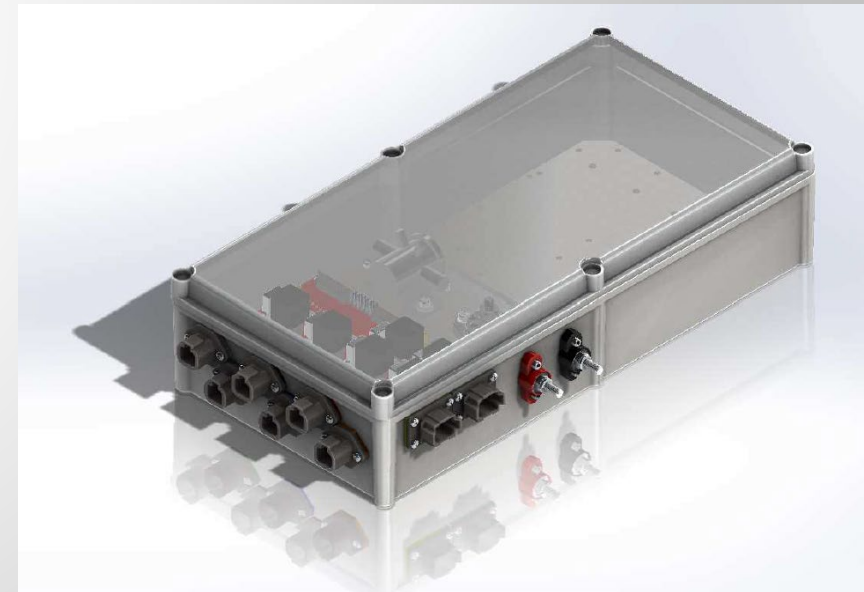

INTAKE RELIEF VALVE CHANGE

- Numerous issue with the Hale intake pressure relief valve.
- Switch was made to move away from the Hale intake relief valve to the Task Force Tips (TFT) relief valve.
- Adjusting the TFT relief valve is simpler because of the indicators on the adjustment knob.
- Other brands are available as well including the Elkhart Brass and the new version from Akron Brass (Model 53)



OIL-DRI DISPENSING SYSTEM

- New Oil-Dri dispensing setup that incorporates the Oil-Dri chute into the rear wall of the L3 or R3 compartment on pumpers (Oil-Dri hopper in the coffin compartment).
- Valve is accessible inside the compartment.
- Oil-Dri is dispensed thru the floor of the compartment (slide bucket under the body).
- Saves space in the compartment compared to the previous setup with a hose (which is still available).



OTHER NOTABLE RELEASES

- New S2 body design that incorporates up to (6) 8" diameter SCBA bottles in the officer side fender and (4) in the driver side.
- Changed the folding steps from the Austin brand of steps to the Innovative Controls step with integrated step lighting.
- Installations of 360 degree cameras on pumpers and aerials.

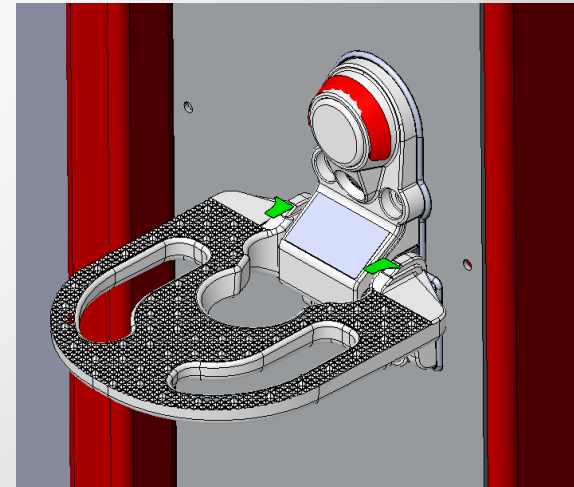
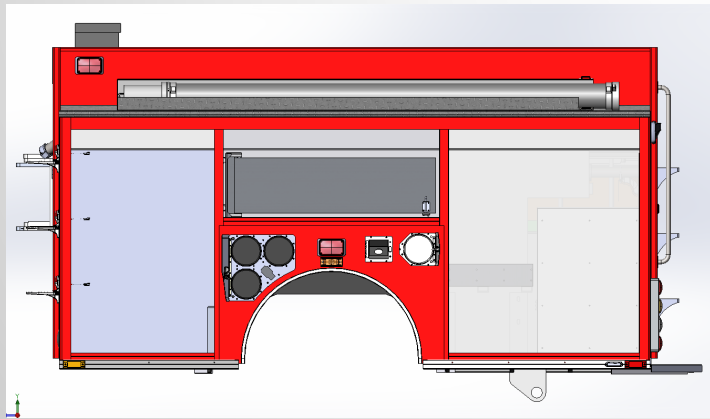

CLASS1 PUMP MODULE OVERHAUL

- Over the course of the past year we have worked with Class1 to revisit the available options for the Class1 Program pump module.
- Order form reorganized for easier and more accurate completion.
- Process implemented to assist with proper quoting and engineering review of adding options outside of the program setup.
- Next step is to implement these options on the Waterous program module.

WHAT WE ARE WORKING ON

- Pre-attached jack pads to outriggers on SPH100
- (2) new program modules with roll-up pump panel doors
- New rescue style pumper body to be introduced for the Program 2 product line.
- Revising the gas spring layout for hose bed doors to keep the doors from giving intermittent door open alarms.
- “Universal” hydraulic tank that can be used on both the SPH and SP product line. On the SP line, the hydraulic tank will be moved from the body to under the turntable (like the SPH). Should be available Spring 2019.
- Work in progress to develop a standard setup for multiplexed trucks. Hardware locations, standard harnesses, etc.

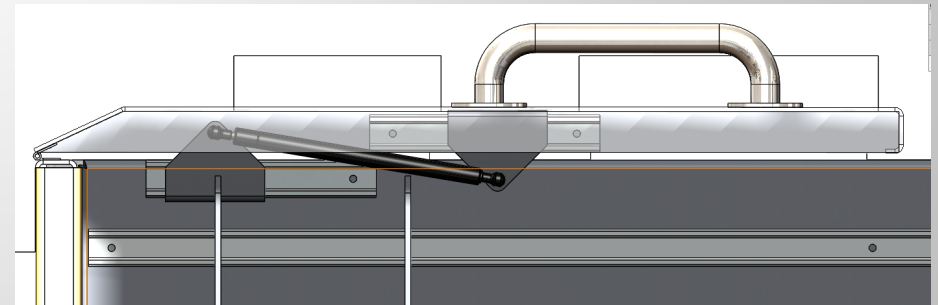
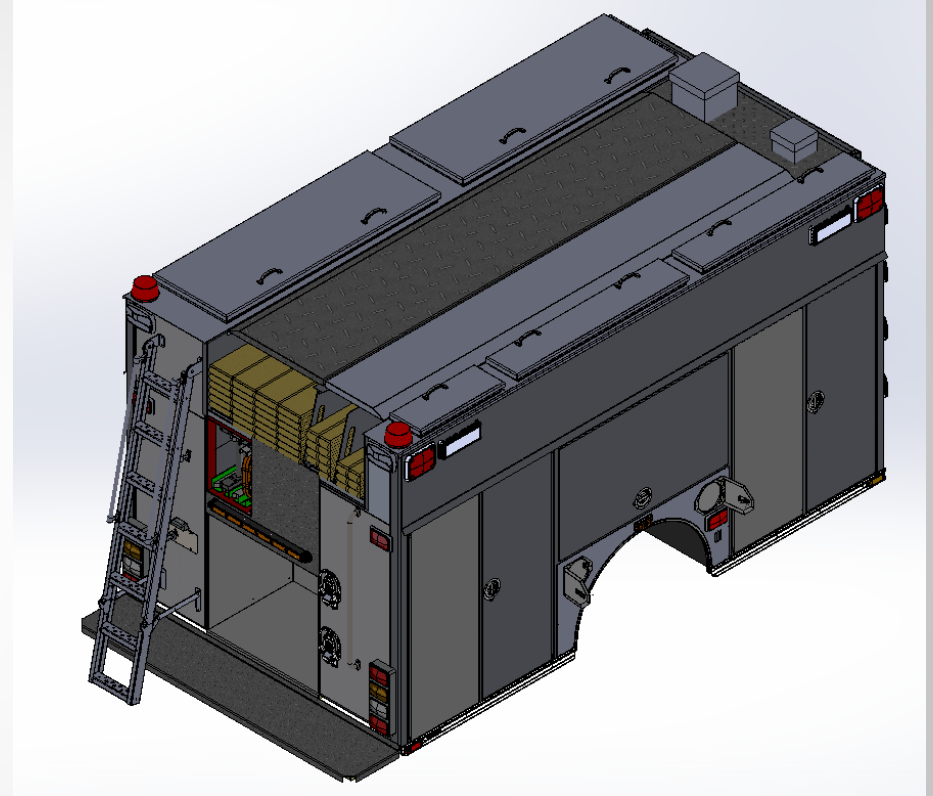

CLASS1 PUMP MODULE OVERHAUL

Numerous options updated and revised:

- Moved away from swing handles for the #1 and #2 discharges to open more panel space for other options.
- Setup the module to accommodate mechanical seals.
- Provide multiple pump ratings ranging from 1500 GPM to 2000 GPM.
- Option for the pressure transducer to be installed on the pump versus at the test port near the master gauge.
- Expanded the options for the #3 discharge position.
 - 2-1/2" Discharge
 - 3" Discharge
 - 3" Discharge with 4" hose adapter
 - 4" LDH discharge with electric actuator
- Expanded the options for the #4 discharge position:
 - 2-1/2" Discharge
 - 3" Discharge
 - 3" Discharge with 4" hose adapter
- Added an option for an electric actuator for the deck gun control.
- Added an option for a #5 officer side discharge position
- Added option for a 2-1/2" front discharge
- Option added for a 4" officer side tank to pump (air actuated)
- Pressure governor options added:
 - Class1 Sentry with twister controller
 - FRC Pump Boss
- ITL-40 Tank Gauge option available in place of the standard ITL-4
- Added option for on-board and off-board foam access systems including Akron Brass and Elkhart Brass
- Options available for the Elkhart Brass and Akron Brass inline foam educator systems.
- Option for black powder coated panels.

SM OPERATOR PANEL (FULL OPTION)

